

Bleeding Heart Yard

Greville Street

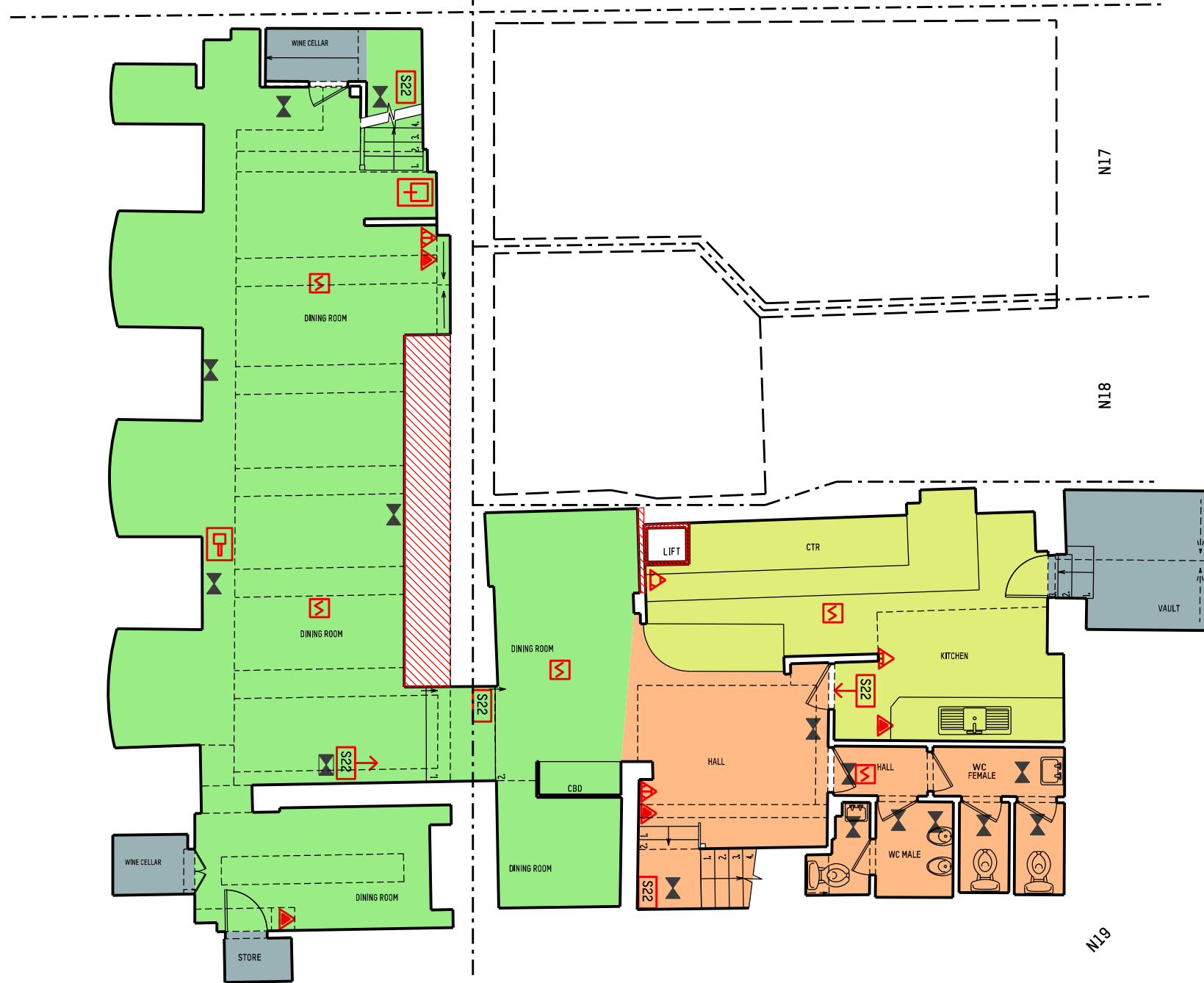

- RESTAURANT
Area: 90 m²
- KITCHEN
Area: 24,6 m²
- STORE
Area: 11,6 m²
- TOILETS
CIRCULATION
STAFF AREA
Area: 24,53 m²
- TOTAL**
Area: 150,73 m²

- Fire Alarm Break Glass
- Door Free From Fastenings
- Fire Alarm Sounder
- Control panel
- SF** Door with simple
- Water Fire Extinguisher
- Carbon Dioxide Fire Extinguisher
- Emergency Lighting
- Smoke Detector
- PR** Pressuration System
- Fire exit or Emergency exit symbol
- Directional arrow

WALLS TO DEMOLISH

Drawing Status
PRE APPLICATION
Issued only for purpose indicated

**Mackay
+ Partners**

ARCHITECTS & DESIGNERS
50 Farringdon Road
London EC1M 3JU Tel: +44 (0)207 608 1177
e mail: contact@mackayandpartners.co.uk

Job Title
BHY

Drawing Title
**EXISTING
BASEMENT FLOOR PLAN**

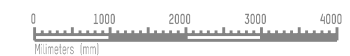
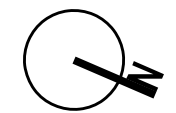

Scale @ A1: 1:50	Scale @ A3: 1:100	Drawn by: PM
Date: 28/10/2019	Checked by: KM	
Drawing No.: 611.19.EX_0600_150	Rev.: -	