

Alan Conisbee & Associates

Chartered Structural Engineers

4 Offord Street London N1 1DH Telephone 071-700 6666

Project

41 DOWNSHIRE HILL
LONDON NW3

Job No

90277

Sheet No

X02

Title

LATERAL RESTRAINT TO
EXISTING WALL

Date

Engineer

Checked

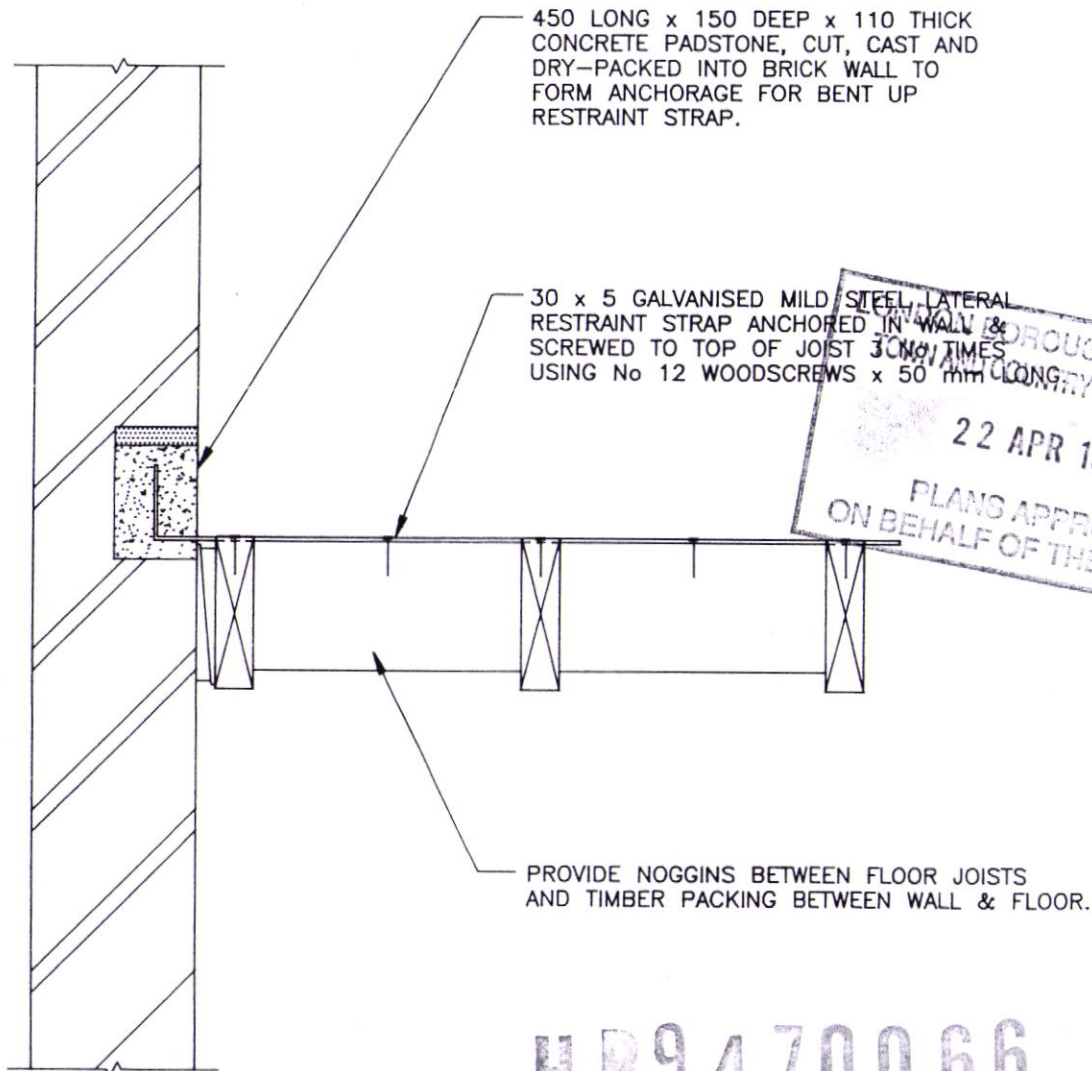

HB9470066

GENERAL NOTES

1. CONCRETE IS TO BE 1:1:2 CEMENT:SHARP SAND:10 mm PEA SHINGLE
& OVER WATERED TO PROVIDE A READILY POURED & COMPACTED MIX.
2. THE POCKET TO BE FILLED IS TO BE FREE OF ALL DUST & LOOSE
MORTAR & IS TO BE THOROUGHLY WETTED IMMEDIATELY BEFORE
CONCRETING.
3. THE PADSTONE IS TO BE CAREFULLY DRY-PACKED AFTER HARDENING.
WITH 25 mm - 50 mm 1:2 CEMENT:SAND. DO NOT OVER PACK.
4. FLOOR JOISTS MAY BE NOTCHED 5 mm TO RECEIVE RESTRAINT STRAPS.

LATERAL RESTRAINT TO EXISTING WALL