

Handrail 1:2

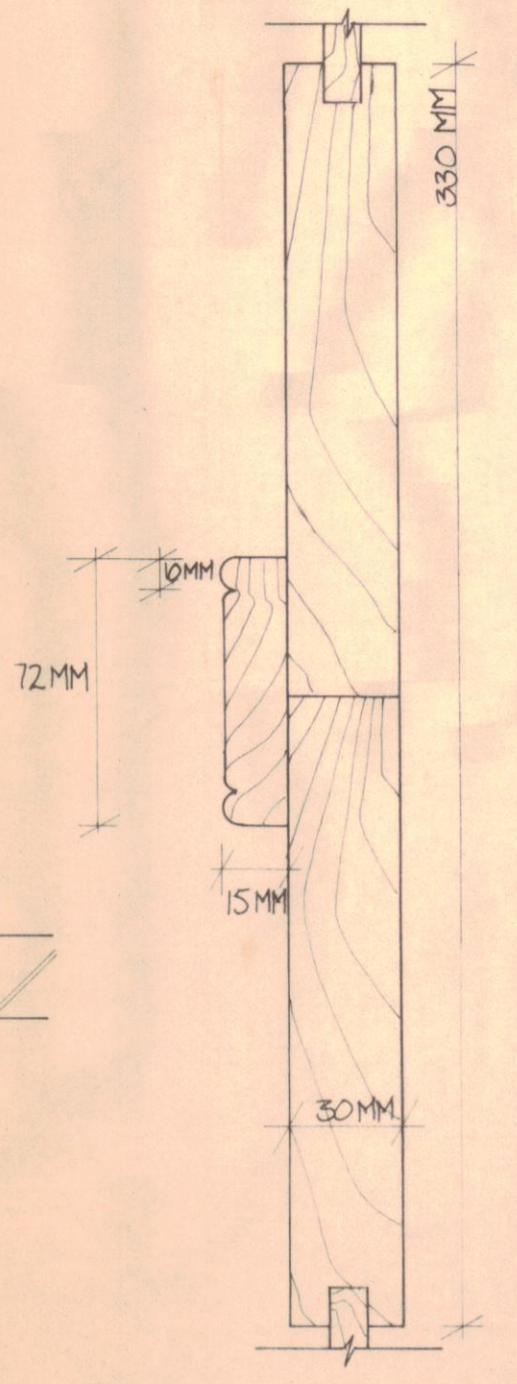

Door Architrave 1:2

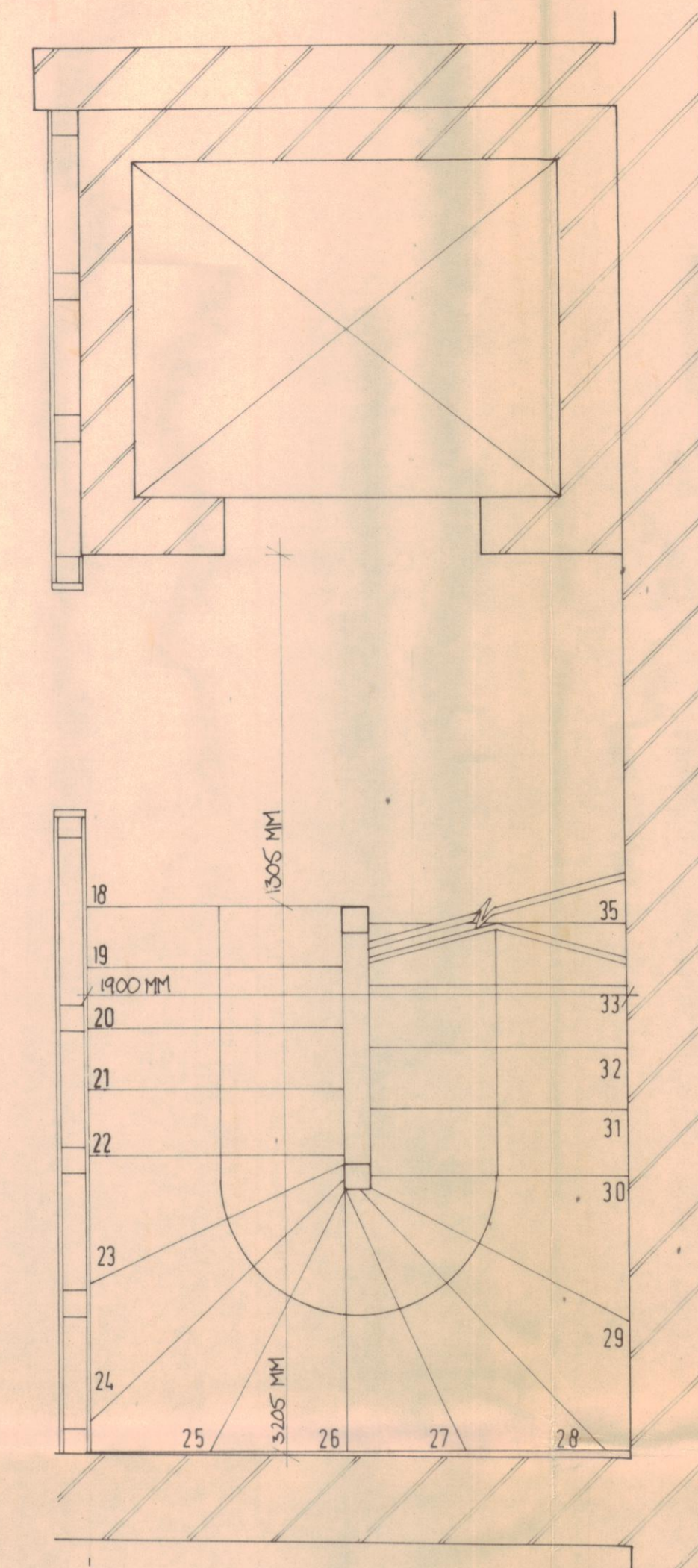
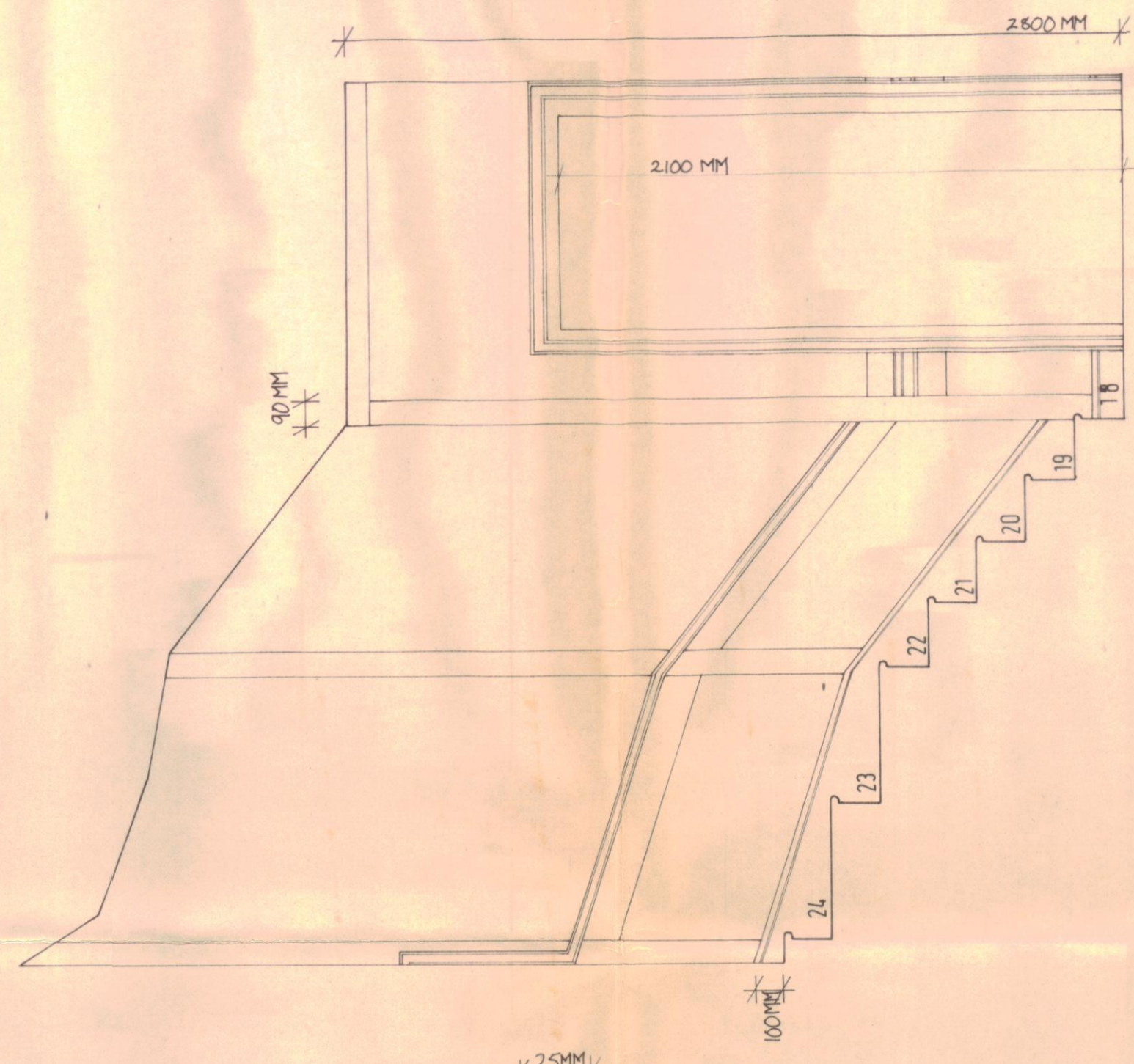
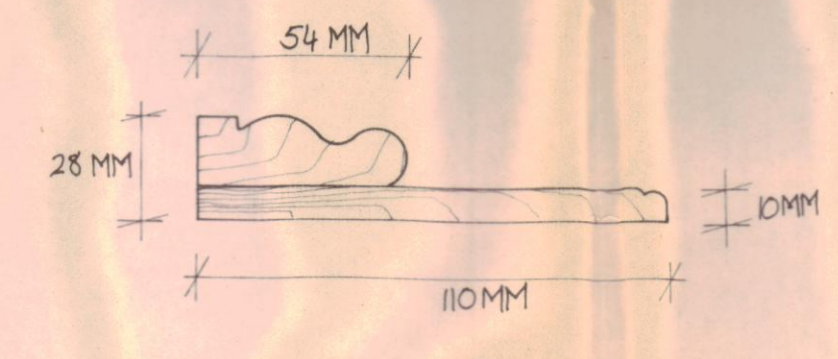

Staircase from first to second.
Plans & Elevations scale 1:20

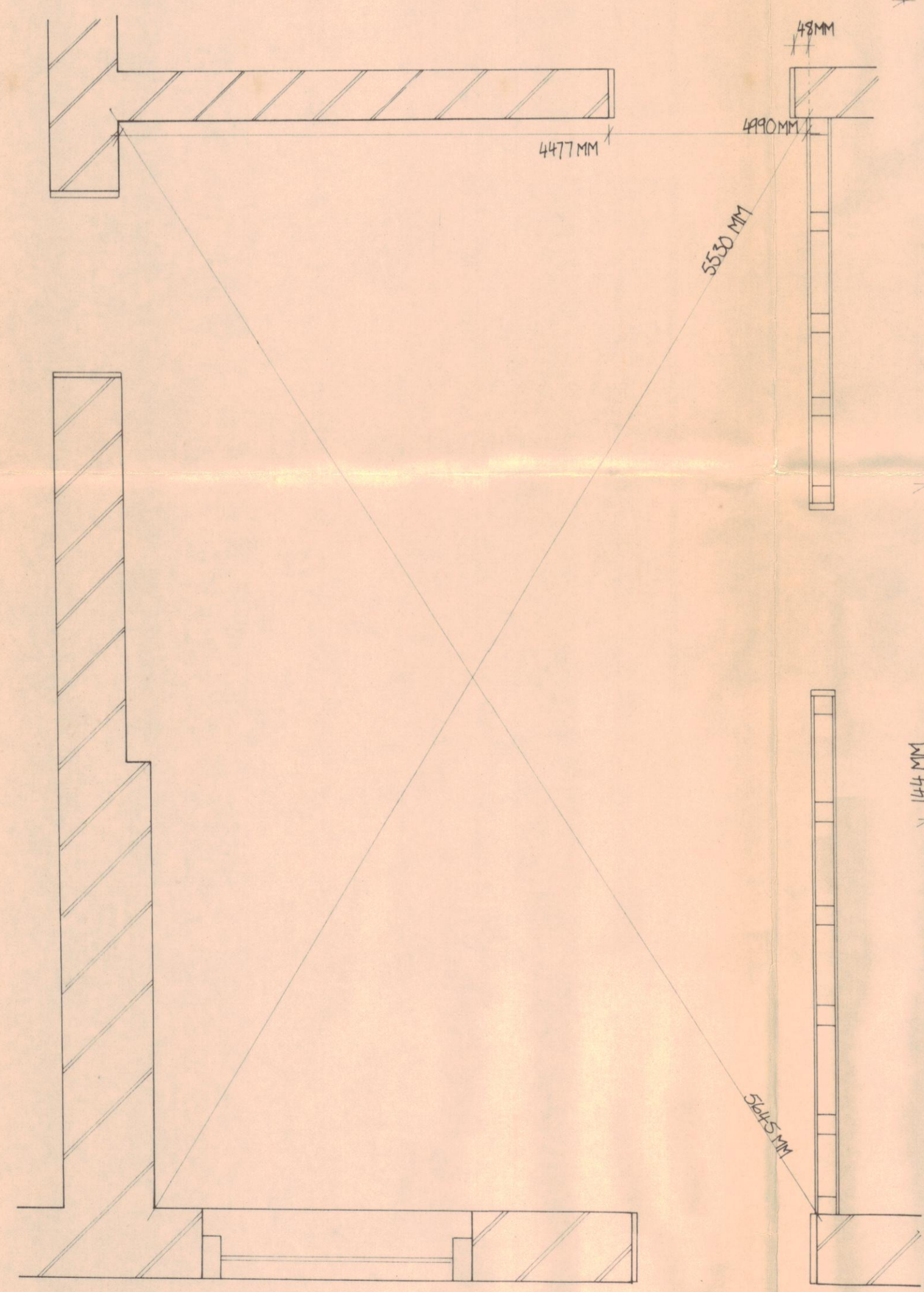
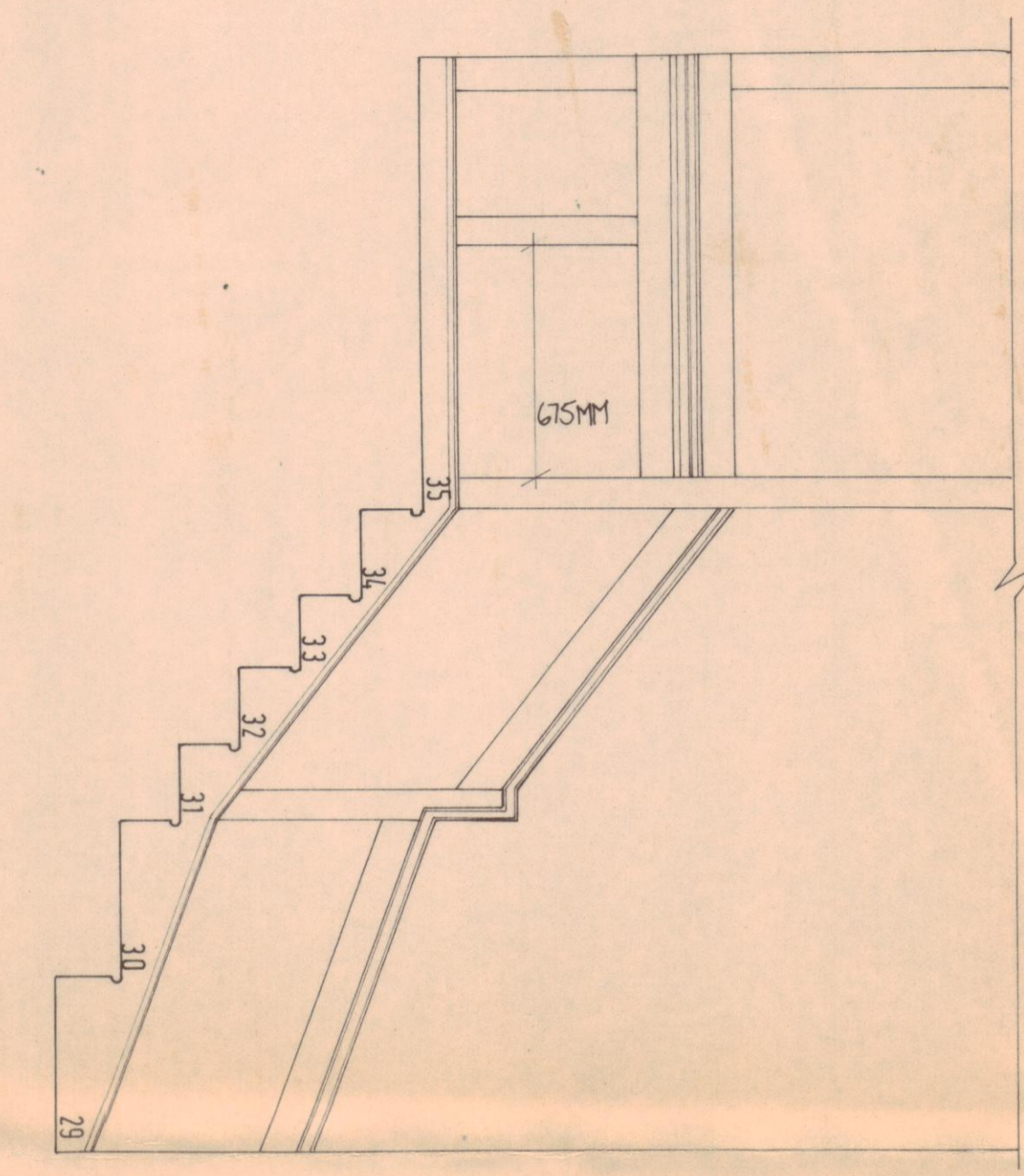

Skirting 1:2

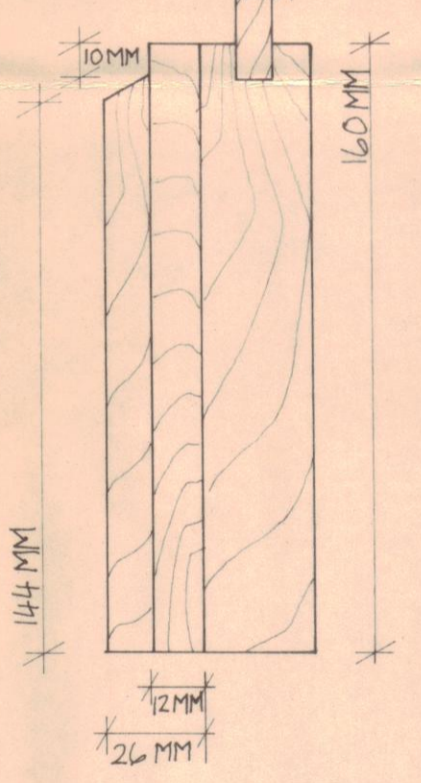

Staircase molding 1:2

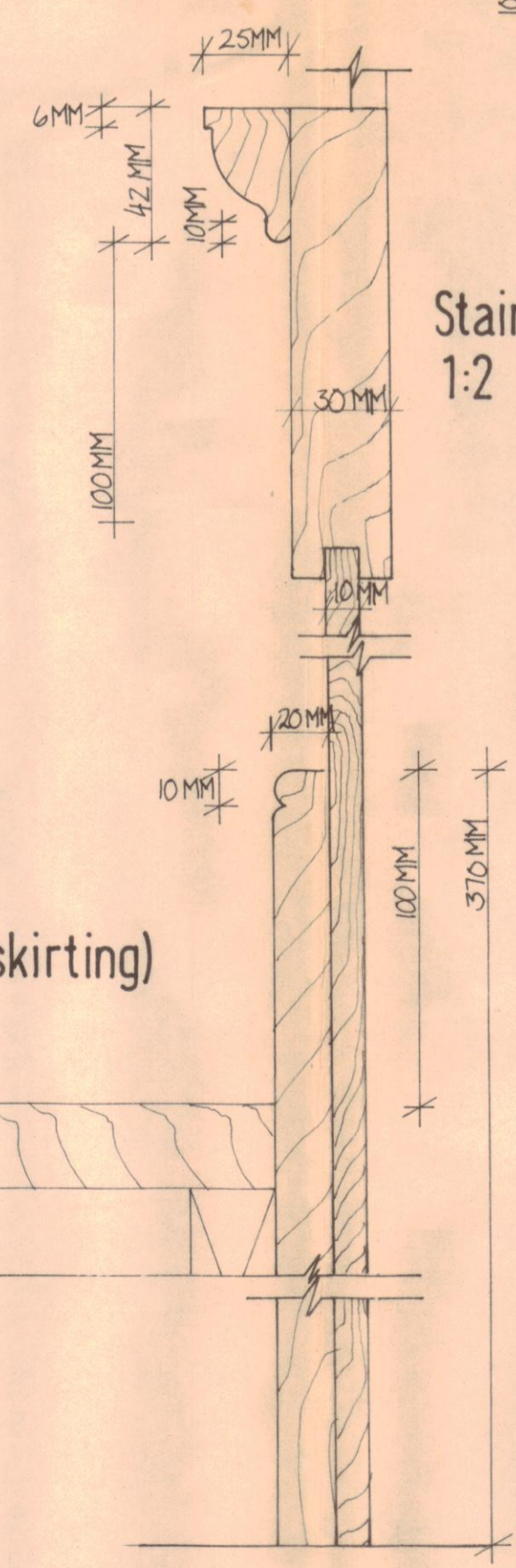

Stringer (& skirting) 1:2

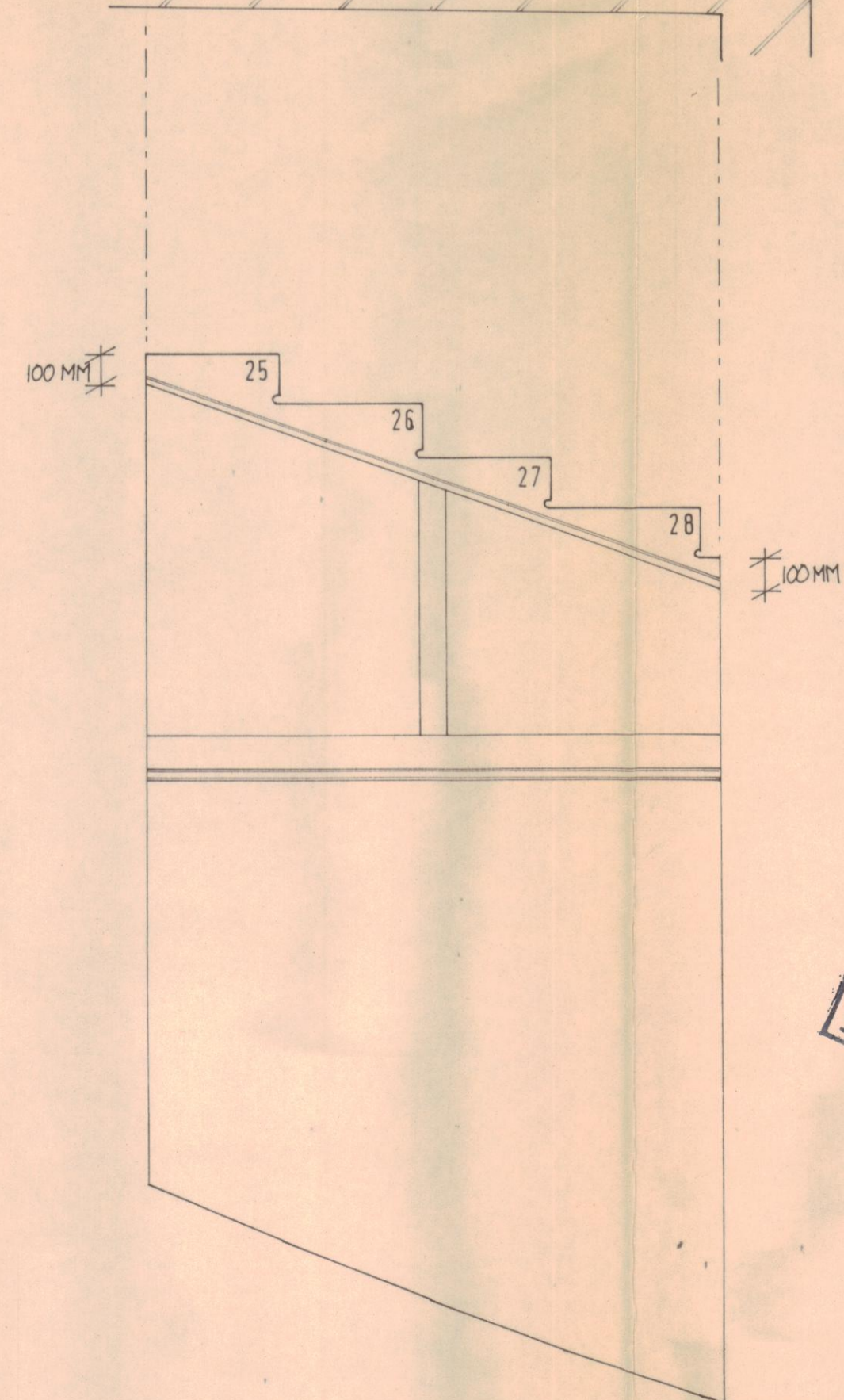

Handrail 1:2

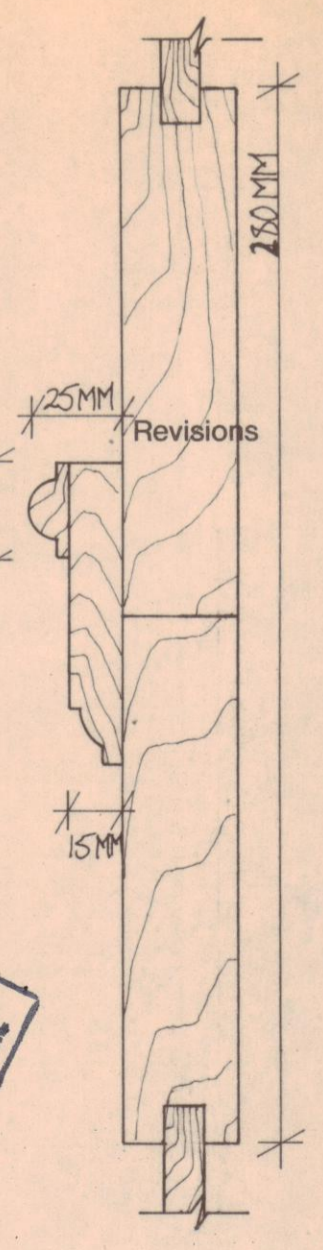

FIRST FLOOR REAR ROOM
PLAN & ELEVATION 1:20

LONDON BOROUGH OF CAMDEN
TOWN AND COUNTRY PLANNING DEPT
12 OCT 1983
PLANS APPROVED
ON BEHALF OF THE COUNCIL
NOT APPROVED

CTP/114/55/D/HB316.2

Project	35 37 NEAL STREET WC2	Title	PANELLING DETAILS.
Scale	1:2 & 1:20	Job No.	232
Drawn		Drawing No.	E-13
Checked		Revision	
Date Issued			
Douglas Paskin Associates			
7 Cliff Road Studios London NW19AN 01-485 1114			