

**CONDITION LBC 4 - Council Chamber access and nosings ref: 2019/6283/L**

The fabric removed from the dais within the Council Chamber shall be stored on site. Details of the storage shall be submitted to and approved in writing by the LPA prior to the fabric being removed.

 Store rooms designated for the storage of fabric removed from the dais within the Council Chamber

For the fabric removal itself, various hand tools will be used to remove panels without damaging the existing joinery, each section will be catalogued and labelled to where the item came from and a unique reference given to that item, once removed the joinery will be protected and labelled up ready for removal and storage.

The dais fabric will be kept in a heated dry store to maintain the correct moisture content. They will be stacked on bearers positioned to provide adequate support. The fabric will be raised out of contact with the ground and covered - allowing free air circulation.

Rev A - 05.02.21  
B.03 also highlighted as alternative option for storage

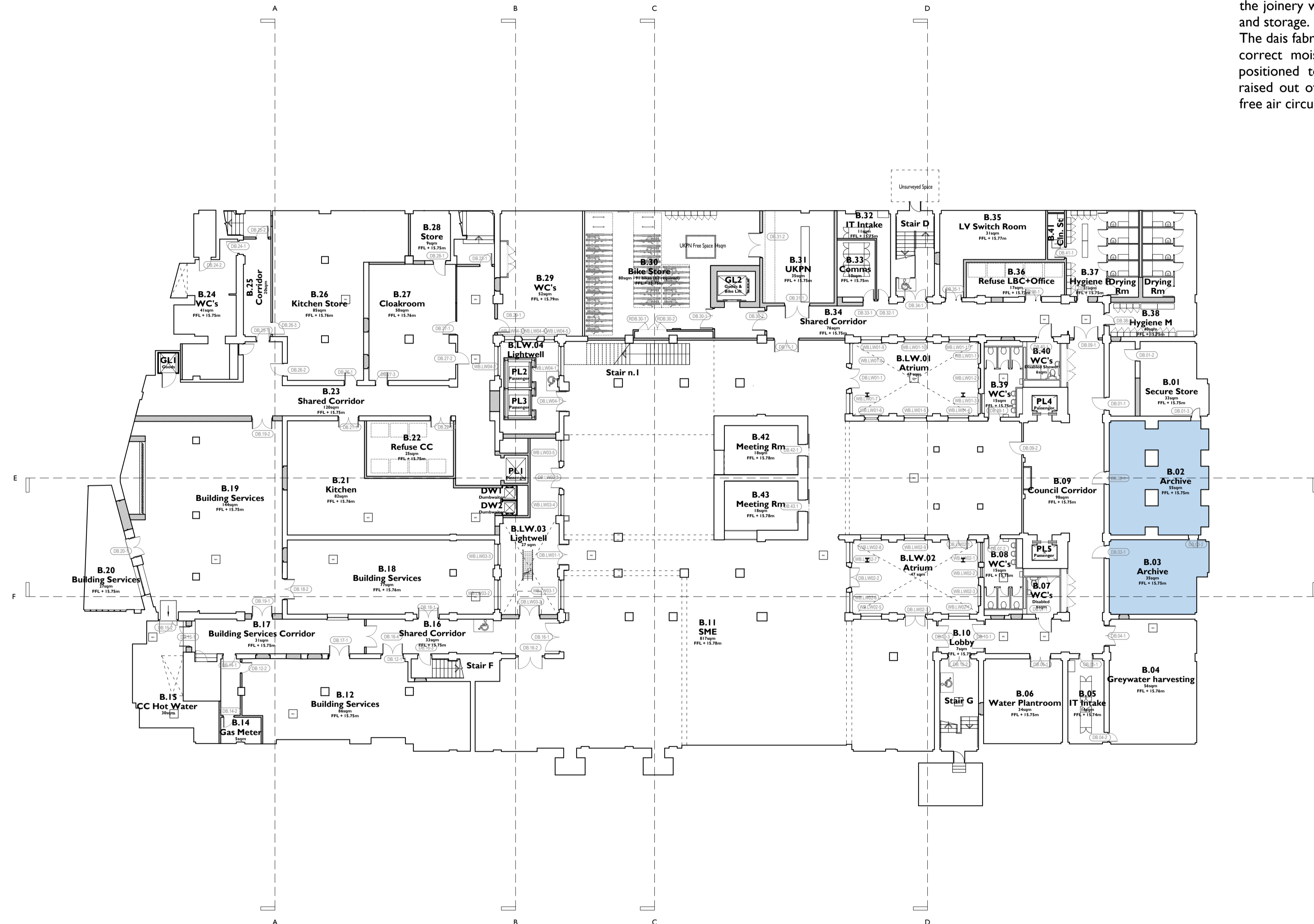

**Notes:**  
Drawings are based on survey data and may not accurately represent what is physically present.  
All dimensions are to be verified on site before proceeding with the work.  
All dimensions are in millimeters unless noted otherwise.  
Purcell shall be notified in writing of any discrepancies.

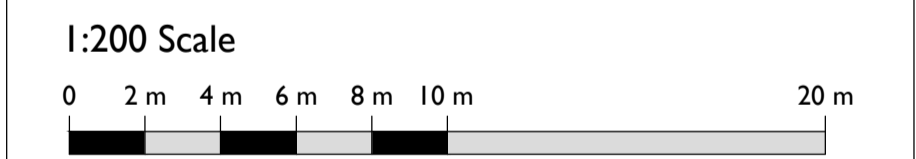

S0 P04	21 Nov 2019	OB	
S5 P01	08 Jul 2019	NS	NS
S5 P00	15 Apr 2019	OB	NS
First Issue 05/08/2020			

ISSUE	DATE	DRAWN	CHECKED	DESCRIPTION
<b>DRAWING TITLE</b>	GA PLAN PROPOSED BASEMENT LEVEL PLAN			
<b>DRAWING NO.</b>	CTH-PUR-MP-B0-DR-A-92000 NMA REV			
<b>REVISION</b>	P00			
<b>SIZE &amp; SCALE</b>	A1L 1:200 @A1			
<b>DRAWING STATUS</b>	S0 - Work In Progress			

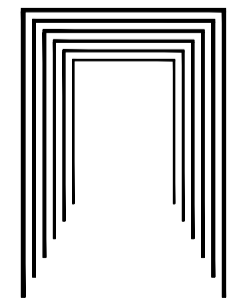
<b>CLIENT</b>	Lendlease	
<b>PROJECT</b>	Camden Town Hall	
<b>JOB NUMBER</b>	238664	

