

Note: Allow for all steelwork to be galvanised to protect against corrosion.

Tripled up 150x50 timbers to act as lintel over opening. Bolt together with M12s at 400mm centres. Lintel to be supported on doubled up timber studs either side of opening.

Perimeter walls to be lightweight timber frame. 150mm x 50mm studs with 12mm WB plywood glued and screwed to both faces.

Suspended timber floor 175x50 C24 timber floor joists at 400mm centres with 18mm WB plywood glued and screwed to top.

Raised steel grillage supported off helical piles. Design and specification of Helical piles by specialist.

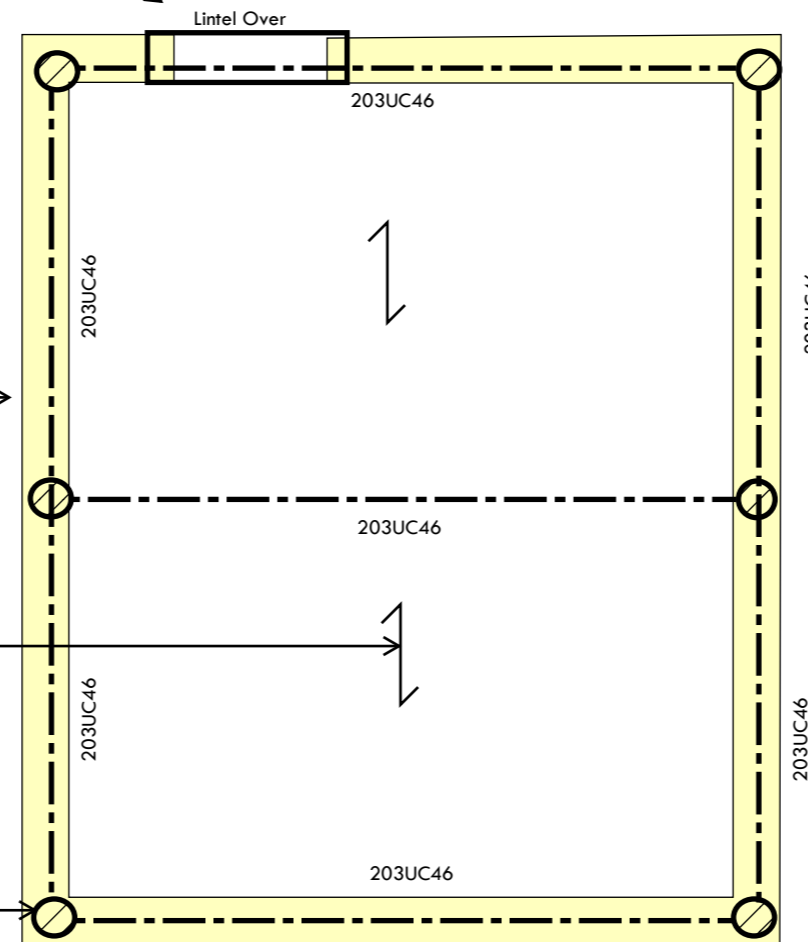

**General notes:**

1. Do not scale from this drawing
2. To be read in conjunction with all other structural drawings and the structural specification
3. To be read in conjunction with all other relevant disciplines drawings and specifications
4. All levels, setting out, waterproofing and fireproofing to be confirmed with the Architect
5. The Contractor is responsible for the temporary stability of the existing and proposed structure throughout the works. The sequencing and method of installation should be carefully considered and the temporary works should be designed and detailed by a suitably qualified person (appointed by the Contractor) prior to commencing the works
6. Contractor to request splices if required for handling purposes



Studio 1, Three Eastfields Avenue, SW18 1GN

020 8191 8688 | www.structuraldesignstudio.co.uk

Project

5A Templewood Avenue, NW3

Drawing Title:

Proposed Garden Store Ground Floor Plan

Job. No.

219003

Drawing no.

L200

Revision

Tender

Scale

1:50@A3

Date

Jan 21

Drawn by

SWA

Rev. no:

T1