

FOR SECTIONS SEE DRAWING KGA/71 2/376

NOTES:

1. This drawing is to be read in conjunction with all other relevant drawings, specifications and schedules of works.
2. For GENERAL NOTES refer to drawing KGA/GN/300.

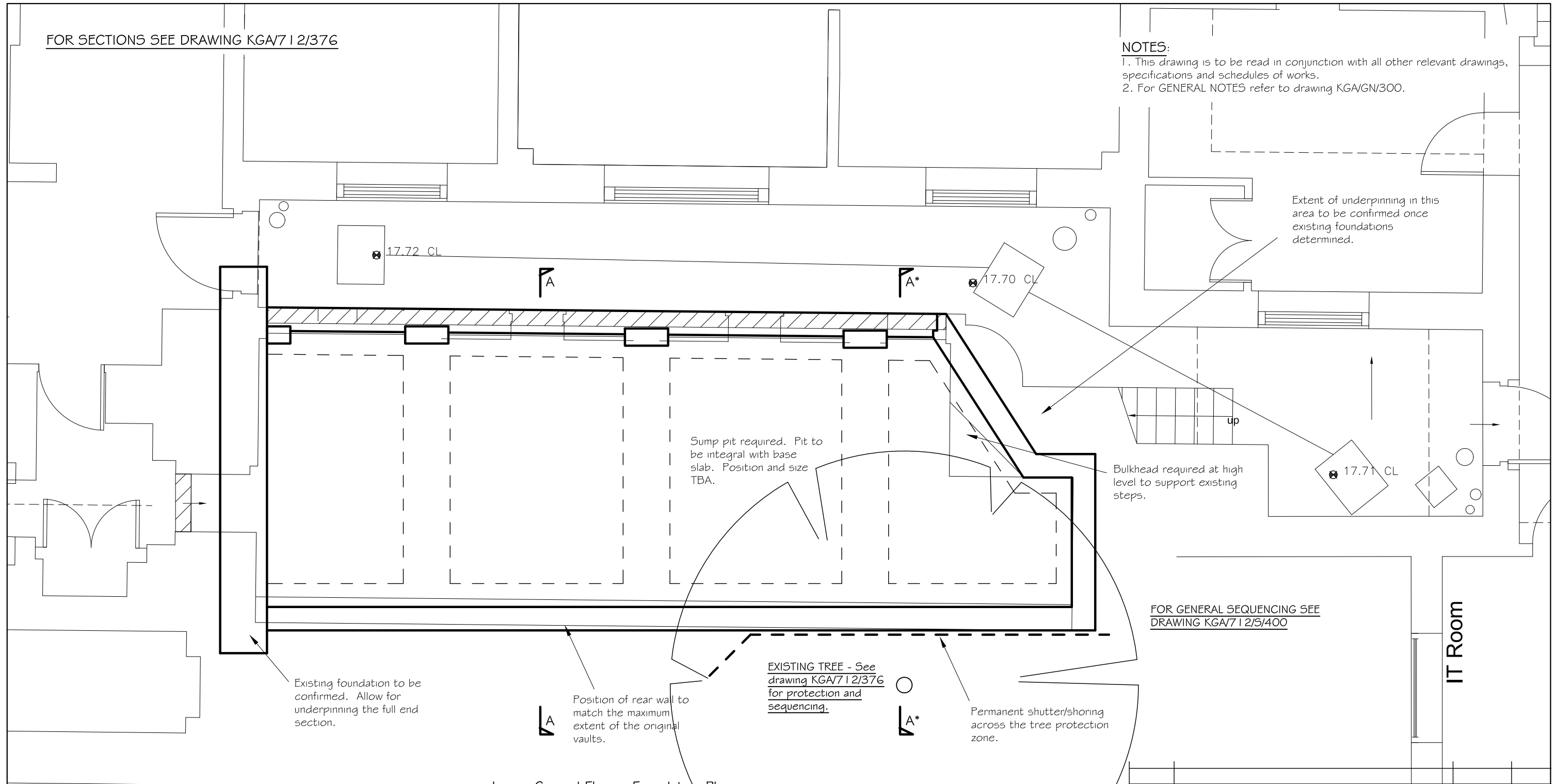

Lower Ground Floor - Foundation Plan

Excavations and new construction:

The proposal is to construct a new plant room within the footprint of the original vaults but to a greater depth, sufficient to accommodate the required plant. The existing finishes and steps that are effected are to be carefully removed and stored for reinstatement on completion of the new plant room. The existing brick vaults are to be demolished as necessary to accommodate the new construction. There is existing drainage local to the excavation area and these are to be protected and maintained throughout the works. The existing foundations for the main building are to be investigated prior to commencing with the main works.

There will be underpinning works required as part of the final scheme and the contractor will need to programme the works around these to ensure that the stability and integrity of the existing building is maintained throughout.

The new construction will comprise: Integral reinforced concrete foundation and base slab, RC retaining walls and RC roof to form a complete box structure. There will be columns to the lightwell side, positions to be agreed with M&E consultant, to allow for ventilation and access.

For Tender pricing allow for all floor, walls and roof to be 300mm thick, columns 300mm x 600mm and foundation thickenings to be 600mm deep. For reinforcement allow T16 @ 150mm centres both ways and both faces. Allow for 4T20 bottom of all foundation deepening with T12 links @ 150mm centres throughout. DESIGN STILL TO BE COMPLETED AND THE INFORMATION PROVIDED IS FOR TENDER PURPOSES ONLY - NOT FOR CONSTRUCTION.

The new room will require tanking and care must be taken to identify the existing tanking especially where it continues onto the existing remaining building. Details to be carefully exposed for inspection by GHK & KGA. Tanking design to be by GHK with input by M&E consultant where services are passing through the new walls.

FOR GENERAL SEQUENCING SEE DRAWING KGA/71 2/5/400

Extent of underpinning in this area to be confirmed once existing foundations determined.

Sump pit required. Pit to be integral with base slab. Position and size TBA.

Bulkhead required at high level to support existing steps.

Existing foundation to be confirmed. Allow for underpinning the full end section.

Position of rear wall to match the maximum extent of the original vaults.

EXISTING TREE - See drawing KGA/71 2/376 for protection and sequencing.

Permanent shutter/shoring across the tree protection zone.

IT Room

Rev.	Description	Date	By
B	Planning Update - Tree Protection Area consideration clarified.	Dec' 2020	kfg
A	Planning Update	Oct' 2020	kfg
	Building Control Issue	March 2020	kfg

client	The Honourable Society of Gray's Inn	drawn	kfg
--------	--------------------------------------	-------	-----

project	Law School Treasury Office Project	date	Feb' 2020
---------	------------------------------------	------	-----------

title	Structural Works - G.A. Plant Room - Vaults Option	scale	1:50 @ A3
-------	--	-------	-----------

Kevin Guilbert Associates		job	KGA/712
Consulting Engineers		drg	375 B
The Annexe, Meadow Cottage, 2 Sea View Road, Mundesley, Norfolk NR11 8DQ Telephone : 01263 721938 Mobile: 07958 208102			

IF IN DOUBT ASK

DO NOT SCALE