

This drawing is copyright and must not be reissued, loaned or copied without the written consent of this practice. All dimensions must be checked on site before proceeding and any discrepancies notified immediately.

All drawings to be read in conjunction with consultant structural engineers, mechanical and electrical consultants, acoustic engineers, energy consultants, etc. design calculation sheets, specifications and drawings plus any accompanying product literature, accredited details, etc.

© Copyright Livemore

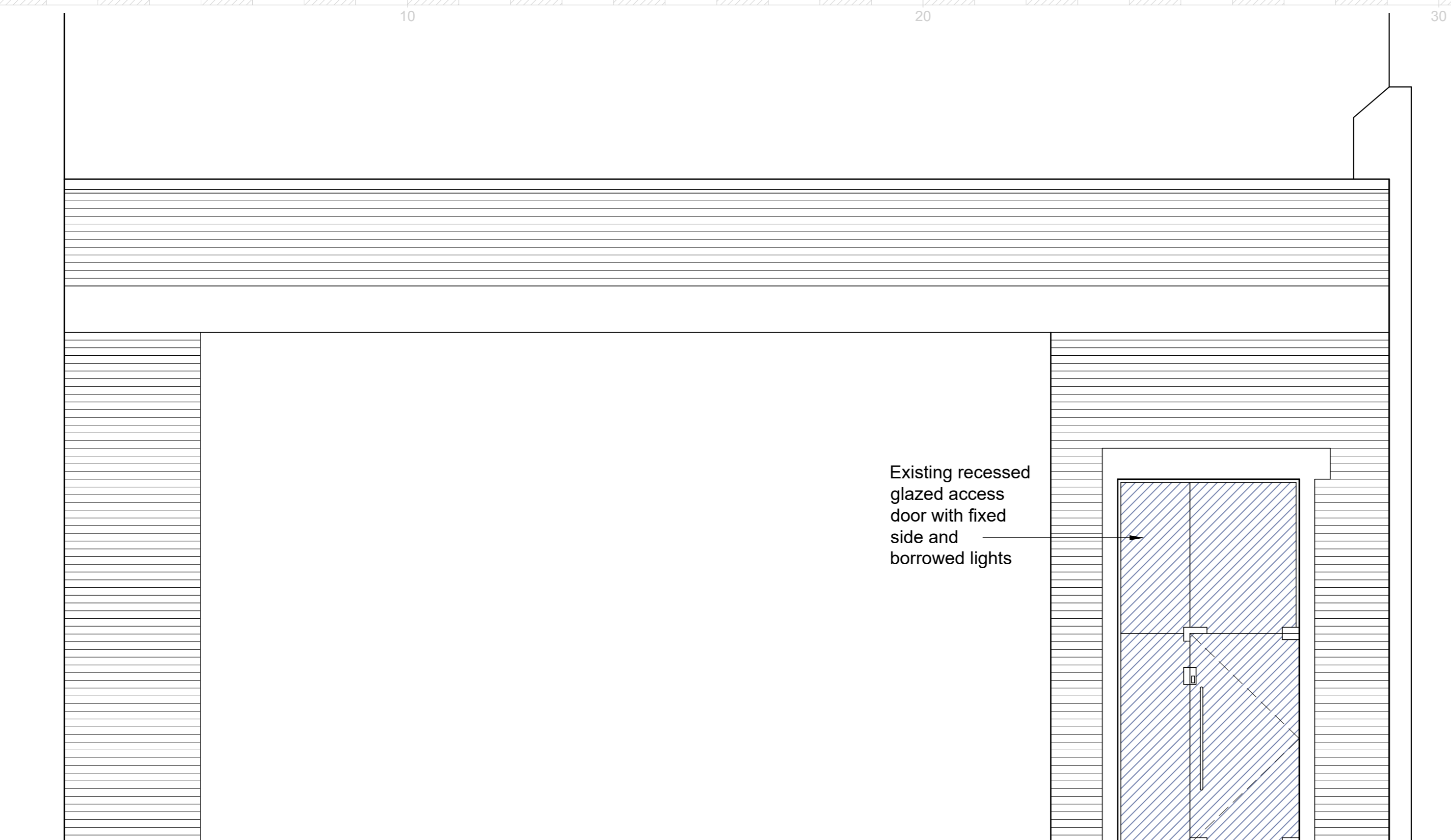

EXISTING ELEVATION
Scale 1:50

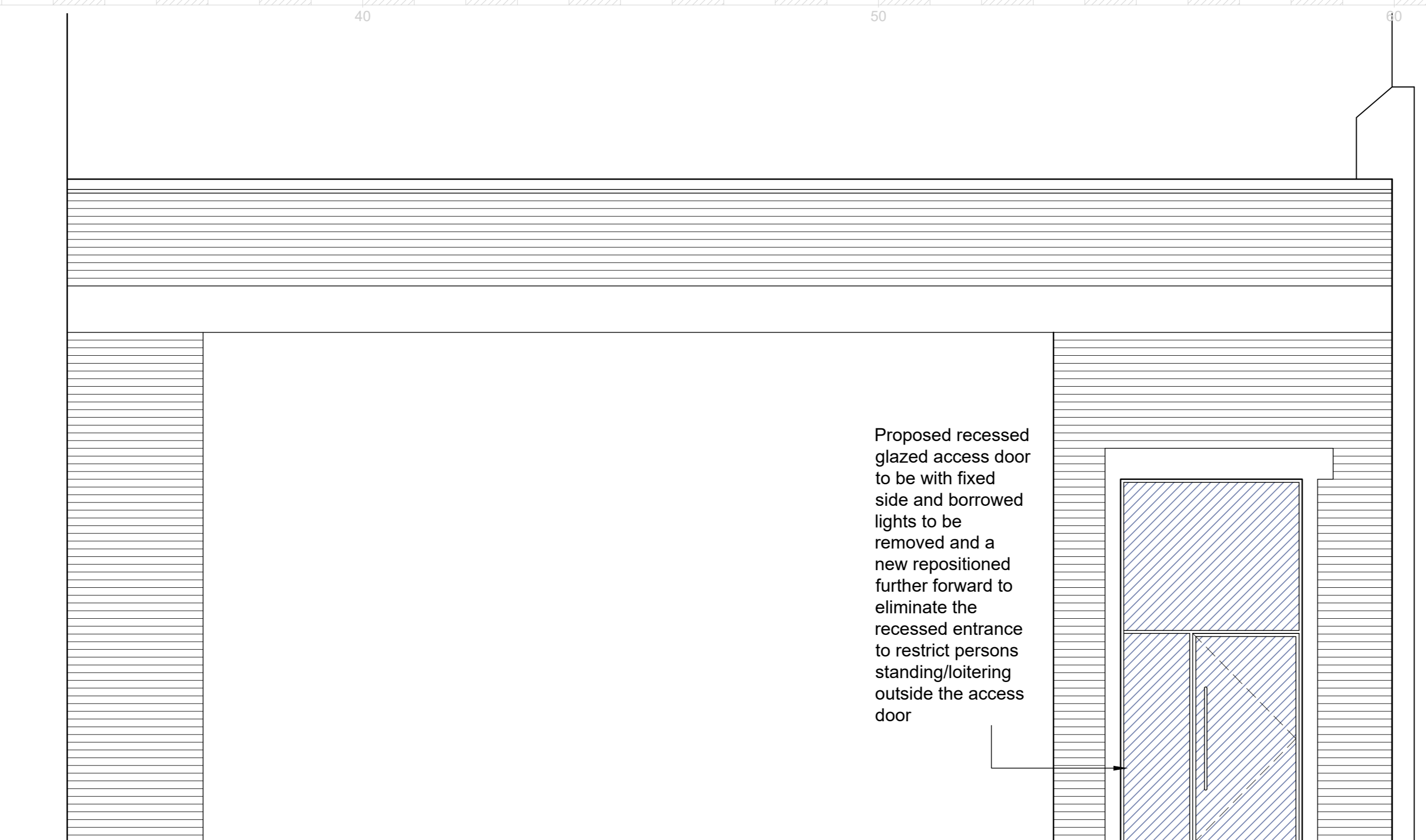

PROPOSED ELEVATION
Scale 1:50

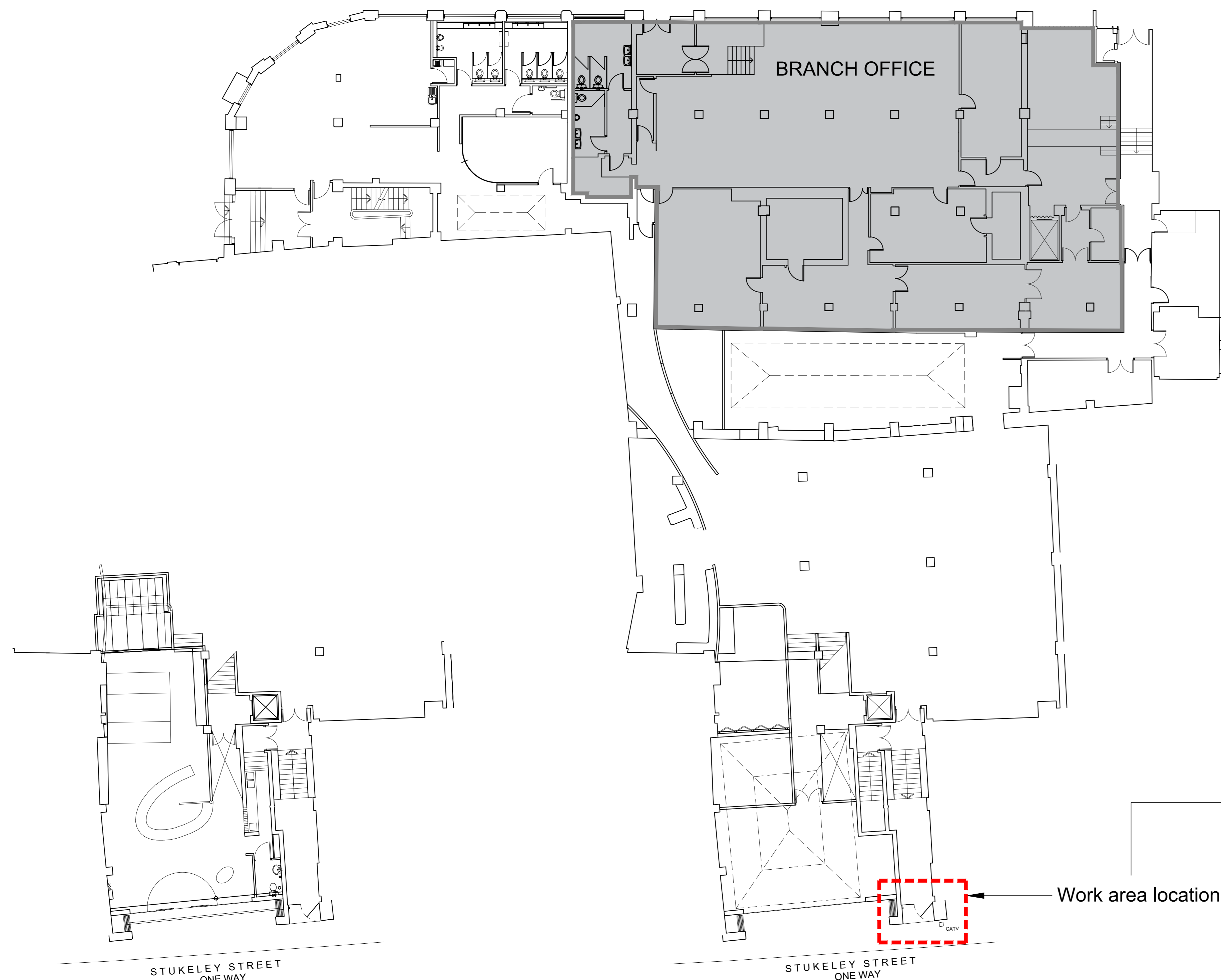

EXISTING LOWER GROUND
FLOOR DEMISE PLAN
SCALE 1:200

EXISTING GROUND
FLOOR DEMISE PLAN
SCALE 1:200

EXISTING PART
GROUND FLOOR PLAN
Scale 1:50

PROPOSED PART
GROUND FLOOR PLAN
Scale 1:50



EXISTING DOOR PHOTOGRAPHS

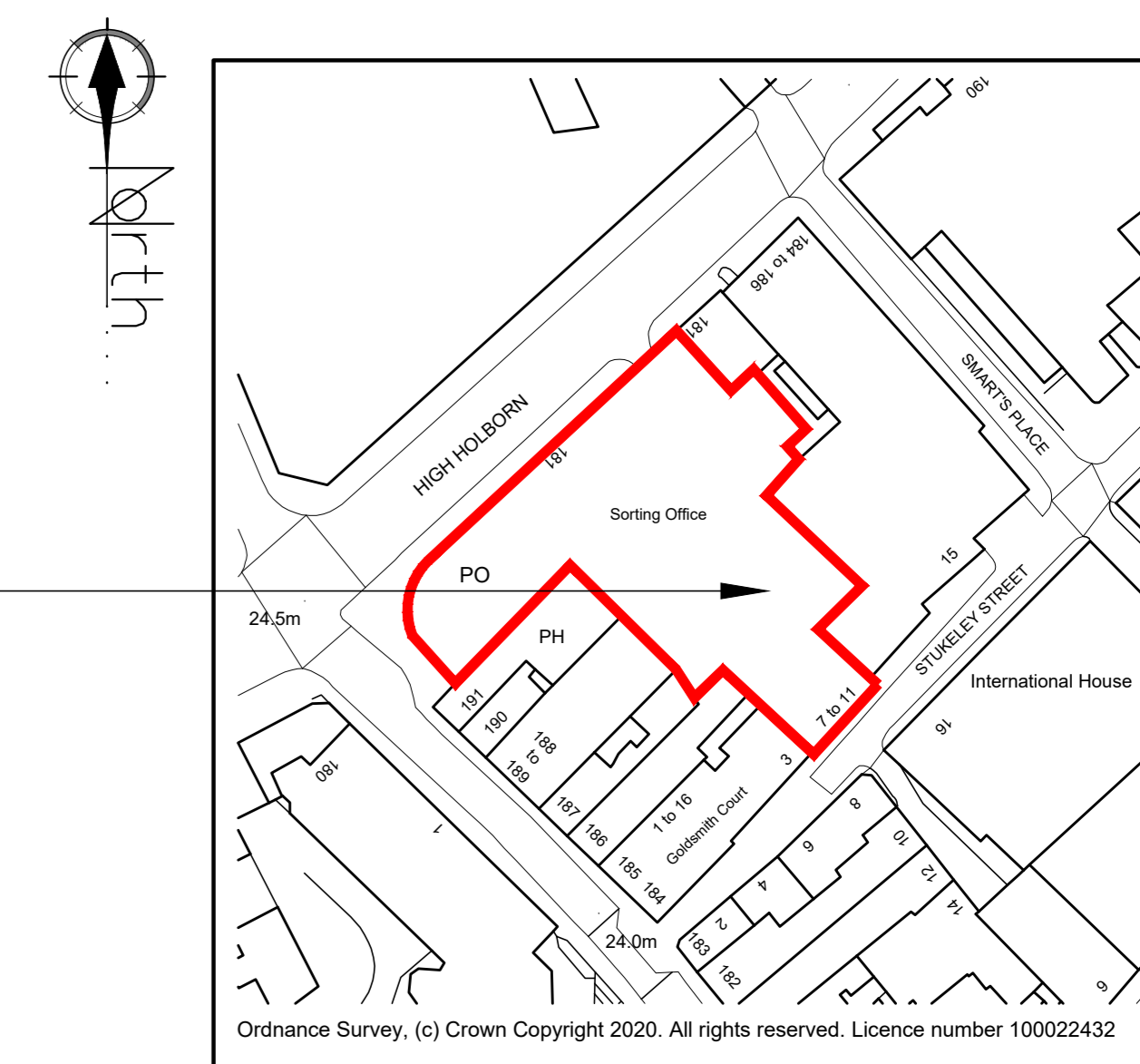

7-11 STUKELEY
STREET, LONDON,
WC1V 7AB

SITE LOCATION PLAN
SCALE 1:1250

B	Door set back	08/02/2021
A	Barrier removed	05/11/2020
-	PLANNING APPLICATION ISSUE	02/07/2020
-	-	-
Rev.	Amendment	Date



Client ROYAL MAIL GROUP LIMITED
Project ENTRANCE DOOR WORKS
7-11 STUKELEY STREET
LONDON, WC1V 7QX

Title EXISTING AND PROPOSED
PART GROUND FLOOR & WORK AREA LOCATION
PLANS & DOOR ELEVATIONS & SITE LOCATION PLAN

Drawn by: D.O Date: 02/07/2020

Checked by: D.O

Scale @ A1: 1:50/200/1250 Drg. No.: 16934-06

Leigh-on-Sea Office
74-76 Broadway
Leigh-on-Sea
Essex SS9 1AE
leigh.office@livemore.co.uk
01702 714977



London Office
14 Grays Inn Road
London
WC1X 8HN

london.office@livemore.co.uk

www.livemore.co.uk