

8 GREENAWAY GARDENS

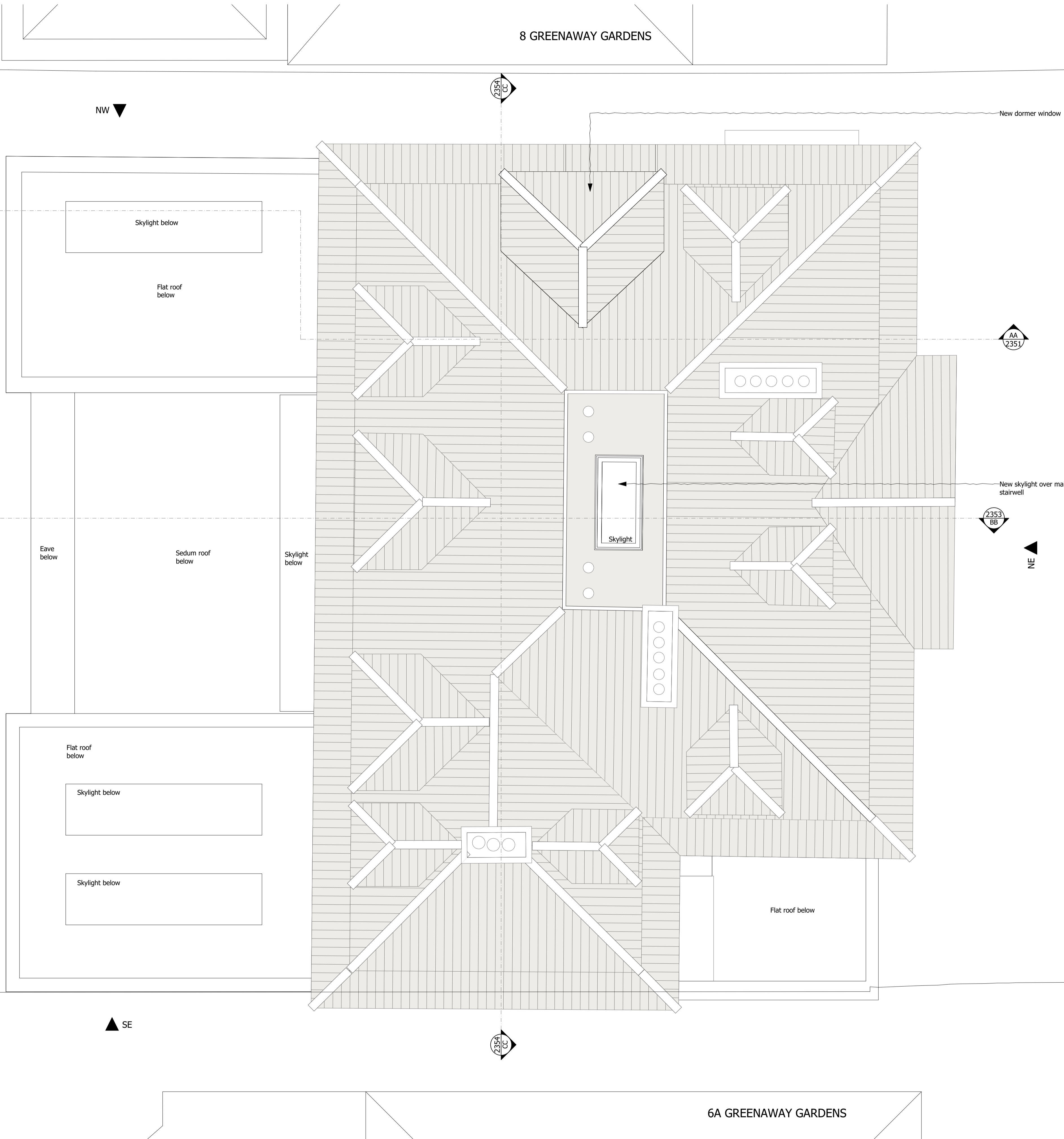

DO NOT SCALE FROM THIS DRAWING

Figured dimensions only are to be taken from this drawing. All dimensions are to be checked on site before any work is put in hand. If in doubt, ask.

All SHH drawings to be read in conjunction with relevant SHH Finishes, Sanitaryware, Lighting & Ironmongery schedules. Any discrepancies to be highlighted to SHH prior to procurement and in good time.

Copyright © Spence Harris Hogan Limited 2021
Registered in England & Wales. Registered No. 261 0615
SHH is the trading name of Spence Harris Hogan Limited

SCALE 1:50@A1, 1:100@A3
0 500 1000 1500 2000mm

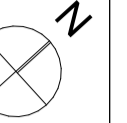

Legends & Notes:

LEGEND AND KEYS

- Existing wall and elements
- New proposed elements

All existing single glazed timber framed windows to be replaced with double glazed timber framed windows on ground and first floor

Rev	Date	Description	Auth
PL01	19/01/2021	Planning Application	ZS

shh

Architecture & Interior Design

RIBA MEMBER
Chartered Practice

1 Vencourt Place, Ravenscourt Park
Hammersmith, London W6 9NJ
Phone: +44 (0) 20 8600 4171 Email: info@shh.co.uk
shh.co.uk

Project:

7 Greenaway Gardens
7 Greenaway Gardens
NW3 7DJ London UK

Client:

Private Client

Drawing Title:

PLANNING

Proposed Roof Plan

(Project number)/DWG number_Revision:

(0941)0457_PL01