

FLOOR PLAN CONTINUES ON LAYOUT NO. (0941)0452

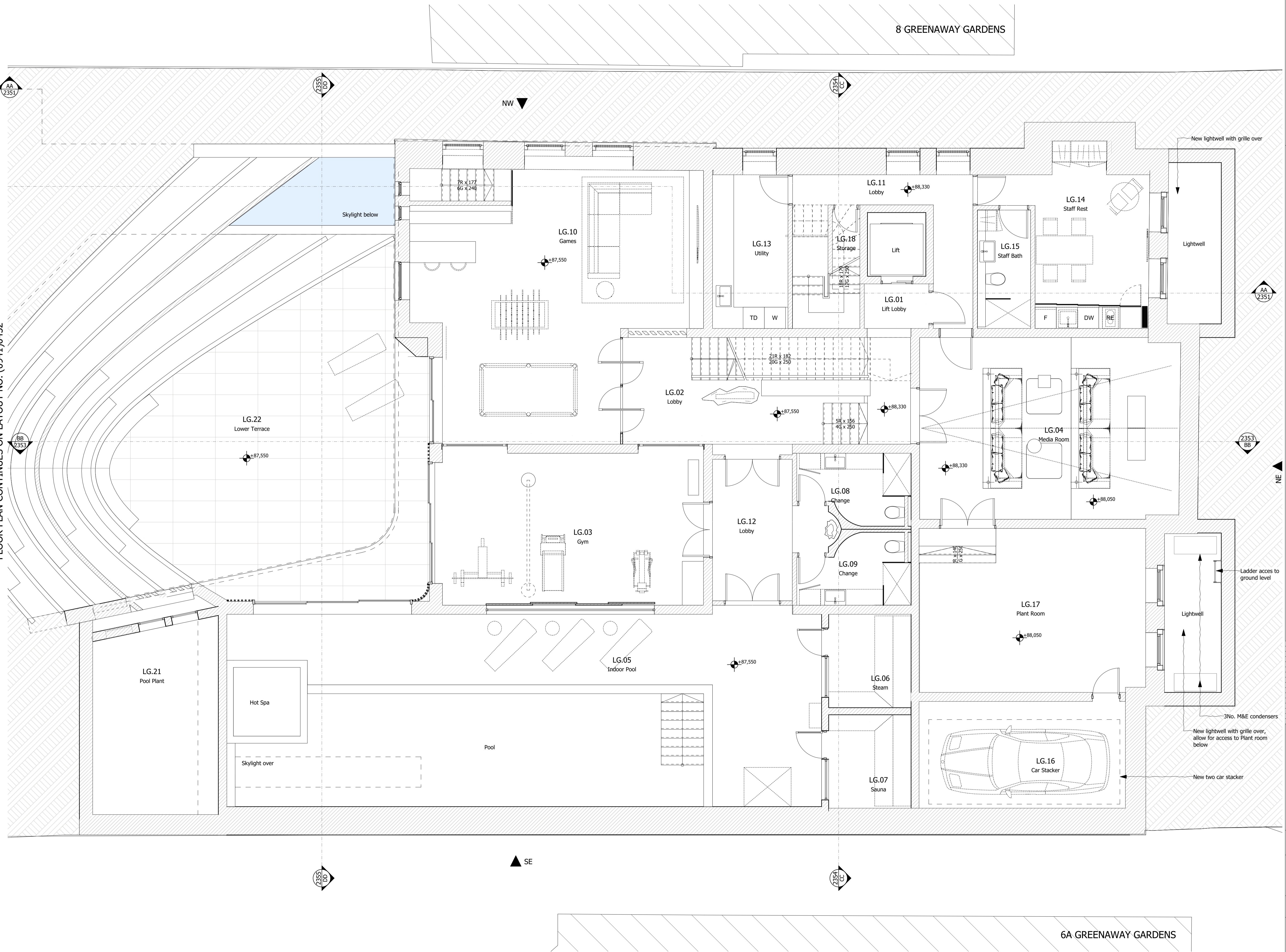

DO NOT SCALE FROM THIS DRAWING
 Figured dimensions only are to be taken from this drawing. All dimensions are to be checked on site before any work is put in hand.
 If in doubt, ask.
 All SHH drawings to be read in conjunction with relevant SHH Finishes, Sanitaryware, Lighting & Ironmongery schedules.
 Any discrepancies to be highlighted to SHH prior to procurement and in good time.
 Copyright © Spence Harris Hogan Limited 2021
 Registered in England & Wales. Registered No. 261 0615
 SHH is the trading name of Spence Harris Hogan Limited

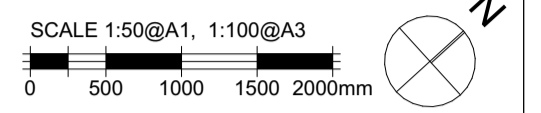

Legends & Notes:
LEGEND AND KEYS

- Existing wall and elements
- New proposed elements

All existing single glazed timber framed windows to be replaced with double glazed timber framed windows on ground and first floor

Floor plan cut plain in Host Building is at 1100mm above 88.330 FFL

Rev	Date	Description	Auth
PL01	19/01/2021	Planning Application	ZS



Architecture & Interior Design
 RIBA MEMBER
 Chartered Practice

1 Vencourt Place, Ravenscourt Park
 Hammersmith, London W6 9NU
 Phone: +44 (0) 20 8600 4171 Email info@shh.co.uk
 shh.co.uk

Project:
7 Greenaway Gardens
 7 Greenaway Gardens
 NW3 7DJ London UK
 Client:
 Private Client

Drawing Title:
PLANNING

Proposed Lower Ground Floor Plan

(Project number)DWG number_Revision:
(0941)0451_PL01