





# BARR GAZETAS

KEY:

-  Existing Walls
-  Proposed Walls
-  Class B1 - Business
-  Plant / Risers / Services
-  Common parts

Note:

Indicates proposed changes to approved planning application 2019/6088/P and approved LBC 2019/6270/L

-  CHANGE AFFECTS HISTORIC FABRIC
-  CHANGE AFFECTS MODERN FABRIC ONLY

**Description of changes**

- A. F/F Lift omitted. Riser and cleaner's cupboard in place from second floor to roof.
- B. Revised primary core layout. Lifts shift approx 300mm to GL/5. WC layout amended to suit. Ref drg 20.301
- C. Stair configuration adapted to suit offset of floor levels. Movement of riser and structural core wall Note - no impact on demolition of historic fabric to suit proposed layout..

Drawings to be read alongside Bidwells Heritage Statement for further detail and justifications of the changes affecting Historic fabric.

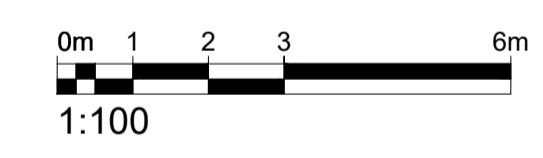
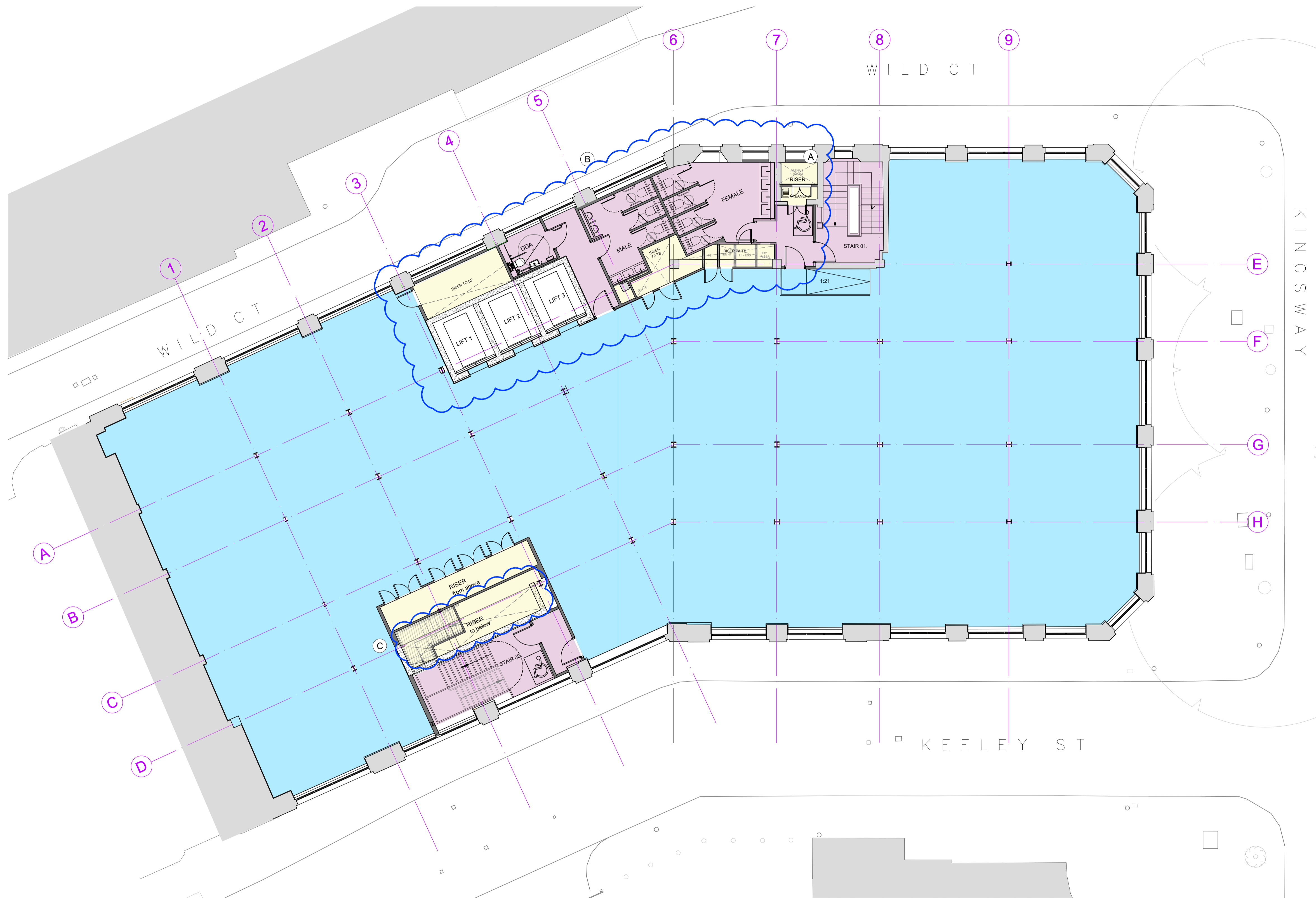

P5	Issued for Planning	AC	28.01.21
P4	Issued for Planning	AC	28.11.19

Rev.	Description.	By	Date
------	--------------	----	------

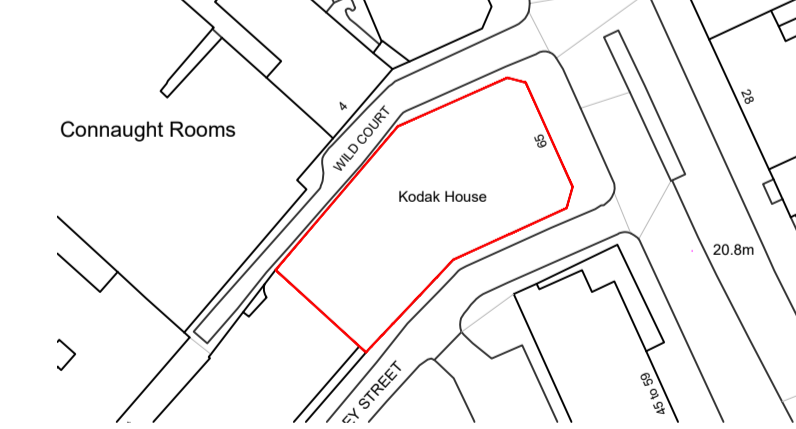

Client  
Kings Keeley Limited C/o Clearbell Capital LLP  
Project  
65 Kingsway - Base Scheme

Title  
Proposed Fifth Floor Plan

Status	Purpose of issue	RIBA stage
S2	For Planning	2

Project No.	Drawn	Checked	Scale	Rev.
1914	FB	TJ	1:100 @ A1 1:200 @ A3	P5

Drawing No.  
**1914-BG-01-05-DR-A-20.207**

Do not scale from this drawing. The Contractor is to take and check all dimensions on site before work commences. Discrepancies must be reported to the Architect. Subcontractors must verify all dimensions on site before making a shop drawing or commencing manufacturing. This drawing is copyright. ©

01 Proposed Fifth Floor Plan  
20.207 1:100@A1, 1:200@A3