

- NOTES:
- 1.0 Do not scale from drawing, use figured dimensions only
  - 1.1 All dimensions to be checked on site
  - 1.2 This drawing to be read in conjunction with all other Gillespies drawings and specifications
  - 1.3 For General Arrangement Landscape Plan, refer to KXC-A-001-L-GIL-00-11201
  - 1.4 For Hard Materials, refer to KXC-A-001-L-GIL-00-11211/12/13/14/15/16/17/18/19/20/21/22/23/24/25/26/27/28/29/30/31/32
  - 1.5 For Overall Levels Plan, refer to KXC-A-001-L-GIL-00-11202
  - 1.6 For Detailed Levels Plans, refer to KXC-A-001-L-GIL-00-11231/1232/1233/1234/1235
  - 1.7 For Specifications, refer to KXC-A-001-L-GIL-90-SP001
  - 1.8 For Sections Plans, refer to KXC-A-001-L-GIL-00-11206
  - 1.9 For Lower Terrace plans, refer to KXC-A-001-L-GIL-00-11251/11255
  - 2.0 For Upper terrace plans, refer to KXC-A-001-L-GIL-00-11261/11265
  - 2.1 For Balustrade details, refer to Schedule Information
  - 2.2 For North shed North shed wall details, refer to BDP's details KXC-A-001-A-BDP-21-51145000071-50041
  - 2.3 Refer All Roof Services refer to KXC-A-001-L-GIL-00-11291 - KXC-A-001-L-GIL-90-11295

KEY

GENERAL

- BMU GATES  
Refer to BDP's drawing
- MOVEMENT JOINT  
Refer to BDP's drawing
- AREAS COVERED UNDER SEPERATE DRAWINGS

EDGES

- EDGE TYPE RE1  
EDGE: 40x40mm return top edge (GL-90-SP001-Q10-2010)  
Refer to Edge details KXC-A-001-L-GIL-90-50042
- EDGE TYPE RE2  
EDGE: 40x40mm return top edge (GL-90-SP001-Q10-2014)  
Refer to Edge details KXC-A-001-L-GIL-90-50041
- EDGE TYPE RE3  
EDGE: 40x40mm return top edge (GL-90-SP001-Q10-2018)  
Refer to Edge details KXC-A-001-L-GIL-90-50042
- EDGE TYPE RE4  
EDGE: 40x40mm return top edge (GL-90-SP001-Q10-2012)  
Refer to Edge details KXC-A-001-L-GIL-90-50043
- EDGE TYPE RESA  
Weathering Steel Flush Edge (GL-90-SP001-Q10-2010)  
Refer to Edge details KXC-A-001-L-GIL-90-50044
- EDGE TYPE RESB  
Weathering Steel Flush Edge (GL-90-SP001-Q10-2010)  
Refer to Edge details KXC-A-001-L-GIL-90-50044
- EDGE TYPE RESC  
Weathering Steel Flush Edge (GL-90-SP001-Q10-2010)  
Refer to Edge details KXC-A-001-L-GIL-90-50044
- EDGE TYPE RE6  
Weathering steel. Refer to BDP's details.  
This also includes perforated panels where required
- EDGE TYPE RE7  
Galvanneal steel edge on slopes (GL-90-SP001-Q10-2019)  
Refer to Edge details KXC-A-001-L-GIL-90-50046
- EDGE TYPE RE8A AND RE8B  
Weathering steel edge on slopes with return top edge (RE8A=GL-90-SP001-Q10-2015 RE8B=GL-90-SP001-Q10-2019)  
Refer to Edge details KXC-A-001-L-GIL-90-50047
- EDGE TYPE RE9A AND RE9B  
40mm planter with top & 40mm high weathered edge behind with return top edge (RE9A=GL-90-SP001-Q10-2011 (GL-90-SP001-Q10-2019)  
Refer to Edge details KXC-A-001-L-GIL-90-50048
- EDGE TYPE RE10A  
RFR Single bench (GL-90-SP001-Q10-2011 (GL-90-2208))  
Refer to Edge details KXC-A-001-L-GIL-90-50049
- EDGE TYPE RE10B  
RFR Single bench (GL-90-SP001-Q10-2011 (GL-90-2202))  
Refer to Edge details KXC-A-001-L-GIL-90-50056
- EDGE TYPE RE10C  
RFR Single bench (GL-90-SP001-Q10-2011 (GL-90-2209))  
Refer to Edge details KXC-A-001-L-GIL-90-50057
- EDGE TYPE RE11  
Movable planters  
In 15° incl Slope
- EDGE TYPE RE12  
Handing planters (GL-90-SP001-Q10-2016)  
Refer to Edge details KXC-A-001-L-GIL-90-50051
- EDGE TYPE RE13a  
Facade planters on flat  
KXC-A-001-L-GIL-91-00022
- EDGE TYPE RE13b  
Facade planters on slope  
KXC-A-001-L-GIL-91-00023
- EDGE TYPE RE15  
Aluminum Flush Edge  
(GL-90-SP001-Q10-2016)
- EDGE TYPE RE16A  
Flush metal edge  
(GL-90-SP001-Q10-2019)
- EDGE TYPE RE17  
Steel planters to Core 3  
(GL-90-SP001-Q10-2012)
- EDGE TYPE RE18  
Movable circular planters  
In flat stage
- WALL TYPE RE20  
North Shed Wall  
(to BDP's detail KXC-A-001-A-BDP-21-51116)
- WALL TYPE RE21  
Retaining Concrete wall  
(to BDP's detail KXC-A-001-A-BDP-21-50041)
- BALUSTRADE 1500MM  
WAREHOUSE LEVEL  
Refer to BDP's drawing
- BALUSTRADE 1200MM  
LOWER TERRACE AND UPPER TERRACE  
Refer to BDP's drawing
- BALUSTRADE 1100MM  
RAMPS, COOLING TOWER VOID & DIAGONAL STAIR  
Refer to BDP's drawing
- TEMPORARY GUARDING SYSTEM  
Refer to Rev's specification KXC-A-001-Y-REV-XX-SP002
- STEP HANDRAIL  
Galvanneal steel to match BDP's handrail on slope steps  
(GL-90-SP001-L37-150A)
- STEP HANDRAIL  
Refer to BDP's Specification #####

FOR ALL EDGES WITH PERFORATION, REFER TO TO DETAILS FOR EXACT LOCATION

FOR CONTINUATION REFER TO KXC-A-001-L-GIL-00-11222

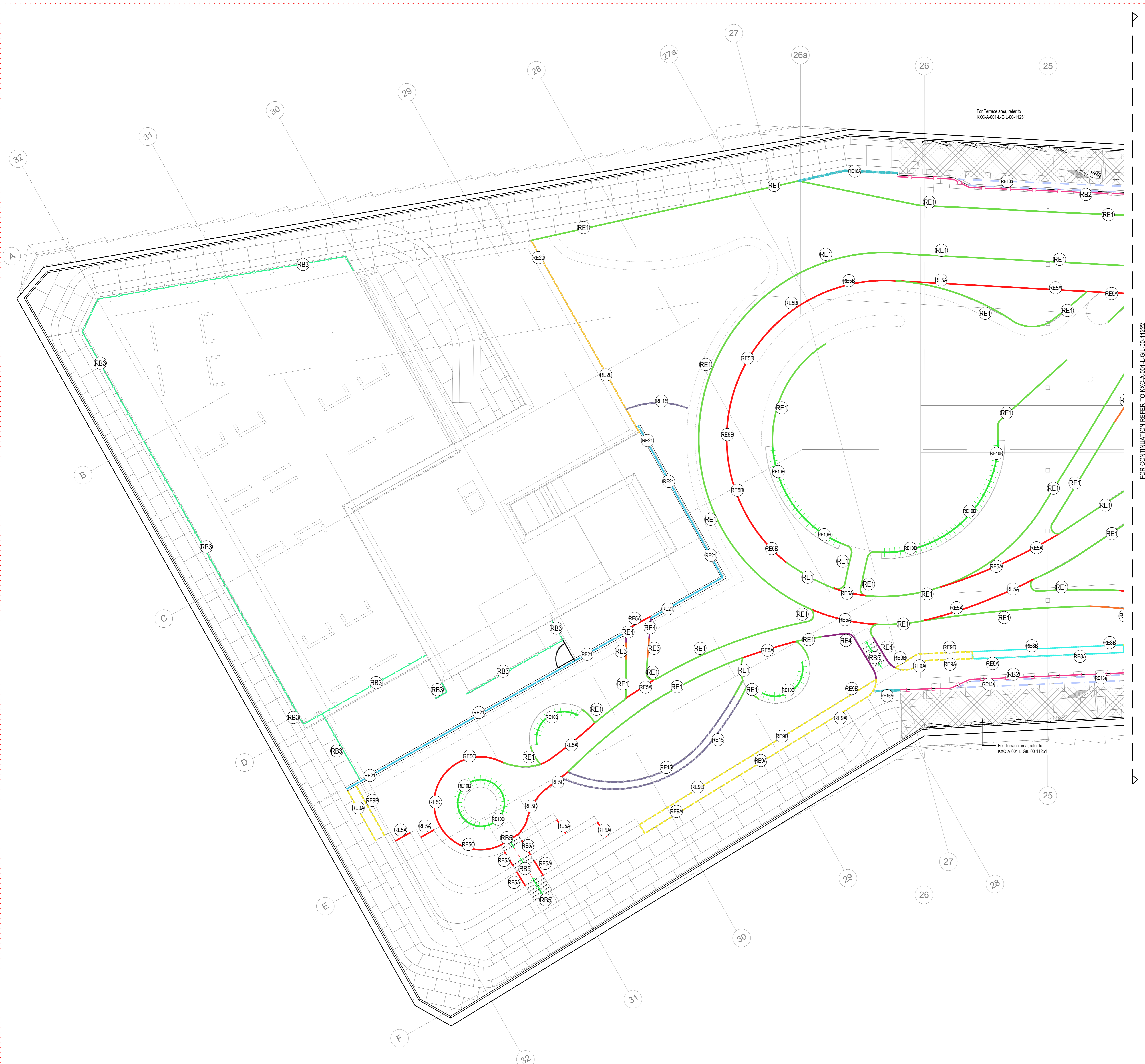

Item	Description	SH	AM	Date
T07	For Tender (CRF 501 / 516)	SH	AM	31.03.20
T08	For Tender (CRF 814)	SH	AM	05.11.19
T09	For Tender (CRF 190)	SH	DC	02.08.18
T04	For Tender (CRF 137)	SH	AM	11.05.18
T03	For Tender (CRF 137)	SH	AM	04.04.18
T02	Stage 4 Update	SH	AM	15.12.17
T01	Stage 4 Issue	CD	AM	29.09.17
PO2	Issued for Stage 4 (95% ISSUE)	MB	AM	11.08.17
PO1	Issued for Stage 4 (75% ISSUE)	CD	AM	21.07.17
PO0	Issued for Stage 4 (50% ISSUE)	CD	AM	20.06.17



© copyright GILLESPIES LLP, all rights reserved

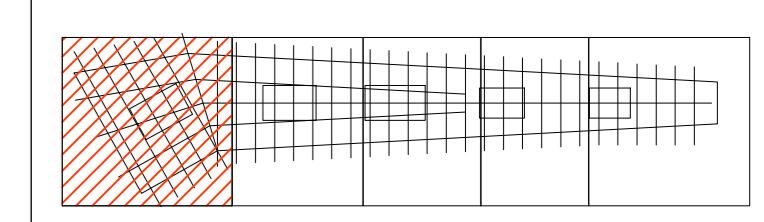

FOR TENDER

Proposed Roof - Detailed Landscape Walls and Edges Plan 01

Scale: 1:100

Author: AD

Checker: CD

Approved: AM

Project No: KXC-A-001-L-GIL-00-11221

Sheet No: T07