

NOTES:  
 1.0 Do not scale from drawing, use figured dimensions only  
 1.1 All dimensions to be checked on site  
 1.2 This drawing to be read in conjunction with all other Gillespies drawings and specifications  
 1.3 For General Arrangement Landscape Plan, refer to KXC-A-001-L-GIL-00-11211 - 11215  
 1.4 For Hard Materials, refer to KXC-A-001-L-GIL-00-11211 - 11215  
 1.5 For Detailed Level Plans, refer to KXC-A-001-L-GIL-00-11241 - 11245  
 1.6 For Specification, refer to KXC-A-001-L-GIL-90-SP001  
 1.7 For Section Plans, refer to KXC-A-001-L-GIL-00-11206  
 1.8 For Lower Terrace plans, refer to KXC-A-001-L-GIL-00-11252 - 11255  
 1.9 For Upper Terrace plans, refer to KXC-A-001-L-GIL-00-11251 - 11255  
 2.0 Refer All Roof Services refer to KXC-A-001-L-GIL-90-11251 - KXC-A-001-L-GIL-90-11255

**KEY**  
**GENERAL**

- BMU GATES  
Refer to BCP's drawing
- MOVEMENT JOINT  
Refer to BCP's drawing
- AREAS COVERED UNDER SEPERATE DRAWINGS

**EDGES**

- EDGE TYPE RE1**  
EDGE 40-60mm with return top edge (GL-90-SP001-Q10-201)  
Refer to Edge details KXC-A-001-L-GIL-90-50040
- EDGE TYPE RE2**  
EDGE 40-60mm with return top edge (GL-90-SP001-Q10-201A)  
Refer to Edge details KXC-A-001-L-GIL-90-50041
- EDGE TYPE RE3**  
EDGE 40-60mm with return top edge (GL-90-SP001-Q10-201B)  
Refer to Edge details KXC-A-001-L-GIL-90-50042
- EDGE TYPE RE4**  
EDGE 60-90mm with return top edge (GL-90-SP001-Q10-201C)  
Refer to Edge details KXC-A-001-L-GIL-90-50043
- EDGE TYPE RESA**  
Weathering Steel Flush Edge (GL-90-SP001-Q10-201D)  
Refer to Edge details KXC-A-001-L-GIL-90-50044
- EDGE TYPE RESB**  
Weathering Steel Flush Edge (GL-90-SP001-Q10-201E)  
Refer to Edge details KXC-A-001-L-GIL-90-50044
- EDGE TYPE RESC**  
Weathering Steel Flush Edge (GL-90-SP001-Q10-201F)  
Refer to Edge details KXC-A-001-L-GIL-90-50044
- EDGE TYPE RE6**  
Weathering Steel Flush Edge (GL-90-SP001-Q10-201G)  
Refer to Edge details KXC-A-001-L-GIL-90-50044
- EDGE TYPE RE7**  
Weathering Steel Flush Edge (GL-90-SP001-Q10-201H)  
Refer to Edge details KXC-A-001-L-GIL-90-50044
- EDGE TYPE RE8A and RE8B**  
40mm planter with top & 40mm high weathered edge behind with return top edge (RESA-GL-90-SP001-Q10-201I) (GL-90-SP001-Q10-201H)  
Refer to Edge details KXC-A-001-L-GIL-90-50047
- EDGE TYPE RE9A and RE9B**  
40mm planter with top & 40mm high weathered edge behind with return top edge (RESA-GL-90-SP001-Q10-201J) (GL-90-SP001-Q10-201H)  
Refer to Edge details KXC-A-001-L-GIL-90-50048
- EDGE TYPE RE10A**  
R/FB Single bench (GL-90-SP001-Q10-201L) (GL-90-2200)  
Refer to Edge details KXC-A-001-L-GIL-90-50049
- EDGE TYPE RE10B**  
R/FB Single bench (GL-90-SP001-Q10-201M) (GL-90-2200)  
Refer to Edge details KXC-A-001-L-GIL-90-50050
- EDGE TYPE RE10C**  
R/FB Single bench (GL-90-SP001-Q10-201N) (GL-90-2200)  
Refer to Edge details KXC-A-001-L-GIL-90-50051
- EDGE TYPE RE11**  
Movable planters  
In F-out stage
- EDGE TYPE RE12**  
Fixed planters (GL-90-SP001-Q10-201O)  
Refer to Edge details KXC-A-001-L-GIL-90-50051
- EDGE TYPE RE13a**  
Facade planters on slope  
KXC-A-001-L-GIL-91-50022
- EDGE TYPE RE13b**  
Facade planters on slope  
KXC-A-001-L-GIL-91-50023
- EDGE TYPE RE15**  
Aluminum Flush Edge  
(GL-90-SP001-Q10-201S)
- EDGE TYPE RE16A**  
Flush metal edge  
(GL-90-SP001-Q10-201P)
- EDGE TYPE RE17**  
Steel planters to Core 3  
(GL-90-SP001-Q10-201Q)
- EDGE TYPE RE18**  
Movable circular planters  
In F-out stage
- WALL TYPE RE20**  
North Stone Wall  
(to BCP's detail KXC-A-001-A-BSP-21-51116)
- WALL TYPE RE21**  
Retaining Concrete wall  
(to BCP's detail KXC-A-001-A-BSP-27-50041)
- BALUSTRADE 1500MM**  
WAREHOUSE LEVEL  
Refer to BCP's drawing
- BALUSTRADE 1200MM**  
LONGER THAN AND SPACES 1000  
Refer to BCP's drawing
- BALUSTRADE 1100MM**  
RAMPS, COOLING TOWER VOID & DIAGONAL STAIR  
Refer to BCP's drawing
- TEMPORARY GUARDING SYSTEM**  
Refer to BCP's Specification KXC-A-001-V-SEE-XX-SP002
- STEP HANDRAIL**  
Galvanized steel to match BCP's handrail on slope steps  
(GL-90-SP001-L37-1504)
- STEP HANDRAIL**  
Refer to BCP's Specification

FOR ALL EDGES WITH PERFORATION, REFER TO TO DETAILS FOR EXACT LOCATION

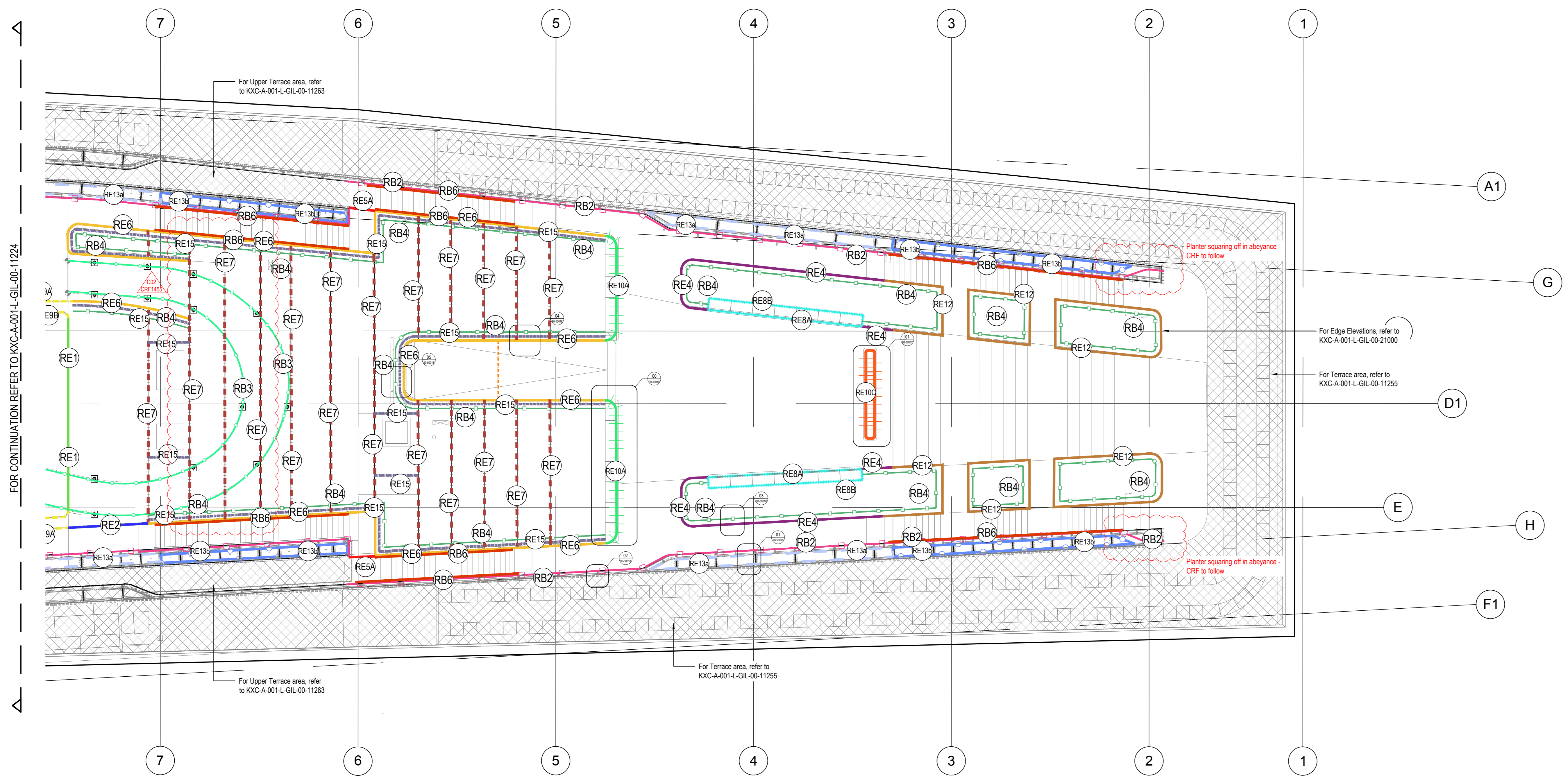

FOR CONTINUATION REFER TO KXC-A-001-L-GIL-00-11224

Code	Description	SH	AM	Date
C02	For Construction (CRF 1455)	SH	AM	16.10.20
C01	For Construction (CRF 1298)	SH	AM	24.04.20
T07	Issued for Tender (CRF 1157)	SH	AM	14.02.20
T06	For Tender (CRF 593)	SH	AM	10.01.20
T05	For Tender (CRF 614 & 183)	SH	AM	30.09.19
T04	For Tender (CRF 177)	SH	DC	02.08.18
T03	For Tender (NMC - Clarify edge material)	SH	AM	08.08.18
T02	Stage 4 Update	SH	AM	15.12.17
T01	Stage 4 Issue	CD	AM	29.09.17
P02	Issued for Stage 4 (95% ISSUE)	DB	AM	11.08.17
P01	Issued for Stage 4 (75% ISSUE)	CD	AM	21.07.17
P00	Issued for Stage 4 (50% ISSUE)	CD	AM	20.06.17

**GILLESPIES**  
 18 Pancras Square, London, EC2A 4DF  
 P: 020 7323 2629 F: 020 7323 3881 E: info@gillespies.com

© copyright GILLESPIES LLP, all rights reserved

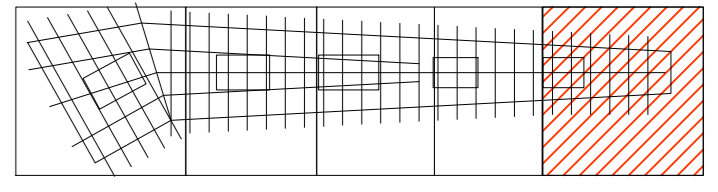

**FOR CONSTRUCTION**

Proposed Roof - Detailed Landscape Walls and Edges Plan 05

Scale: 1:100

Drawn by: AD

Checked by: AM

Project: KXC-A-001-L-GIL-00-11225

Sheet: C02

