

NOTES:
1.0 Do not scale from drawing, use figured dimensions only
1.1 All dimensions to be checked on site
1.2 This drawing to be read in conjunction with all other Gillespies drawings and specifications
1.3 For General Arrangement Landscape Plan, refer to KXC-A-001-L-GIL-00-11201
1.4 For Hard Materials, refer to KXC-A-001-L-GIL-00-11211/12/13/14/15/16/17/18/19/20/21/22/23/24/25/26/27/28/29/30/31/32/33/34/35/36/37/38/39/40/41/42/43/44/45/46/47/48/49/50/51/52/53/54/55/56/57/58/59/60/61/62/63/64/65/66/67/68/69/70/71/72/73/74/75/76/77/78/79/80/81/82/83/84/85/86/87/88/89/90/91/92/93/94/95/96/97/98/99/100
1.5 For Overall Levels Plan, refer to KXC-A-001-L-GIL-00-11202
1.6 For Detailed Levels Plans, refer to KXC-A-001-L-GIL-00-11211/12/13/14/15/16/17/18/19/20/21/22/23/24/25/26/27/28/29/30/31/32/33/34/35/36/37/38/39/40/41/42/43/44/45/46/47/48/49/50/51/52/53/54/55/56/57/58/59/60/61/62/63/64/65/66/67/68/69/70/71/72/73/74/75/76/77/78/79/80/81/82/83/84/85/86/87/88/89/90/91/92/93/94/95/96/97/98/99/100
1.7 For Specifications, refer to KXC-A-001-L-GIL-00-SP001
1.8 For Sections Plans, refer to KXC-A-001-L-GIL-00-11206
1.9 For Lower Terrace plans, refer to KXC-A-001-L-GIL-00-11251/1252/1253/1254/1255/1256/1257/1258/1259/1260/1261/1262/1263/1264/1265/1266/1267/1268/1269/1270/1271/1272/1273/1274/1275/1276/1277/1278/1279/1280/1281/1282/1283/1284/1285/1286/1287/1288/1289/1290/1291/1292/1293/1294/1295/1296/1297/1298/1299/1300
2.1 For Balustrade details, refer to Schedule Information
2.2 For North shed North shed wall details, refer to BOP's details
2.3 Refer All Roof Services refer to KXC-A-001-L-GIL-00-11291 - KXC-A-001-L-GIL-00-11295

- KEY**
- GENERAL**
- BMU GATES
Refer to BOP's drawing
 - MOVEMENT JOINT
Refer to BOP's drawing
 - AREAS COVERED UNDER SEPERATE DRAWINGS
- EDGES**
- EDGE TYPE RE1
EDGE 40-60mm with return top edge (GL-90-SP001-Q10-201)
Refer to Edge details KXC-A-001-L-GIL-90-50040
 - EDGE TYPE RE2
EDGE 40mm with return top edge (GL-90-SP001-Q10-201A)
Refer to Edge details KXC-A-001-L-GIL-90-50041
 - EDGE TYPE RE3
EDGE 40-60mm with return top edge (GL-90-SP001-Q10-201B)
Refer to Edge details KXC-A-001-L-GIL-90-50042
 - EDGE TYPE RE4
EDGE 40-60mm with return top edge (GL-90-SP001-Q10-201C)
Refer to Edge details KXC-A-001-L-GIL-90-50043
 - EDGE TYPE RE5A
Weathering Steel Flush Edge (GL-90-SP001-Q10-201D)
Refer to Edge details KXC-A-001-L-GIL-90-50044
 - EDGE TYPE RE5B
Weathering Steel Flush Edge (GL-90-SP001-Q10-201E)
Refer to Edge details KXC-A-001-L-GIL-90-50044
 - EDGE TYPE RE6
Weathering steel, see to BOP's details.
This also includes perforator panels where required
 - EDGE TYPE RE7
General steel edge on slopes (GL-90-SP001-Q10-201F)
Refer to Edge details KXC-A-001-L-GIL-90-50046
 - EDGE TYPE RE8A AND RE8B
RPA - 40mm bench & 60 high weathered steel edge behind with return top edge (RPA-40-90-SP001-Q10-201G) (GL-90-SP001-Q10-201H)
Refer to Edge details KXC-A-001-L-GIL-90-50047
 - EDGE TYPE RE8A AND RE8B
40mm planter with top & 60mm high weathered steel edge behind with return top edge (RPA-40-90-SP001-Q10-201I) (GL-90-SP001-Q10-201J)
Refer to Edge details KXC-A-001-L-GIL-90-50048
 - EDGE TYPE RE10A
RPA Edge bench (GL-90-SP001-Q10-201K) (GL-90-50049)
Refer to Edge details KXC-A-001-L-GIL-90-50049
 - EDGE TYPE RE10B
RPA Single bench (GL-90-SP001-Q10-201L) (GL-90-50050)
Refer to Edge details KXC-A-001-L-GIL-90-50050
 - EDGE TYPE RE10C
RPA Single bench (GL-90-SP001-Q10-201M) (GL-90-50051)
Refer to Edge details KXC-A-001-L-GIL-90-50051
 - EDGE TYPE RE11
Weathering steel
In Fit out Stage
 - EDGE TYPE RE12
Weathering steel (GL-90-SP001-Q10-201N)
Refer to Edge details KXC-A-001-L-GIL-90-50051
 - EDGE TYPE RE13a
Facade planter on full
KXC-A-001-L-GIL-91-00022
 - EDGE TYPE RE13b
Facade planter on edge
KXC-A-001-L-GIL-91-00023
 - RE14 BMU PLANTER EDGE
Refer to KXC-A-001-L-GIL-91-00024 and KXC-A-001-L-GIL-91-00025 for detail.
Refer to Terrace Plans for full extents
KXC-A-001-L-GIL-00-11251 - KXC-A-001-L-GIL-00-11255
 - EDGE TYPE RE15
Aluminium Flush Edge
(GL-90-SP001-Q10-201O)
 - EDGE TYPE RE16A
RPA metal edge
(GL-90-SP001-Q10-201P)
 - EDGE TYPE RE17
Steel planter to Core 2
(GL-90-SP001-Q10-201Q)
 - EDGE TYPE RE18
Weathering steel circular planters
In Fit out stage
 - RE19 STEEL EDGE
Refer to KXC-A-001-L-GIL-91-00024 and KXC-A-001-L-GIL-91-00025 for detail.
(GL-90-SP001-Q10-201R)
Refer to Terrace Plans for full extents
KXC-A-001-L-GIL-00-11251 - KXC-A-001-L-GIL-00-11255
 - EDGE TYPE RE20
North Shed Wall Steel Trunk
No BOP's detail KXC-A-001-L-GIL-91-00026
 - BALLUSTRADE 1500MM
Weathering steel
Refer to BOP's drawing
 - BALLUSTRADE 1200MM
CORNER TRAP AND UPPER TRAY
Refer to BOP's drawing
 - BALLUSTRADE 1100MM
RAVINE COOLING TOWER VOID & DIAGONAL STAR
Refer to BOP's drawing
 - TEMPORARY GUARDING SYSTEM
Refer to BOP's drawing
 - HANDRAIL
General steel to match BOP's handrail on slope edges
(GL-90-SP001-L37-150A)

FOR ALL EDGES WITH PERFORATION, REFER TO TO DETAILS FOR EXACT LOCATION

T05	For Tender (CRF 593)	SH	AM	10.01.20
T04	For Tender (CRF 614 & CRF 915)	SH	AM	02.12.19
T03	For Tender (CRF 137)	SH	AM	04.04.18
T02	Stage 4 Update	SH	AM	15.12.17
T01	Stage 4 Issue	CD	AM	29.09.17
P02	Issued for Stage 4 (95% ISSUE)	MB	AM	11.08.17
P01	Issued for Stage 4 (75% ISSUE)	CD	AM	21.07.17
P00	Issued for Stage 4 (50% ISSUE)	CD	AM	20.06.17

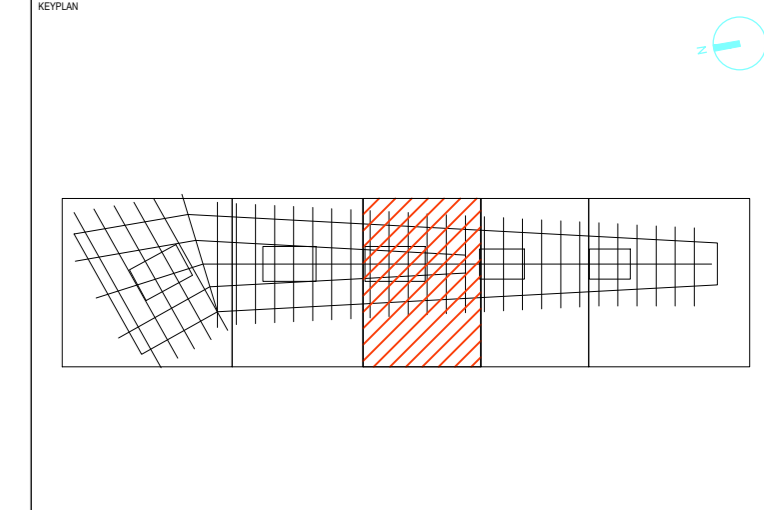
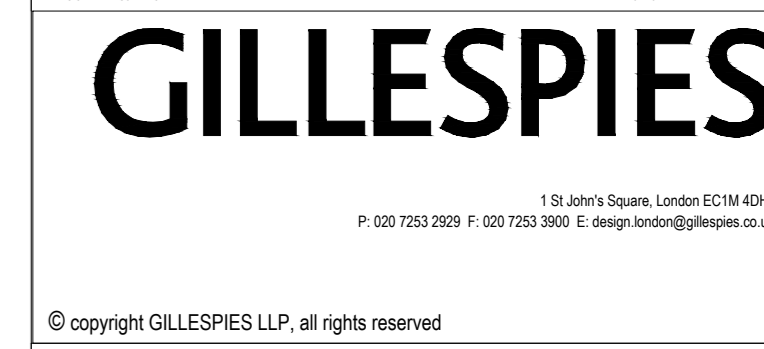

FOR TENDER

Issue No.	2008/2017
Project No.	P2007133
Scale	1:100
Author	AD
Checker	CD
Approver	AM
Project Name	KXC-A-001-L-GIL-00-11223
Sheet No.	T05

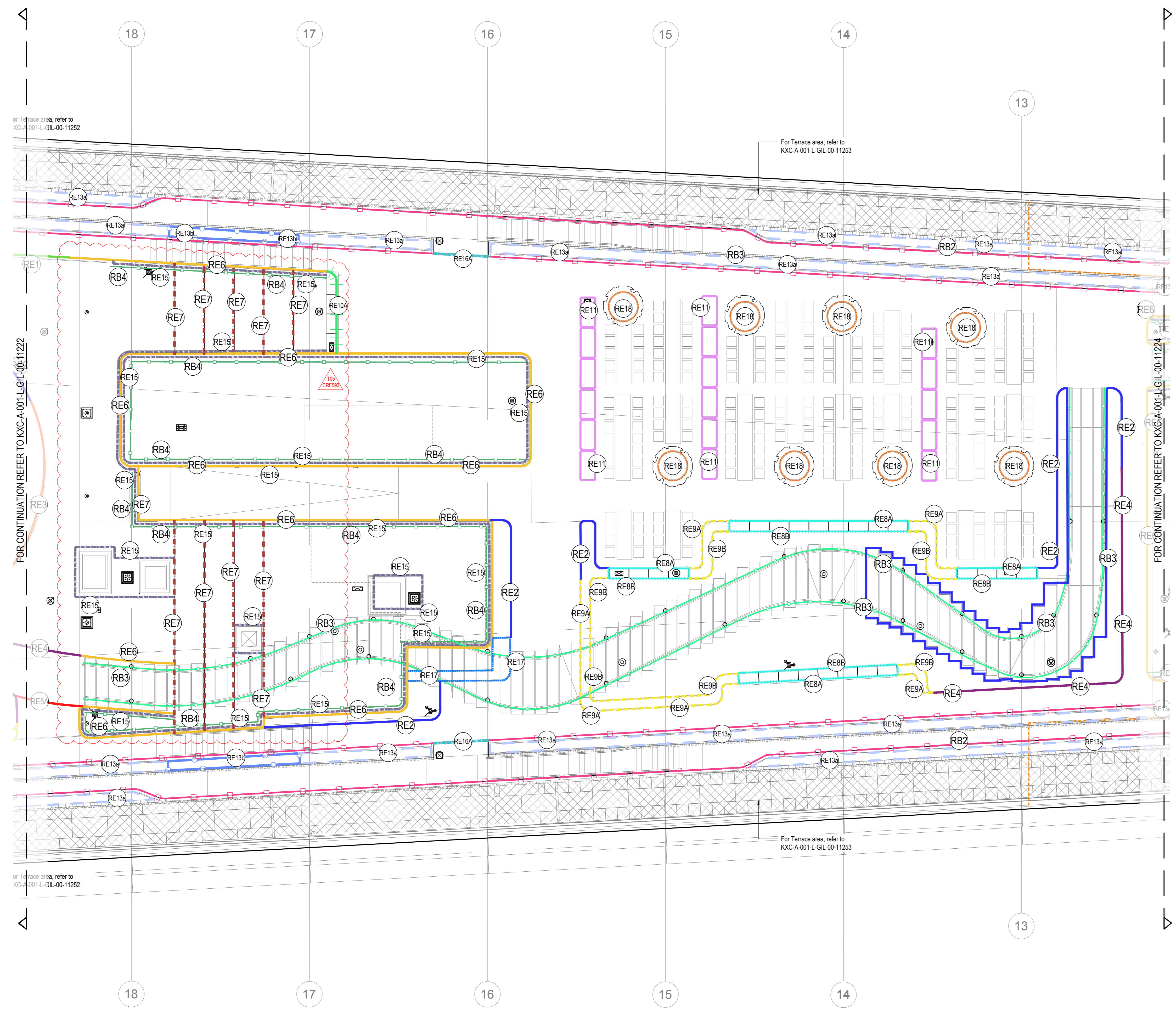

FOR CONTINUATION REFER TO KXC-A-001-L-GIL-00-11224

FOR CONTINUATION REFER TO KXC-A-001-L-GIL-00-11224

FOR CONTINUATION REFER TO KXC-A-001-L-GIL-00-11224

For Terrace area, refer to KXC-A-001-L-GIL-00-11253

For Terrace area, refer to KXC-A-001-L-GIL-00-11253