



LOCATION A WITHOUT POLE



LOCATION A WITH POLE

DESCRIPTION:

The existing 5.5-metre high pole 24A to be removed and to replace the parking sign pole in its existing position at the rear of the footpath adjacent to and <150 from the brick garden fence wall to the Redington Road flank of 13 West Heath Road with a clear nylon filament crossing Redington Road to a matching pole at the rear of the footpath immediately to the right of the third pier from the 11 West Heath Road driveway gates and to allow the existing parking pole at the north end of the multi-car parking bay which to be removed.

Refix hydrant sign centred @ 750mmAGL at left hand end of recessed brick panel behind existing parking pole B position, parking signs to poles A and B at existing height and reinstate footpaths using existing salvaged red paviers.

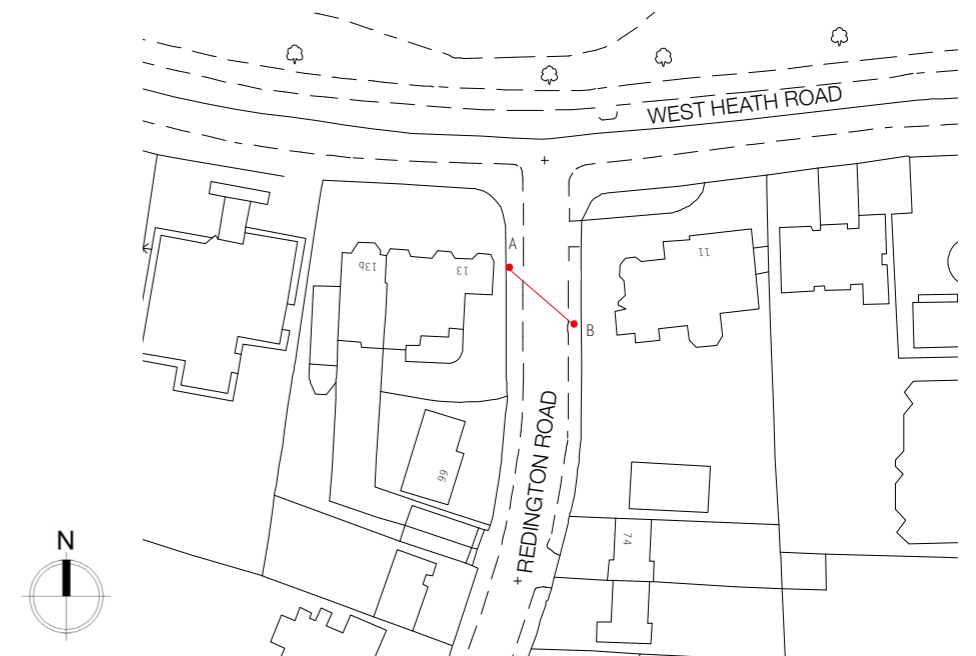

LOCATION PLAN SCALE 1:1250

REV'N C

DRAWING REF: 868.24A

CAMDEN ERUV - LOCATION 24 - REDINGTON ROAD

ROSENFELDER ASSOCIATES
 Chartered Architects + Planning Consultants
 10-12 Perrins Court Hampstead LONDON NW3 (020) 7794 4425



LOCATION B WITHOUT POLE



LOCATION B WITH POLE

DESCRIPTION:

The existing 5.5-metre high pole 24A to be removed and to replace the parking sign pole in its existing position at the rear of the footpath adjacent to and <150 from the brick garden fence wall to the Redington Road flank of 13 West Heath Road with a clear nylon filament crossing Redington Road to a matching pole at the rear of the footpath immediately to the right of the third pier from the 11 West Heath Road driveway gates and to allow the existing parking pole at the north end of the multi-car parking bay which to be removed.

Refix hydrant sign centred @ 750mmAGL at left hand end of recessed brick panel behind existing parking pole B position. parking signs to poles A and B at existing height and reinstate footpaths using existing salvaged red paviers.

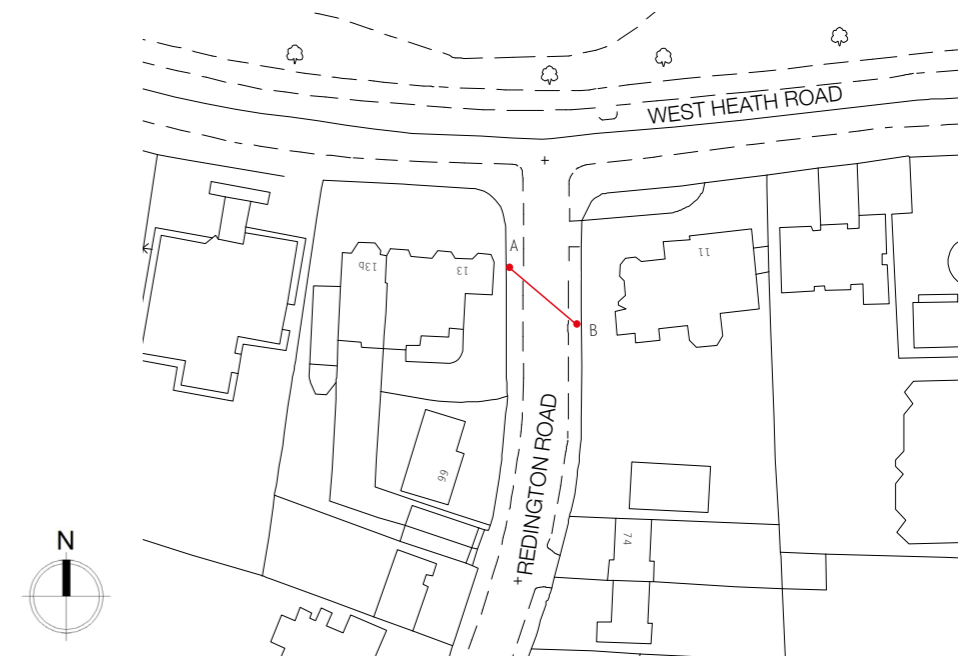

LOCATION PLAN SCALE 1:1250

REV'N C

DRAWING REF: 868.24B

CAMDEN ERUV - LOCATION 24 - REDINGTON ROAD

ROSENFELDER ASSOCIATES
 Chartered Architects + Planning Consultants
 10-12 Perrins Court Hampstead LONDON NW3 (020) 7794 4425