

Property boundary

Basement boundary

P1	RJS	Initial Issue	14.12.2020
Rev	Iss.	Description	Date

DRAWING TITLE
Location Plan

PROJECT NAME
External alterations

ADDRESS
64 Goodge Street, London. W1

CLIENT
Shaftesbury Charlotte Street Ltd

DRAWN BY RJS	CHECKED BY RS
-----------------	------------------

JOB NO.
25003

SCALE
1:1250@A3

DATE
Dec 2020

DRAWING NO.
A-000-P1

ft

ft & co

Disclaimer and Notes
Do not scale this drawing. All dimensions should be checked on site. Any discrepancy found between this drawing, site and any other document should be referred immediately to Fresson and Tee. All drawings should be read in conjunction with all other contract documents and specifications and all other consultants drawings.
Copying or reproduction of this drawing without the written permission of Fresson and Tee is not permitted. Copyright is Reserved
The PDF hard copy accompanying the CAD data is legal transmission of information. The electronic copies are issued only for convenience of use and record of original file. No liability for the accuracy or for any consequence resulting from the use, additions or alteration of information is accepted by Fresson and Tee.
Title plan at 1:1250 and North point is up

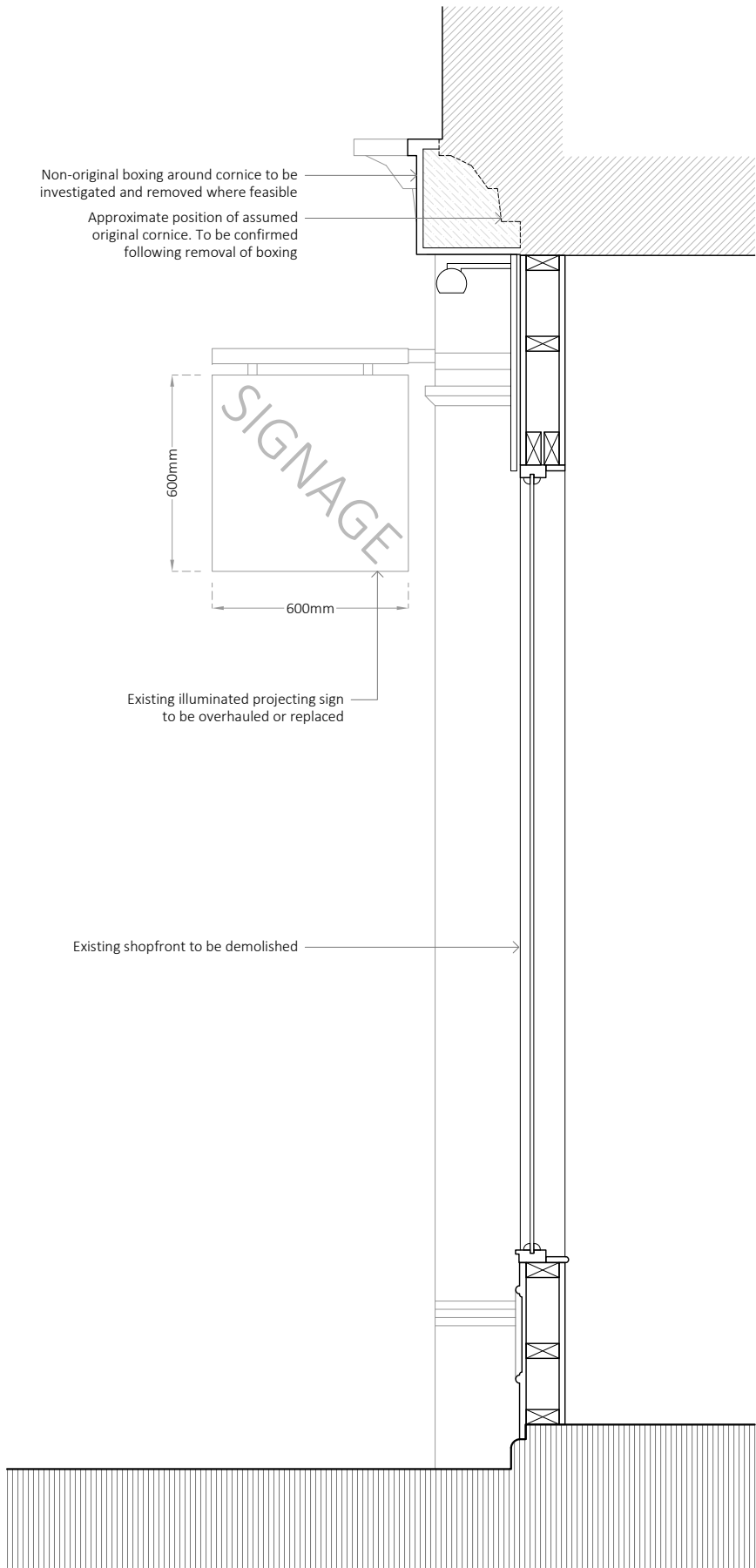

Section A

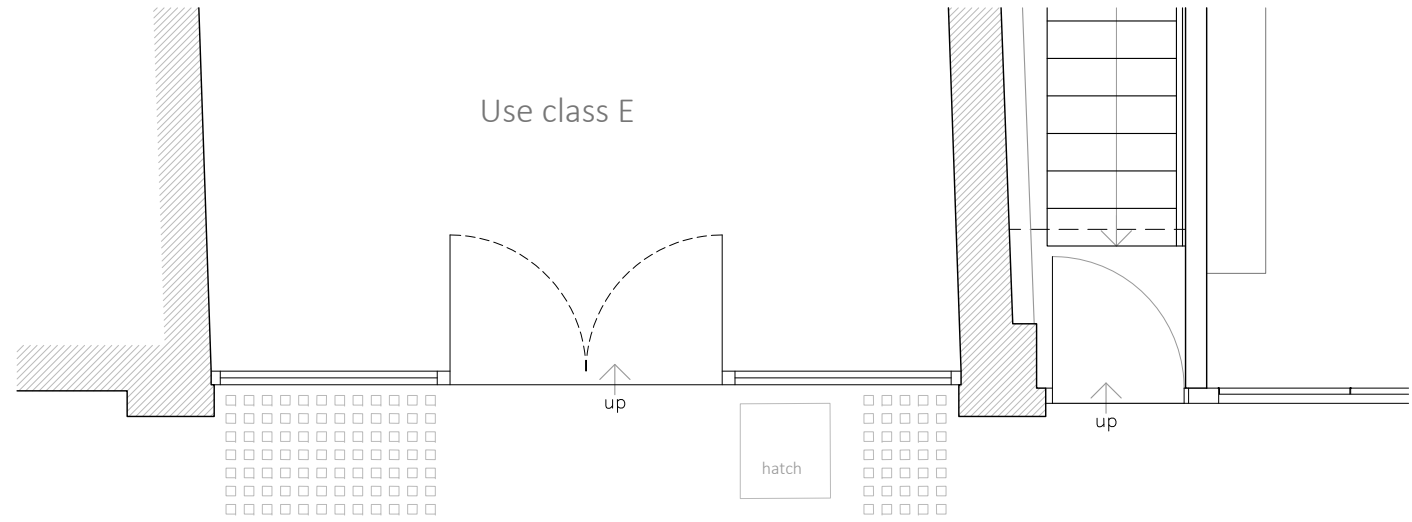

Ground Floor



Shopfront Elevation

P1	RJS	Initial Issue	14.12.2020
Rev	Iss.	Description	Date

DRAWING TITLE
Shopfront existing

PROJECT NAME
External alterations

ADDRESS
64 Goudge Street, London. W1

CLIENT
Shaftesbury Charlotte Street Ltd

DRAWN BY
RJS

CHECKED BY
RS

JOB NO.
25003

SCALE
1:50+1:20 @A3

DATE
Dec 2020

DRAWING NO.
A-300-P1



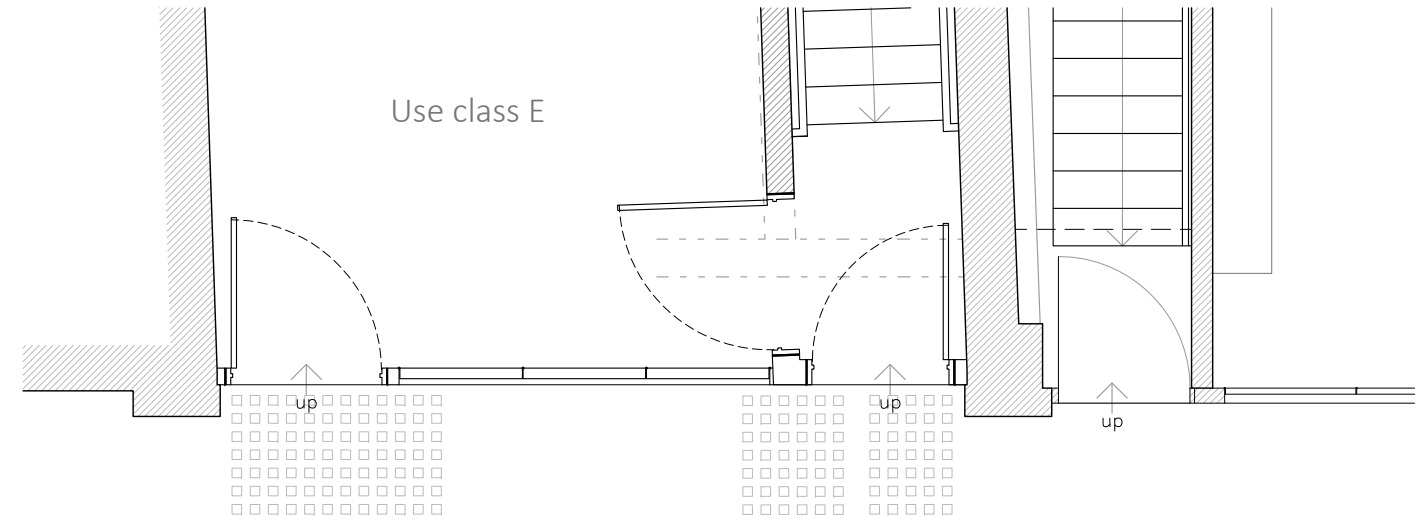

Ground Floor

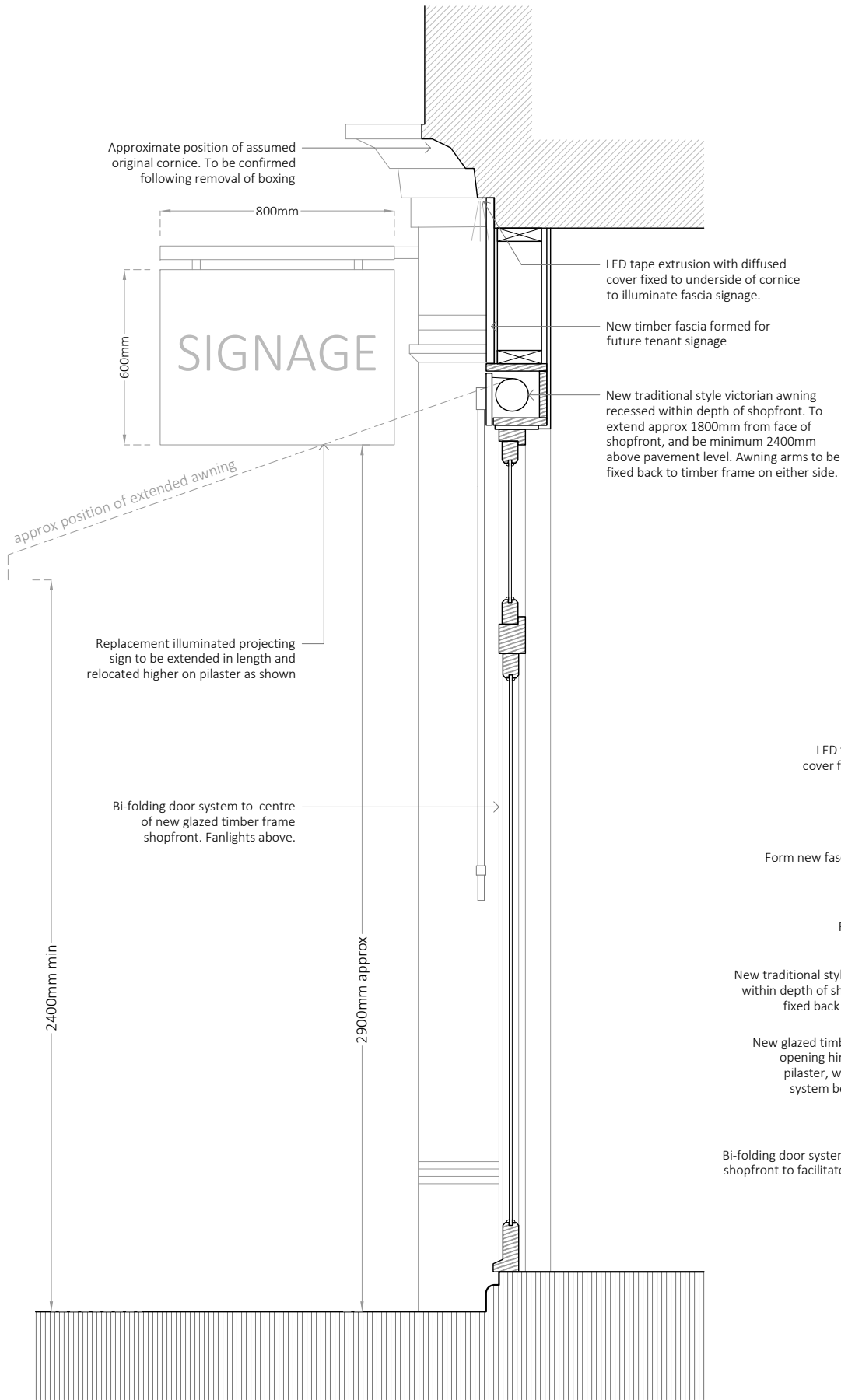
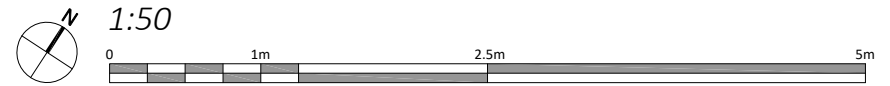

Section A



Shopfront Elevation

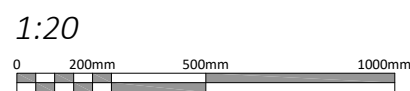

P1	RJS	Initial Issue	14.12.2020
Rev	Iss.	Description	Date

DRAWING TITLE
Shopfront proposed

PROJECT NAME
External alterations

ADDRESS
64 Goudge Street, London. W1

CLIENT
Shaftesbury Charlotte Street Ltd

DRAWN BY
RJS

CHECKED BY
RS

JOB NO.
25003

SCALE
1:50+1:20 @A3

DATE
Dec 2020

DRAWING NO.
A-400-P1

