

TOTTENHAM COURT ROAD

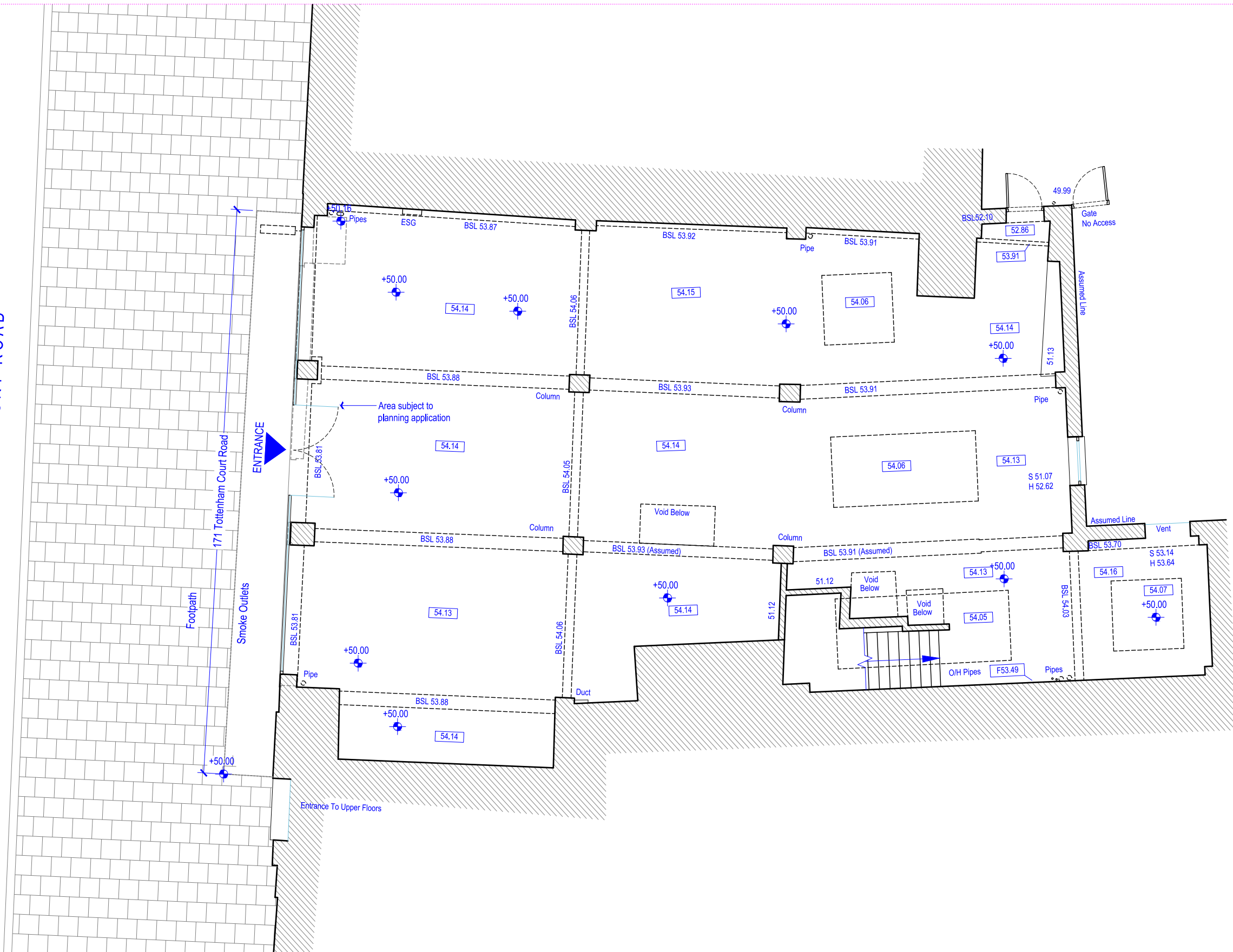

[01] Proposed Ground Floor Plan

1:100 @A3

NOTE:
DO NOT SCALE FROM DRAWINGS - EXCEPT FOR PLANNING PURPOSES.
ALL DISCREPANCIES TO BE REPORTED TO ARCHITECT IMMEDIATELY.
ALL DIMENSIONS TO BE VERIFIED BY CONTRACTOR ON SITE PRIOR TO THE COMMENCEMENT OF ANY WORKS.

P1 29/06/20 Planning Application Issue
P2 07/12/20 Window widths amended

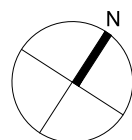
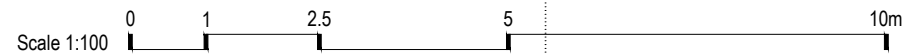

ISO-A3

VIVENDI ARCHITECTS LTD

Unit E3U, Bounds Green Industrial Estate, Ringway, London N11 2UD
Tel/Fax +44 (0)20 3232 4000 - email: info@vivendiarchitects.com

© VIVENDI ARCHITECTS LTD 2009
All rights reserved, including but not limited to The Copyright, Designs and Patents Act 1988

PROJECT TITLE:
171 Tottenham Court Road, W1T 7NS London

DRAWING TITLE:
Proposed Ground Floor Plan

CLIENT:

Lazari Properties 1 Ltd.

DRAWN:
RC

CHECKED:
GK

ISSUED BY:
GK

JOB AND DRAWING NO:

STATUS:
PLA

SCALE AT A3:
1:100

REVISION:
P2

1773-P02-00