

notes:

General notes:

1. Do not scale drawings. Dimensions govern.
2. All dimensions are in millimeters unless noted otherwise.
3. All dimensions shall be verified on site before proceeding with the work.
4. Square Feet Architects shall be notified in writing of any discrepancies.

Party Wall Act 1996:

Note: If the project progresses onto site without the involvement of Square Feet Architects the Client must seek advice prior to commencement of the planned works as detailed on the drawings to establish whether the works fall within the scope of the Act which required adjoining property owners to be served with a statutory notice.

C.D.M. Regulations 2015:

These drawings have been produced for the purpose of applying for Planning and Building Regulations only. If the project progresses on to site without the involvement of Square Feet Architects, the client and contractor must ensure that they fulfil the duties in respect of the construction (Design and Management) Regulations 1994. If advice is required please do not hesitate to contact Square Feet Architects.

revision:
* - 05.11.15 - Planning Submission
A - 11.01.16 - Revised Planning Drawings
B - 27.07.16 - Revised layout
C - 30.08.16 - Reissued to Planning
D - 30.01.20 - application for non-material amendment



SQUARE FEET ARCHITECTS

A : 95 Bell Street, London NW1 6TL
T : 0207 431 4500
E : studio@squarefeetarchitects.co.uk
W : www.squarefeetarchitects.co.uk

drawing title:

Lower Ground Floor

client:

Amirilan Management Limited

project:

Garages Rear 29/33 Arkwright Rd, London, NW3 6BJ

date:	scale:
September 2015	1:100@A3

drawing number:	revision:
1538-L021	D

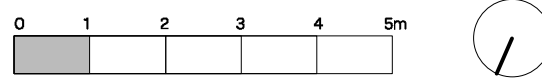

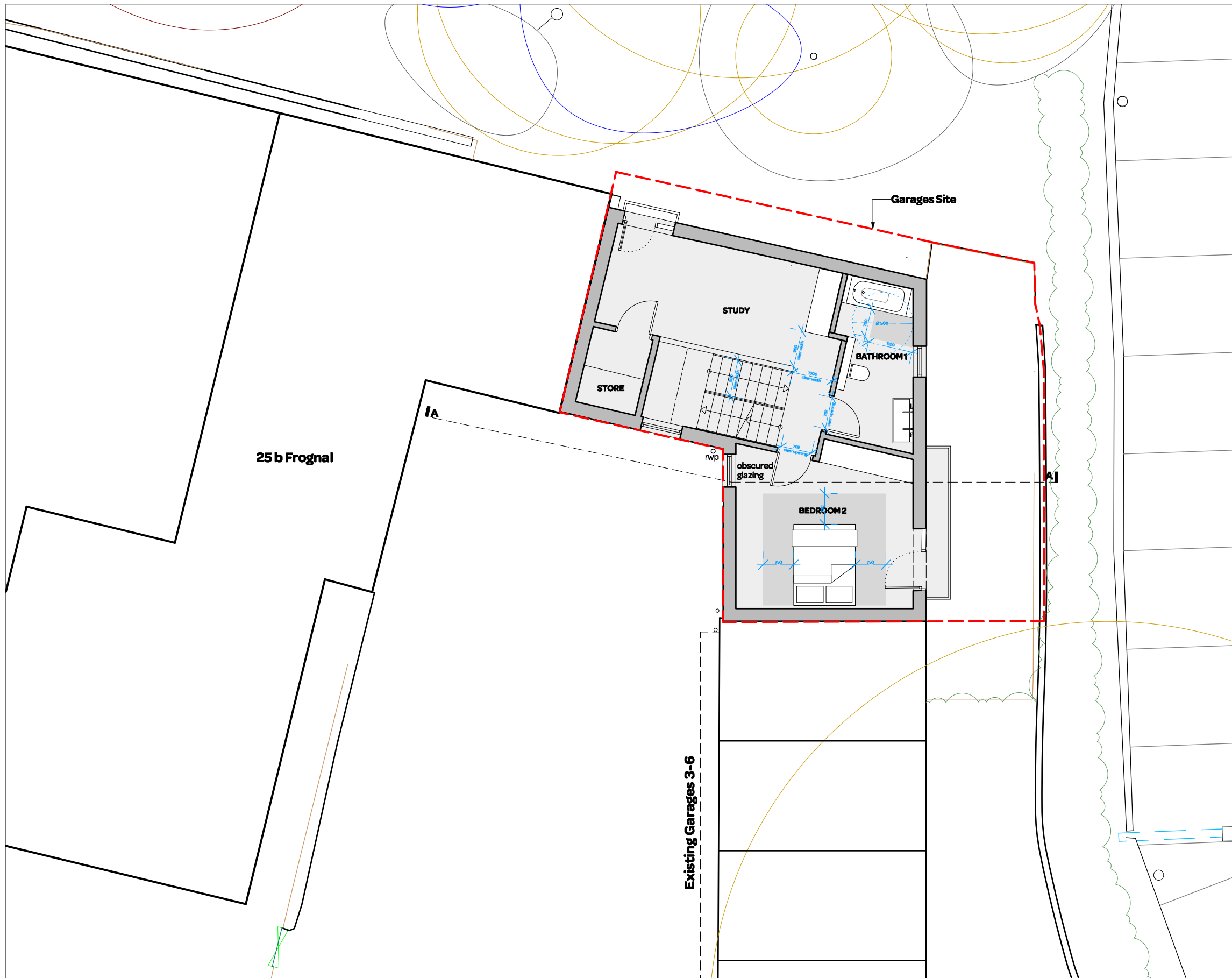

notes:

- General notes:**
1. Do not scale drawings. Dimensions govern.
 2. All dimensions are in millimeters unless noted otherwise.
 3. All dimensions shall be verified on site before proceeding with the work.
 4. Square Feet Architects shall be notified in writing of any discrepancies.

Party Wall Act 1996:
 Note: If the project progresses onto site without the involvement of Square Feet Architects the Client must seek advice prior to commencement of the planned works as detailed on the drawings to establish whether the works fall within the scope of the Act which required adjoining property owners to be served with a statutory notice.

C.D.M. Regulations 2015:
 These drawings have been produced for the purpose of applying for Planning and Building Regulations only. If the project progresses on to site without the involvement of Square Feet Architects, the client and contractor must ensure that they fulfil the duties in respect of the construction (Design and Management) Regulations 1994. If advice is required please do not hesitate to contact Square Feet Architects.

revision:
* - 05.11.15 - Planning Submission
A - 11.01.16 - Revised Planning Drawings
B - 27.07.16 - Revised layout
C - 30.08.16 - Reissued to Planning
D - 30.01.20 - application for non-material amendment



A : 95 Bell Street, London NW1 6TL
 T : 0207 431 4500
 E : studio@squarefeetarchitects.co.uk
 W : www.squarefeetarchitects.co.uk

drawing title:
Upper Ground Floor

client:
Amirilan Management Limited

project:
Garages Rear 29/33 Arkwright Rd, London, NW3 6BJ

date: September 2015	scale: 1:100@A3
-------------------------	--------------------

drawing number: 1538-L022	revision: D
-------------------------------------	----------------

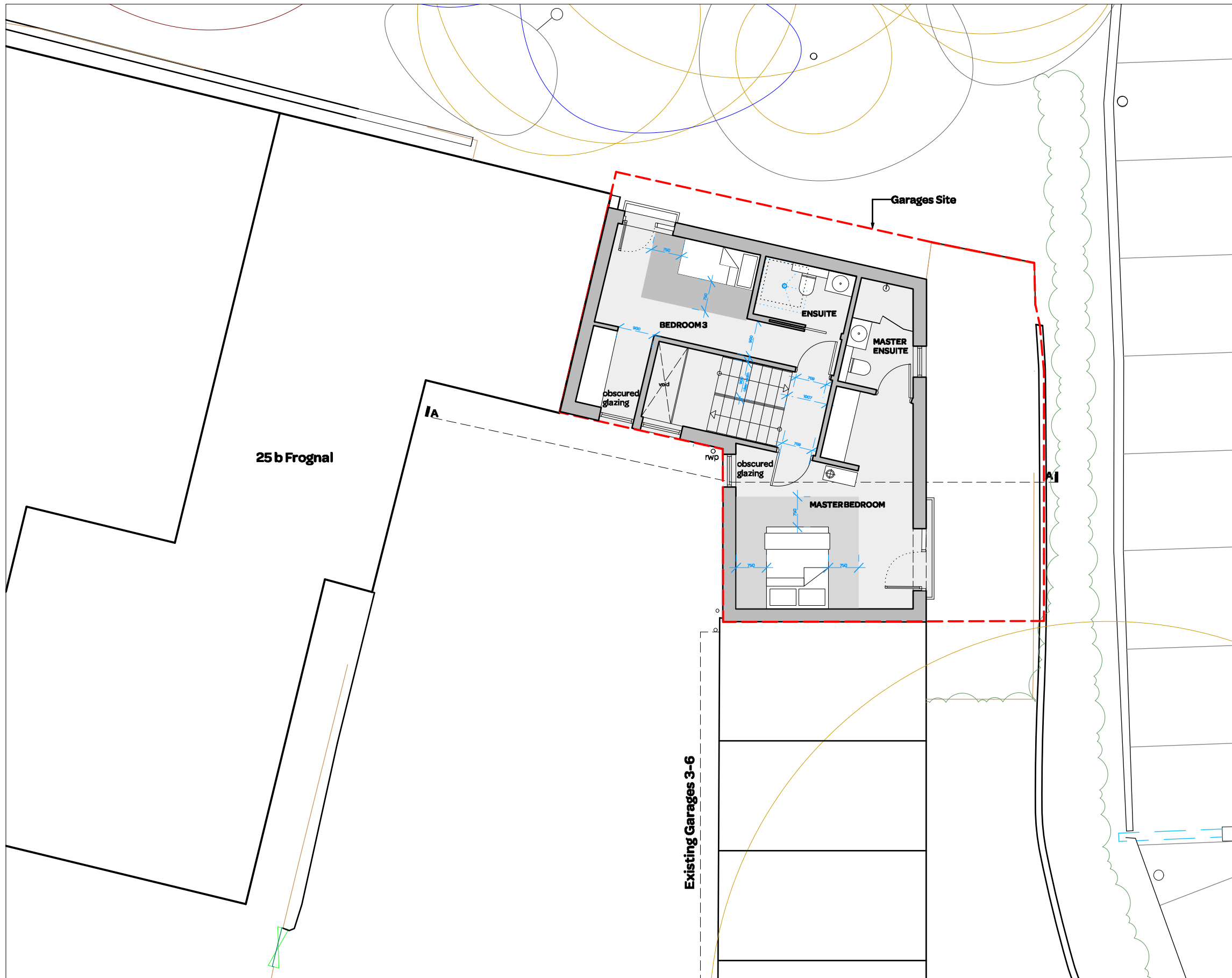

notes:

General notes:

1. Do not scale drawings. Dimensions govern.
2. All dimensions are in millimeters unless noted otherwise.
3. All dimensions shall be verified on site before proceeding with the work.
4. Square Feet Architects shall be notified in writing of any discrepancies.

Party Wall Act 1996:

Note: If the project progresses onto site without the involvement of Square Feet Architects the Client must seek advice prior to commencement of the planned works as detailed on the drawings to establish whether the works fall within the scope of the Act which required adjoining property owners to be served with a statutory notice.

C.D.M. Regulations 2015:

These drawings have been produced for the purpose of applying for Planning and Building Regulations only. If the project progresses on to site without the involvement of Square Feet Architects, the client and contractor must ensure that they fulfil the duties in respect of the construction (Design and Management) Regulations 1994. If advice is required please do not hesitate to contact Square Feet Architects.

revision:
* - 05.11.15 - Planning Submission
A - 11.01.16 - Revised Planning Drawings
B - 12.01.16 - Revised Planning Drawings
C - 27.07.16 - Revised layout
D - 30.08.16 - Reissued to Planning
E - 30.01.20 - application for non-material amendment



A : 95 Bell Street, London NW1 6TL
 T : 0207 431 4500
 E : studio@squarefeetarchitects.co.uk
 W : www.squarefeetarchitects.co.uk

drawing title:
First Floor

client:
Amirilan Management Limited

project:
Garages Rear 29/33 Arkwright Rd, London, NW3 6BJ

date: September 2015	scale: 1:100@A3
-------------------------	--------------------

drawing number: 1538-L023	revision: E
-------------------------------------	----------------