

These notes are based on the use of experienced and competent contractors carrying out the work using an approved safe method of working

**Key to Health and Safety Symbols**

- Indicates a residual risk requiring a compulsory action
- i Indicates a residual risk for information
- ⊘ Indicates a residual risk requiring a prohibitive action
- ⚠ Indicates a residual risk as a warning

Safety, Health and Environmental Information	
Notes below are additional to hazards/risks normally associated with this type of work. Numbers correspond to Risk Register references - see General Notes drawing for details.	
Construction	
<span style="color: yellow;">⚠</span> C01	Asbestos within existing platform structure
<span style="color: yellow;">⚠</span> C04	Services on platform wall and buried within platform
<span style="color: yellow;">⚠</span> C07	Damage/Stability of existing foundations
<span style="color: blue;">●</span> C07	Damage/Stability of existing foundations
Operations, Maintenance, No risk identified	
Dismantling / Demolition (Future) No risk identified	
Refer to general notes and the Principal Contractor for more information about the risks associated with this work.	

- Legend/Notes
- DO NOT SCALE FROM DRAWING, USE FIGURED DIMENSIONS ONLY.
  - ALL DIMENSIONS ARE IN MILLIMETRES AND LEVELS ARE IN METRES AOD.
  - DRAWING TO READ IN CONJUNCTION WITH:
    - 152319-MOS-DRG-ECV-070014 - PLATFORMS 2/3 DEMOLITION PLAN SUB-SURFACE
    - 152319-MOS-DRG-ECV-070015 - PLATFORMS 2/3 DEMOLITION PLAN SURFACE
    - 152319-MOS-DRG-ECV-070016 - PLATFORMS 2/3 DEMOLITION PLAN SURFACE
    - 152319-MOS-DRG-ECV-070036 - PLATFORMS 2/3 DEMOLITION SECTIONS
    - 152319-MOS-DRG-ECV-070102 - PLATFORMS 2/3 PROPOSED PLATFORM
    - 152319-MOS-DRG-ECV-070235 - PLATFORMS 2/3 PROPOSED SECTIONS
    - 152319-MOS-DRG-ECV-070236 - PLATFORMS 2/3 PROPOSED SECTIONS
  - THIS DESIGN HAS BEEN BASED UPON LDO 'KX MASTER FEDERATED MODEL TRACKER' AS EXPORTED ON 10/12/19
  - PLEASE REFER TO PROPOSED PLATFORM DRAWINGS (SEE NOTE 3) FOR CLEARANCE DIMENSIONS AND LEVELS OF PROPOSED DESIGN.

**KEY :**

- TOP OF EXCAVATION
- EXISTING FILL TO REMAIN

**COLOUR CONVENTIONS**

- BLACK - EXISTING OR UNCHANGED
- BLUE - MODIFIED OR TO BE MOVED
- GREEN - REDUNDANT OR TO BE REMOVED
- RED - PROPOSED OR ADDITIONAL
- PURPLE - WORKS BY OTHERS
- ORANGE - FUTURE WORKS
- CYAN - TEMPORARY WORKS

Rev	Date	Description of Revisions	Drawn	Chkd	Appr
P01.7	11/11/19	Issued For F003	JE	CS	---
B01	12/11/19	Issued For F003	JE	CS	HS
P02.1	17/12/19	Issued for Construction	MP	HH	---
C01	18/12/19	Issued for Construction	MP	HH	HS

Status: **Accepted for Stage 6** Suitability: **A6**



Authorised: I. Carter Signed: IC Date: 18/12/19

Contractor(s): **Morgan Sindall Plc**

Location/Level: No Specific Location

Type: CAD Drawing Sub-type: General Arrangement

Role: Civil Engineer Discipline: Civils

Volume/System: No Specific Volume or System

Phasing: To be Removed Grip Stage: 6

Project: **Kings Cross Remodelling**

Contract No.:

Contract Title:

Drawing Title:

**King's Cross Station  
Platform Extension and Modification  
Existing Platform 2/3  
Demolition Section A-A & B-B**

Designed	Signed	Date
Drawn: M.PAGE	Signed: MP	Date: 17/12/19
Checked: H.HO	Signed: HH	Date: 17/12/19
Approved: H.SIMPSON	Signed: HS	Date: 17/12/19

Scale(s): 1:25 ELR & Mileage: ECM1 to 0m 353yds

Alternative Reference: Sheet 1 of 2

Drawing Number: 152319-MOS-DRG-ECV-070035 Revision: C01

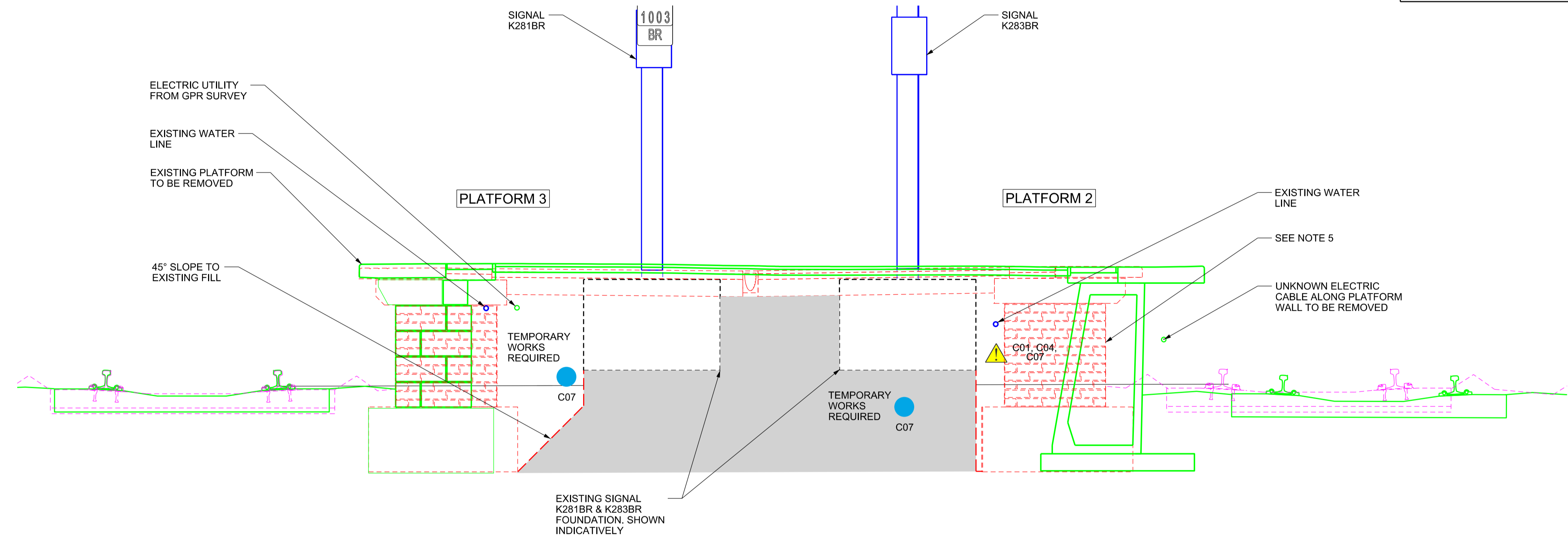

**EXISTING PLATFORMS 2 & 3 SECTION A-A**  
P3 CH +225.000  
SCALE 1 : 25

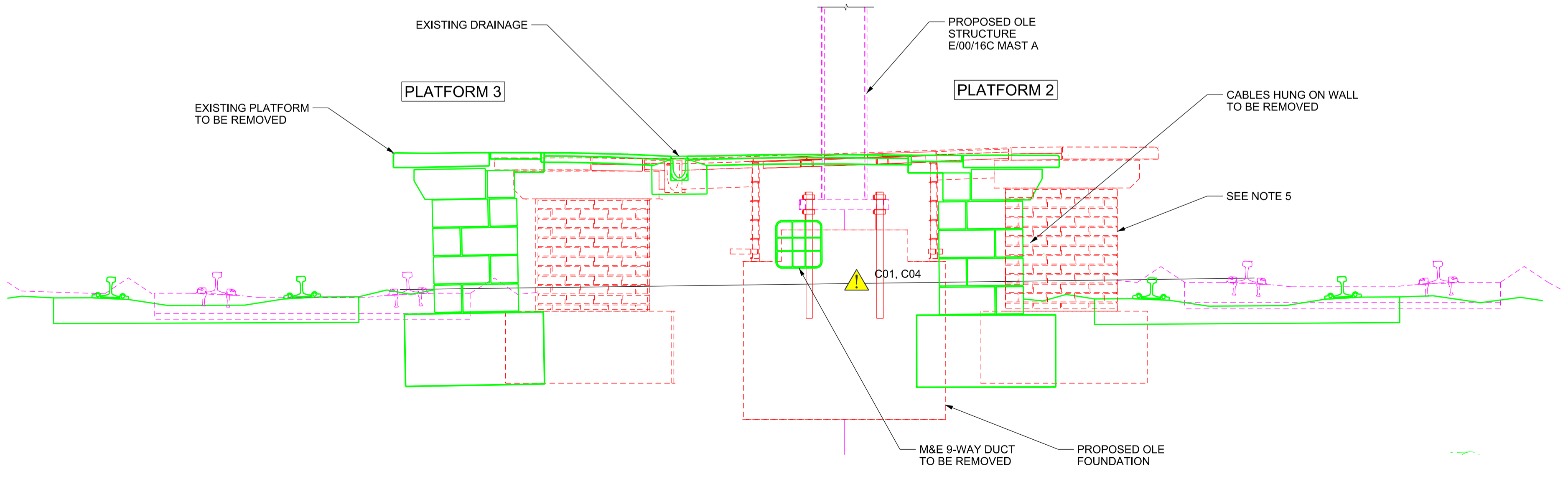

**EXISTING PLATFORMS 2 & 3 SECTION B-B**  
P3 CH +284.000  
SCALE 1 : 25

APPROVED FOR CONSTRUCTION  
SIGNED: *[Signature]*  
NAME: IAN CARTER  
DATE: 18/12/2019  
CONTRACTOR'S ENGINEERING MANAGER

