

KEY PLAN
NOT TO SCALE

Safety, Health and Environmental Information

Notes below are additional to hazards/risks normally associated with this type of work. Numbers correspond to Risk Register references - see General Notes drawing for details.

Construction	
⚠ C01	Asbestos within existing platform structure
⚠ C04	Services on platform wall and buried within platform
⚠ C06	Failure of re-used coper stones
Operations, Maintenance	
⚠ OM7	Existing platform cross falls to remain non-compliant or made worse by proposed works
⚠ OM9	Existing refuge areas insufficient and access difficult
⚠ OM10	Refuge areas where coper modifications are proposed are non-compliant (less than 300mm)
⚠ OM16	New/Modified copers cannot support 10kN vehicle load
Dismantling / Demolition (Future)	
No risk identified	

Refer to general notes and the Principal Contractor for more information about the risks associated with this work.

These notes are based on the use of experienced and competent contractors carrying out the work using an approved safe method of working

Key to Health and Safety Symbols

- ⓘ Indicates a residual risk for information
- ⚠ Indicates a residual risk requiring a prohibitive action
- ⚠ Indicates a residual risk as a warning

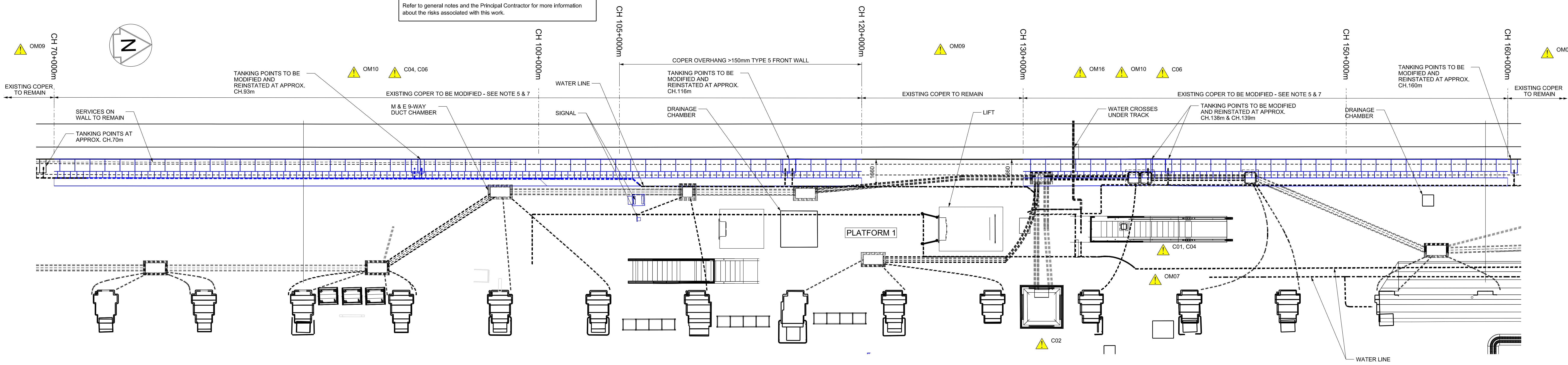

EXISTING PLATFORMS 0 & 1 GENERAL ARRANGEMENT AND DEMOLITION PLAN
(CHAINAGE 70+000 TO 160+000)
SCALE 1:100

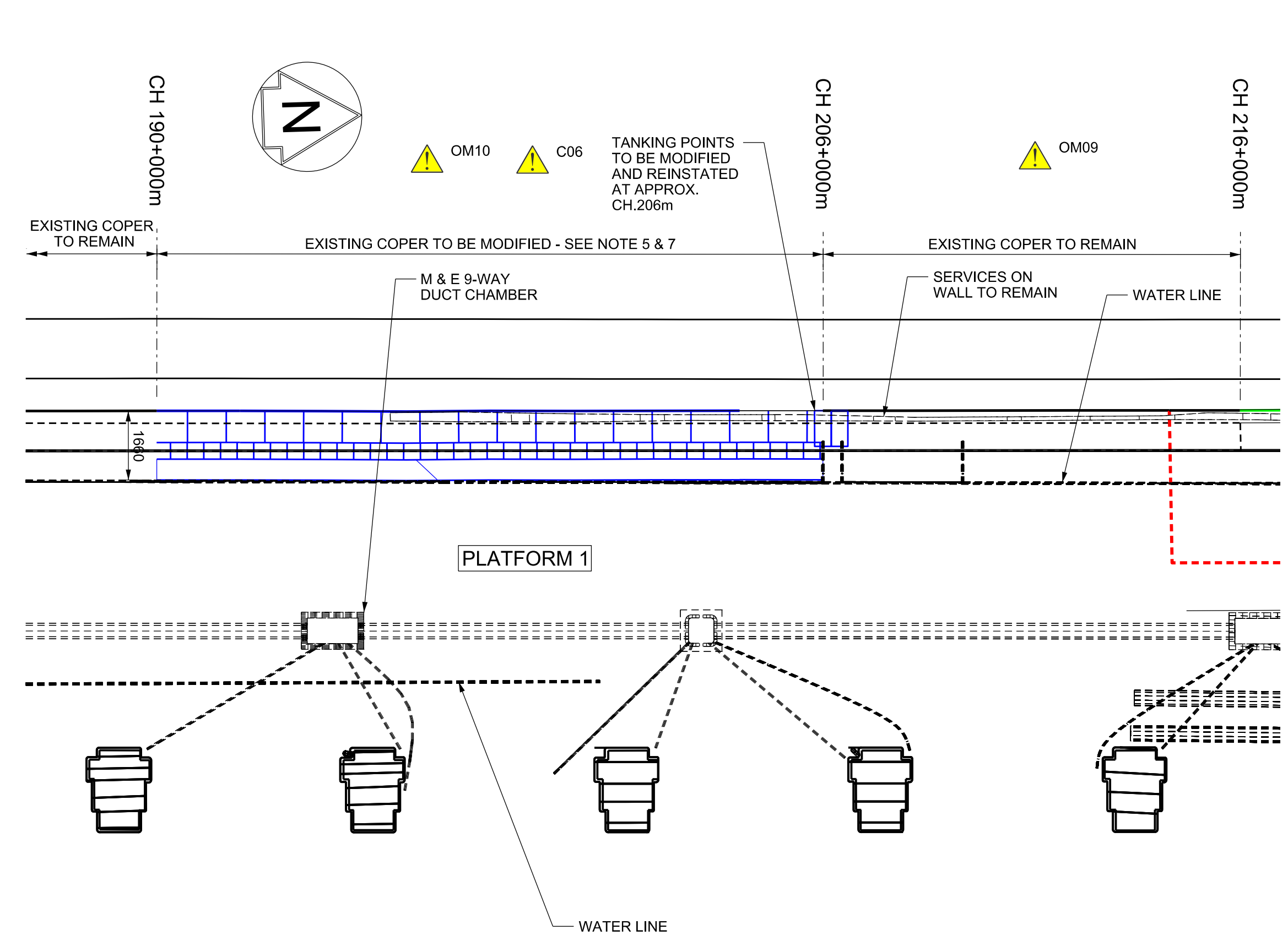

EXISTING PLATFORMS 0 & 1 GENERAL ARRANGEMENT AND DEMOLITION PLAN
(CHAINAGE 190+000 TO 206+000)
SCALE 1:100

- Legend/Notes
- DO NOT SCALE FROM DRAWING. USE FIGURED DIMENSIONS ONLY.
 - ALL DIMENSIONS ARE IN MILLIMETRES AND LEVELS ARE IN METRES AOD.
 - DRAWING TO READ IN CONJUNCTION WITH:
 - 152319-MOS-DRG-ECV-070011 - PLATFORMS 0/1 DEMOLITION PLAN SUBSURFACE
 - 152319-MOS-DRG-ECV-070012 - PLATFORMS 0/1 DEMOLITION PLAN SURFACE
 - 152319-MOS-DRG-ECV-070030 - PLATFORMS 0/1 DEMOLITION SECTIONS
 - 152319-MOS-DRG-ECV-070101 - PLATFORMS 0/1 PROPOSED PLATFORM
 - 152319-MOS-DRG-ECV-070230 - PLATFORMS 0/1 PROPOSED SECTIONS
 - 152319-MOS-DRG-ECV-070231 - PLATFORMS 0/1 PROPOSED SECTIONS
 - 152319-MOS-DRG-ECV-070232 - PLATFORMS 0/1 PROPOSED SECTIONS
 - 152319-MOS-DRG-ECV-070401 - PROPOSED DETAILS SHEET 1
 - 152319-MOS-DRG-ECV-070410 - PROPOSED DETAILS SHEET 3
 - PROPOSED (DESIGN) CHAINAGES SHOWN ON DRAWING
 - COPERS ARE TO BE CHECKED FOR DAMAGE PRIOR TO RE-USE. CRACKED OR CHIPPED COPERS ARE NOT TO BE RE-USED.
 - THIS DESIGN HAS BEEN BASED UPON LDO 'XX' MASTER FEDERATED MODEL TRACKER AS EXPORTED ON 04/03/19
 - CONDITION OF EXISTING WALL TO BE ASSESSED FOR RE-USE.
 - WHERE COPER HANG >150mm PLATFORM FRONT WALL IS TO BE MODIFIED, REFER TO DRAWING 152319-MOS-DRG-ECV-070401 & 070410.

KEY :

- ▨ PLATFORM SURFACE TO BE TIED IN

CLOUR CONVENTIONS

- BLACK - EXISTING OR UNCHANGED
- BLUE - MODIFIED OR TO BE SAVED
- GREEN - REDUNDANT OR TO BE REMOVED
- RED - PROPOSED OR ADDITIONAL
- PURPLE - WORKS BY OTHERS
- ORANGE - FUTURE WORKS
- CYAN - TEMPORARY WORKS

Rev	Date	Description of Revisions	Drawn	Check	Appr	Submittal
PO2.1	17/12/18	Issued for Construction	MP	HH	HS	
CO1	18/12/18	Issued for Construction	MP	HH	HS	
PO3.1	11/03/20	Issued for Construction	JE	HH	HS	
C02	13/03/20	Issued for Construction	JE	HH	HS	

Accepted for Stage 6 **A6**



Authorised	I.CARTER	Signed	IC	Date	13/03/20
Contractor(s) Morgan Sindall Plc					
Location/Level	No Specific Location				
Type	CAD Drawing	Subtype	Plan		
Role	Civil Engineer	Discipline	Civils		
Volume/System	No Specific Volume or System				
Phasing	To be Removed	Grip Stage	6		

Project
Kings Cross Remodelling

Contract No.

Contract Title

Drawing Title
King's Cross Station
Platform Extension and Modification
Existing Platform 0/1
Demolition Plan - Surface 2 of 2

Designed	Signed	Date
Drawn J.ELLIS	Signed JE	Date 11/03/20
Checked H.HO	Signed HH	Date 11/03/20
Approved H.SIMPSON	Signed HS	Date 11/03/20

Scale(s)
1:100

Alternative Reference
L118008

Drawing Number
152319-MOS-DRG-ECV-070013

Sheet Size A1+3284 x 1471

