

**DOOR TYPE 01:**  
HARDWOOD FRAME DOOR  
- DOUBLE GLAZED  
- ALL GLAZING TO TO BE SPECIFIED TO ACHIEVE  
A THERMAL RESISTANCE OF MIN. 1.60W/m2K.

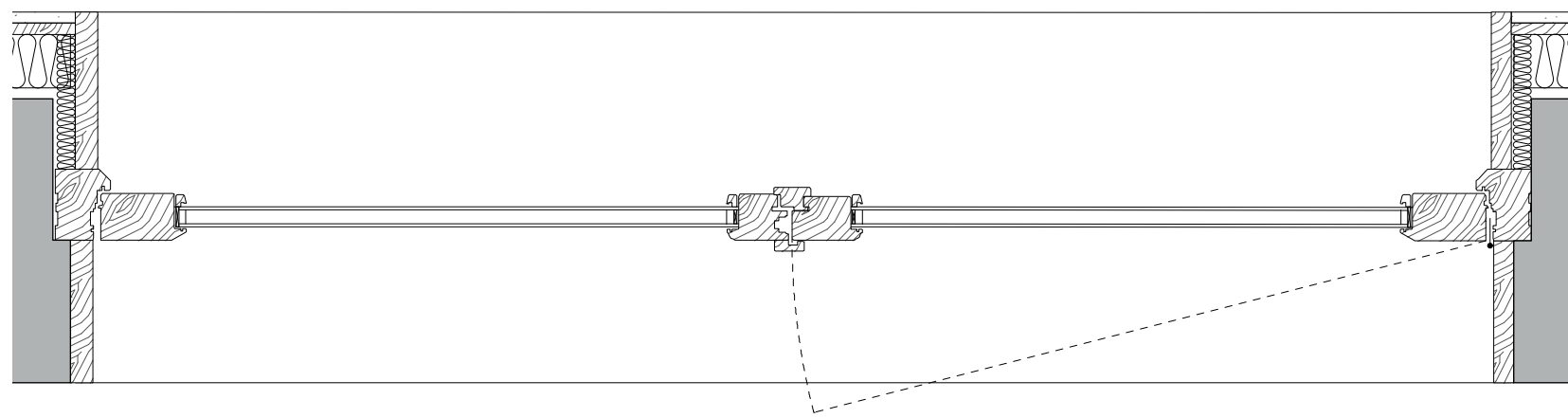
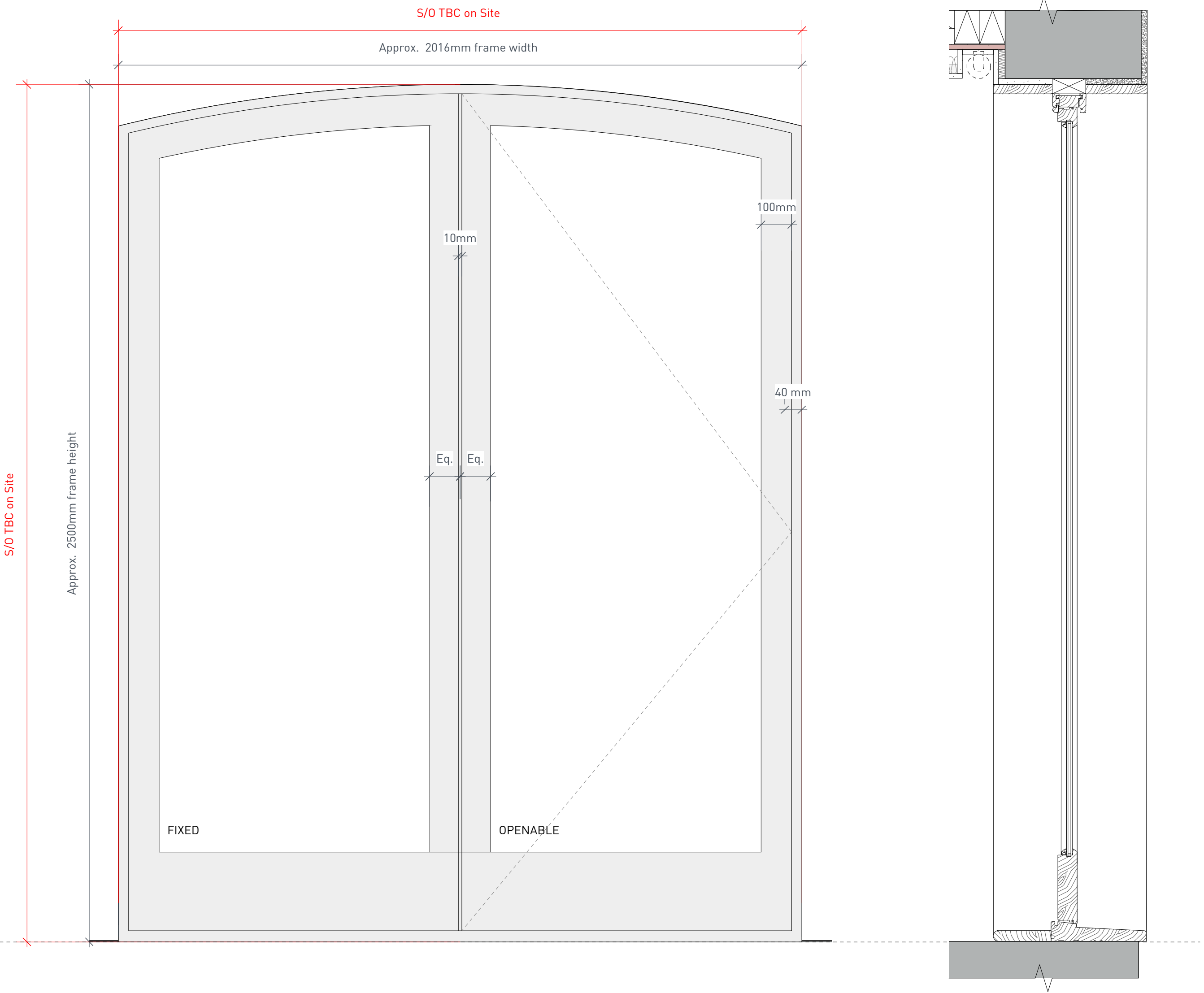

**WINDOW TYPE 07:**  
HARWOOD FRAME WINDOWS WITH INTEGRATED WINDOW RESTRICTORS  
ONE OPENABLE, ONE FIXED  
- DOUBLE GLAZED  
- ALL GLAZING TO TO BE SPECIFIED TO ACHIEVE  
A THERMAL RESISTANCE OF MIN. 1.60W/m2K.