

**WINDOW TYPE 03:**  
REPLACEMENT SINGLE CASEMENT, TOP HUNG  
OPENABLE  
- HERITAGE STYLE DOUBLE GLAZED  
- ALL GLAZING TO TO BE SPECIFIED TO ACHIEVE  
A THERMAL RESISTANCE OF MIN. 1.60W/m2K.

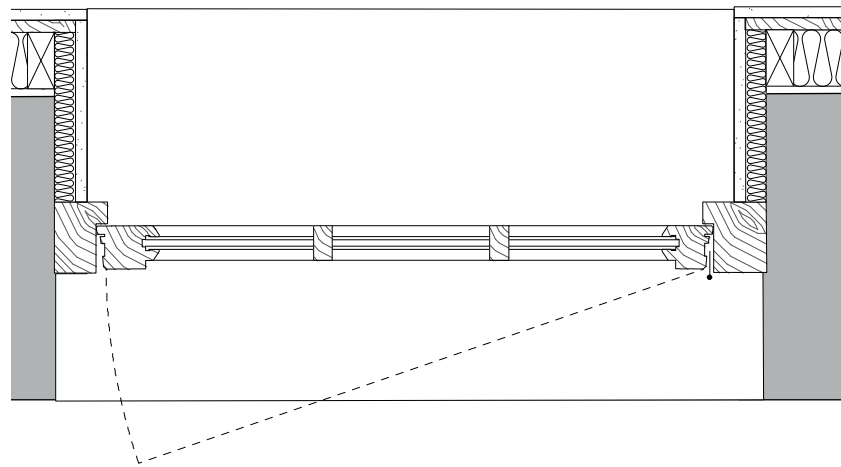

**WINDOW TYPE 06:**  
REPLACEMENT SINGLE CASEMENT TOP AND SIDE HUNG  
OPENABLE  
- HERITAGE STYLE DOUBLE GLAZED  
- ALL GLAZING TO TO BE SPECIFIED TO ACHIEVE  
A THERMAL RESISTANCE OF MIN. 1.60W/m2K.