

2

25A COLLEGE CRESCENT
LONDON NW3 5LH

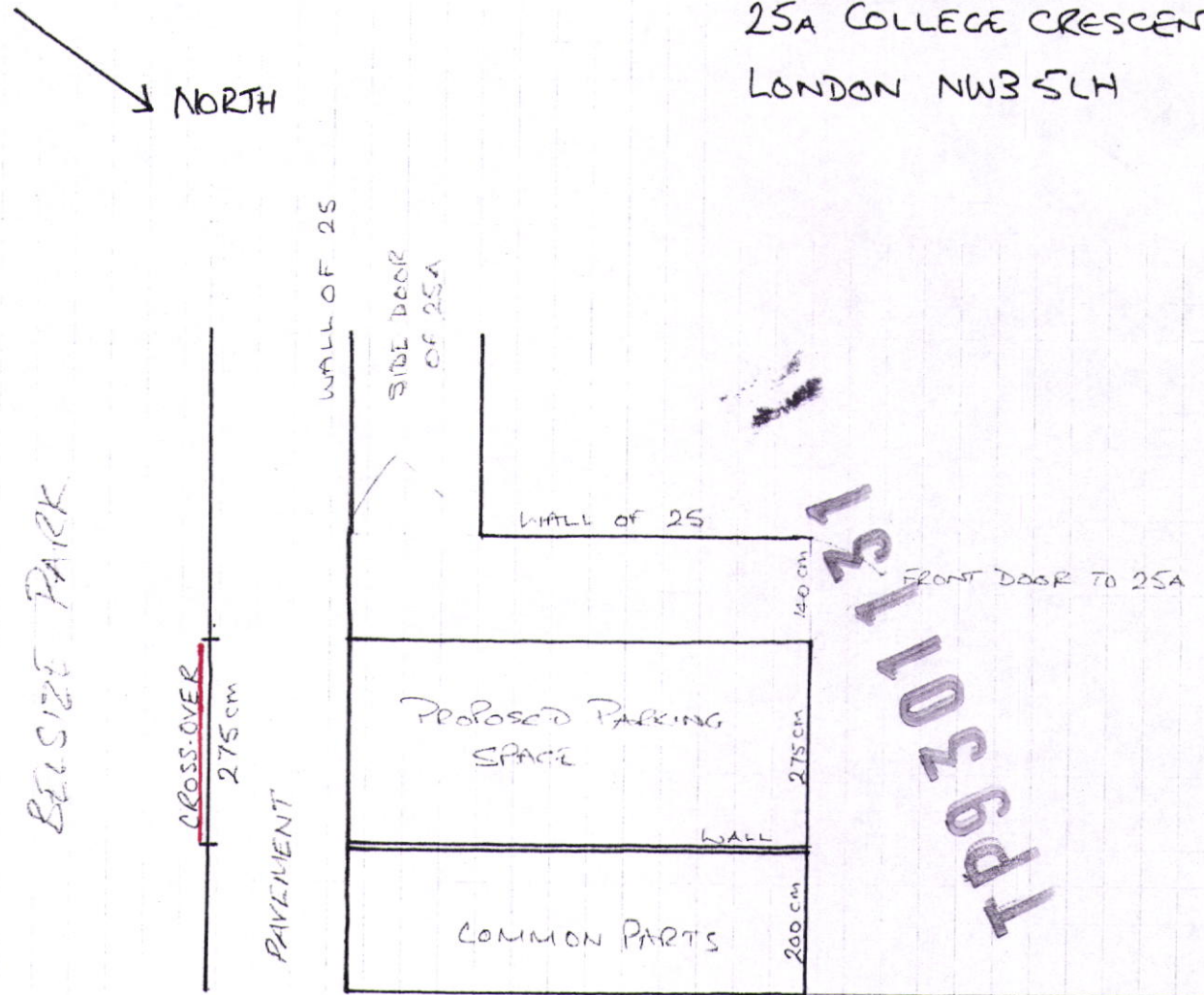

PROPOSED PARKING SPACE 275 cm x 625 cm

DRAWN FROM SURVEY (PERSONAL)

* WE ARE APPLYING FOR OFF-STREET PARKING
REQUIRING A CROSS-OVER (NO OTHER ENGINEERING
WILL BE NEEDED)

SCALE 1cm : 1m