

Rainwater outlet from new flat roof through parapet discharging to hopper and downpipe.

Overflow outlet from new flat roof through parapet with free-fall discharge into lightwell below.

Lowered Parapet As Per Details Previously Submitted and Agreed

Please Refer To Attached Planting Schedule For Detail

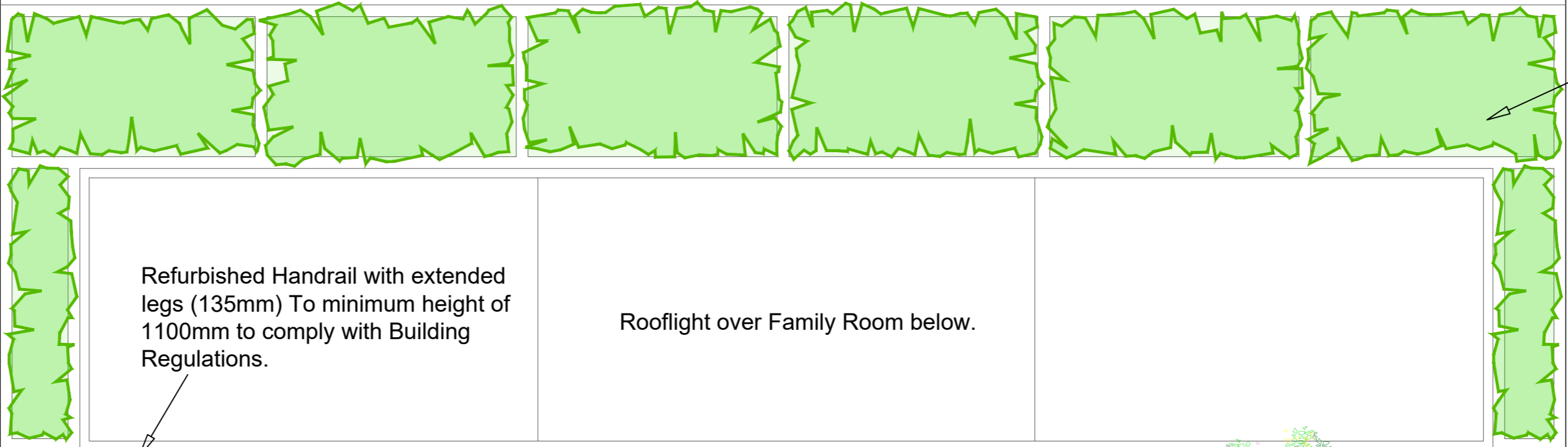

Refurbished Handrail with extended legs (135mm) To minimum height of 1100mm to comply with Building Regulations.

Rooflight over Family Room below.

Existing RWP to swan-neck over and discharge onto flat roof of extension.

New external SVP route.

TERRACE

New full height window opening. Refer To IDSystems

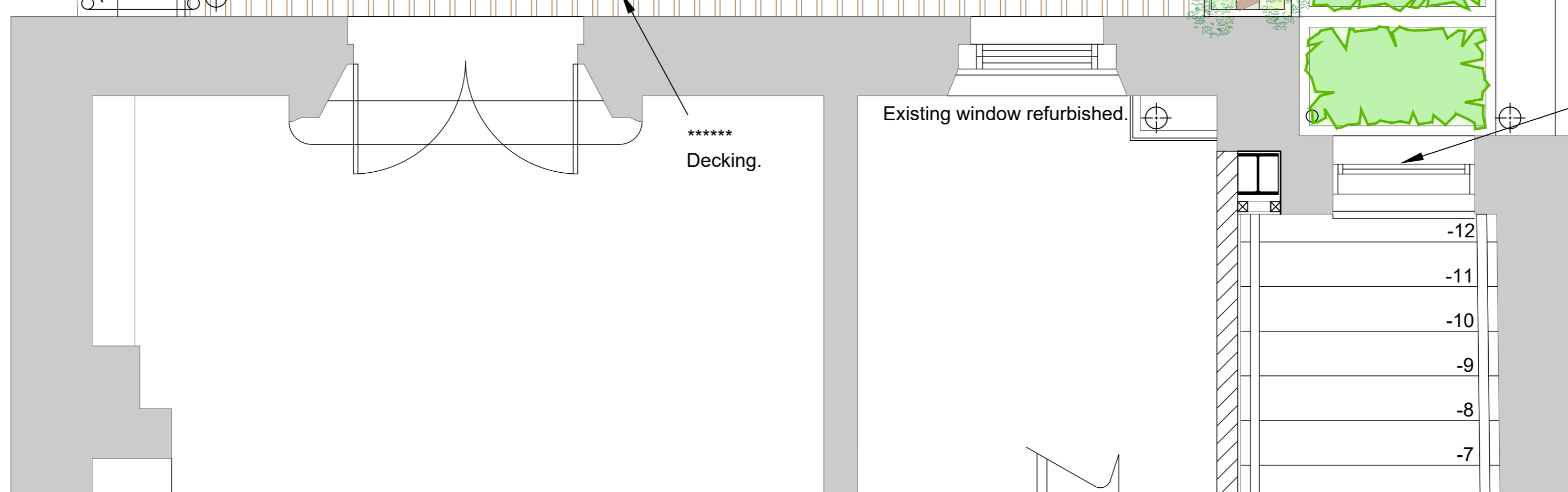

Existing window refurbished.

Decking.

-12
-11
-10
-9
-8
-7

L	Date	Description
Revisions		
Project: 31 St Marks Crescent, London		North:
Drawing Title: Rear Extension Details		Farrell Design Studio
Client: Mr N. Beard	Created: 12-2020	f
Drawing Number: 1114-S02	Drawn By: JHF	