

01 General Arrangement - Existing Plan  
1:200 @ A1

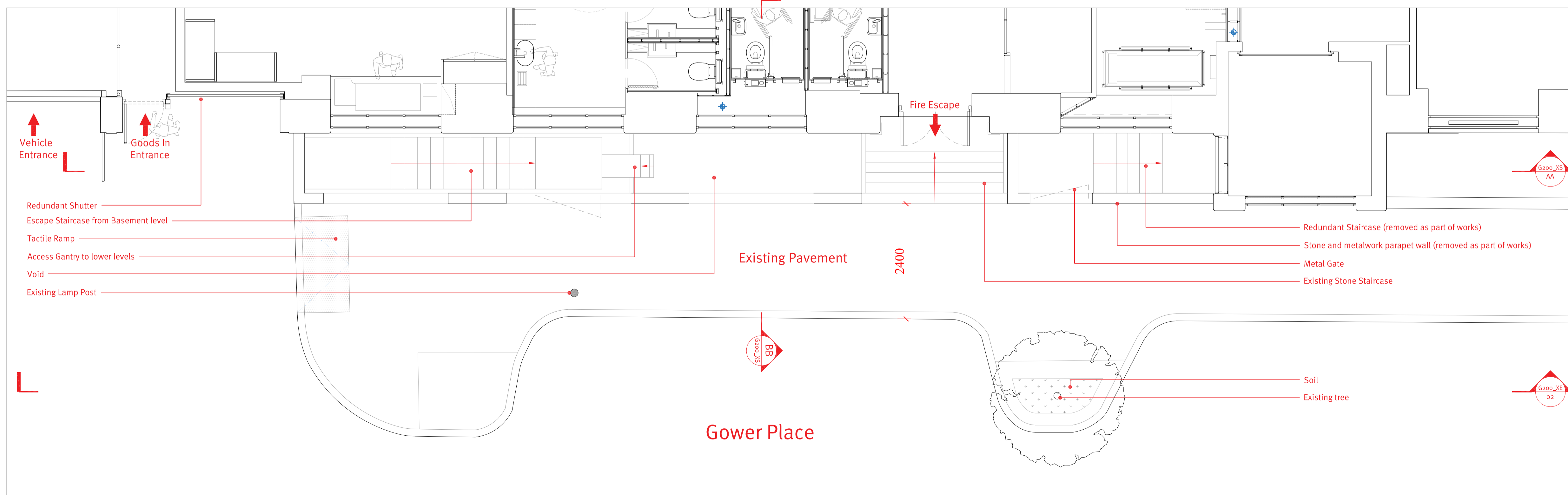

02 Existing Detail Plan  
1:50 @ A1

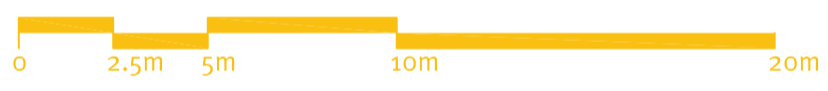

# Existing

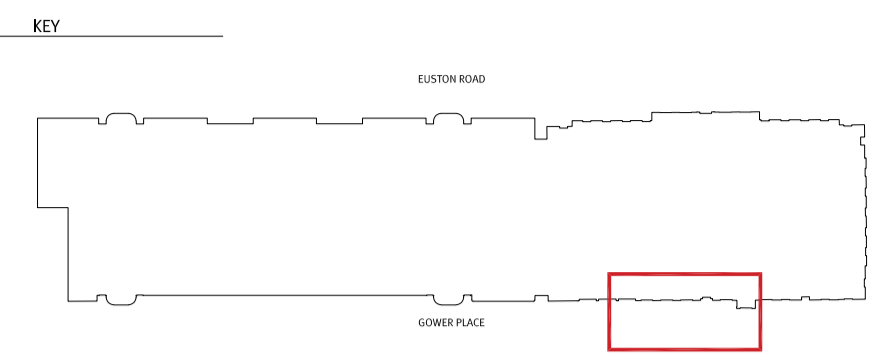

**DISCLAIMER:**  
This drawings is based on CAD drawings from a third party, as such 3|10 Studio cannot guarantee its accuracy.  
Do not scale dimensions off drawings. Use written or calculated dimensions. The contractor is responsible for checking dimensions before ordering or starting work.  
This document contains confidential and proprietary information that cannot be reproduced or divulged, in whole or in part, without written authorisation from 3|10 studio ltd.  
DRAWINGS NOT FOR CONSTRUCTION PURPOSES

**KEY**  
Boundary - Extent of site proposed works

REV	DATE	COMMENT
P	17.07.2020	Planning Application Issue
P1	04.01.2020	Additional existing detail added to plan (lamppost, signposts etc)

**STATUS:** Planning Application Submission

DATE:	DRAWING TITLE:	SCALE:
06.07.2020	General Arrangement Existing plan	Varies

PROJECT NAME:	DRAWING NUMBER	REVISION
Wellcome Collection 183 Euston Road Gower Place Accessible Ramp	Lo67_A_G200_XP	P1

CLIENT:  
The Wellcome Trust  
215 Euston Road  
London  
NW1 2BE

**3|10 studio**  
architecture

Brightbow Workspace  
62 Bedminster Parade  
Bristol  
BS3 4HL  
TEL 0117 223 0078  
info@310studio.co.uk  
www.310studio.co.uk