

01 General Arrangement - Proposed Plan  
1:200 @ A1

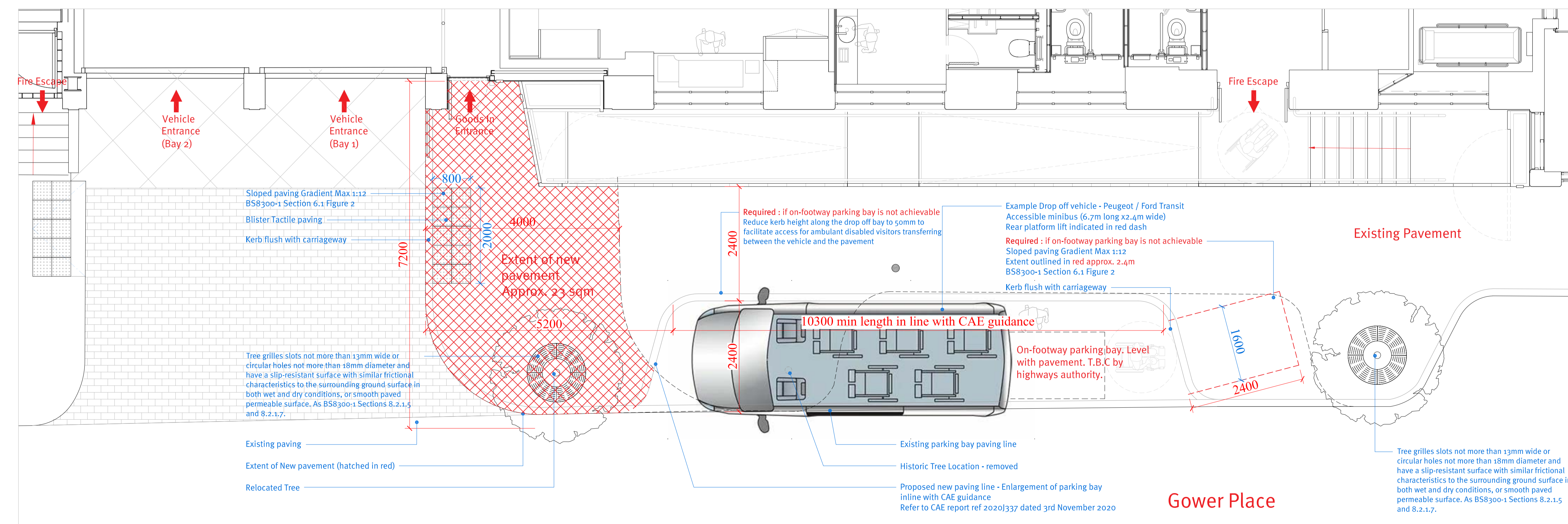

02 Proposed Detail Plan  
1:50 @ A1

# Proposed

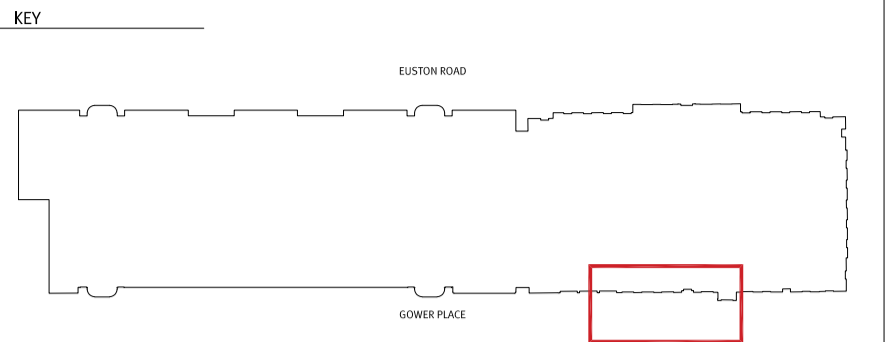

**DISCLAIMER:**  
This drawings is based on CAD drawings from a third party, as such 3|10 Studio cannot guarantee its accuracy.  
Do not scale dimensions off drawings. Use written or calculated dimensions. The contractor is responsible for checking dimensions before ordering or starting work.  
This document contains confidential and proprietary information that cannot be reproduced or divulged, in whole or in part, without written authorisation from 3|10 studio Ltd.  
DRAWINGS NOT FOR CONSTRUCTION PURPOSES



Example of drop off Vehicle - Peugeot minibus



Streetview of existing loading bay entrance

REV	DATE	COMMENT
P	13.11.2020	Planning Application Issue
P1	24.11.2020	Additional Information as requested by Camden Council Incorporation of CAE guidance on drop off bay.
P2	04.01.2020	Parking bay changed to On-footway bay inline with planners comments. Additional existing detail added to plan (lamppost, signposts etc)

**STATUS:** Information

DATE:	DRAWING TITLE:	SCALE:
18.11.2020	General Arrangement Proposed plan Pavement and Drop off Bay	Varies

PROJECT NAME:	DRAWING NUMBER	REVISION
Wellcome Collection 183 Euston Road Gower Place Accessible Ramp	Lo67_A_G200_P_01	P2

**CLIENT:**  
The Wellcome Trust  
215 Euston Road  
London  
NW1 2BE

**3|10 studio**  
architecture

Brightbowl Workspace  
62 Bedminster Parade  
Bristol  
BS3 4HL

TEL 0117 223 0078  
info@310studio.co.uk  
www.310studio.co.uk

**RIBA** Chartered Practice