

Existing Gate

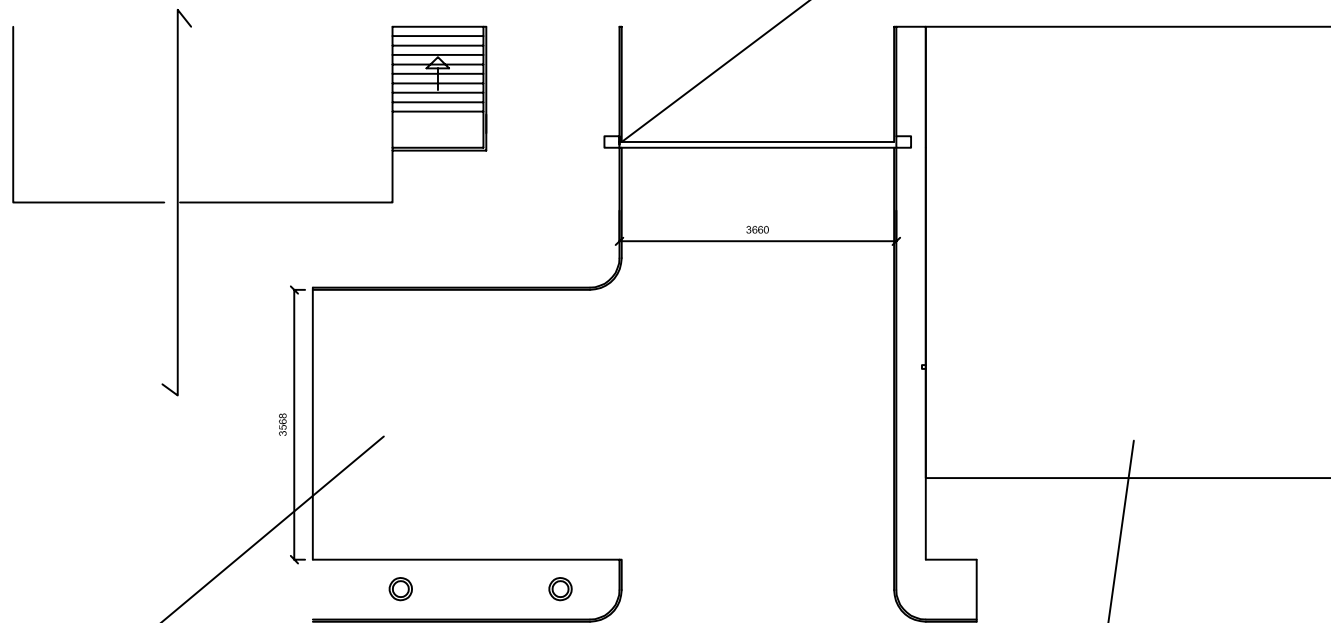

Car Parking Spaces

Adjacent building

Existing Side Hung Gate: Material- Steel, Finish: Painted- Grey

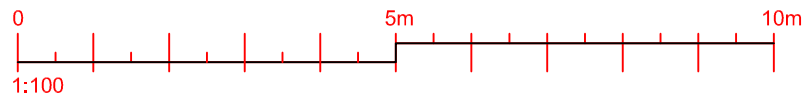

© Mayor's Office for Policing and Crime 2018

**METROPOLITAN POLICE SERVICE
COMMERCIAL & FINANCE
PROPERTY SERVICES DIRECTORATE**

11TH FLOOR,
EMPRESS STATE BUILDING,
EMPRESS APPROACH,
LILLIE ROAD, LONDON, SW6 1TR

REV.	DESCRIPTION	DATE

DRAWING PURPOSE:
PLANNING

PROTECTIVE MARKING:
OFFICIAL

DRAWING STATUS:	INITIAL NON CONTRACTUAL CODE	SUITABILITY:	S0
-----------------	------------------------------	--------------	----

GENERAL NOTES:
N/A

FOIA PUBLICATION: No

DRAWING TITLE:
Existing Plan

SITE NAME:
POLICE SITE KENTISH TOWN

BUILDING / PROJECT NAME:
GATE RENEWAL SCHEME

SITE ADDRESS:
**10-12A Holmes Rd, Kentish
Town, London**

POSTCODE: NWS 3AE

BOROUGH:

COORDINATES: E: N/A N: N/A

SITE / ULR NO: **0486** UNIT NO: **01**

DATE PUBLISHED: 17/06/2020 REVIEW DATE: 18/06/2020

OCU / BRANCH: TBC SCALE (Ø A2): 1:100

DRAWN: MW CHECKED: ID APPROVED:

DATE: 17/06/2020 DATE: 18/06/2020 DATE:

AUTHOR: BAILY GARNER

WBS NO:

DRAWING NUMBER: **048601-BG-S4-XX-DR-B-0001** REV / VER: **P05.01**