

Key Materials:

- ① Existing cast iron railings
- ② Existing railings replaced to replicate the original design and detailing and comprise the same materials as the original features
- ③ Existing plinth below proposed gate to be removed
- ④ Existing decorative wall strut/tie to be retained
- ⑤ Proposed stairs to be black painted steel with open pattern on treads
- ⑥ Proposed lockable vertical pattern timber boarding door

Key of elements:

- Existing
- Proposed

1:50

A3



General Notes:

1. Copyright of this drawing remains the sole property of Cooley Architects unless otherwise assigned in writing.
2. Figured dimensions are to be worked in all cases with any discrepancies reported to the Architect prior to commencement of any work.
3. Setting-out is based on outline survey only. All dimensions to be checked on site prior to construction/ordering.
4. All dimensions are to edge/centre of structural element of wall or to grid-line, unless noted. If unclear consult Cooley Architects.

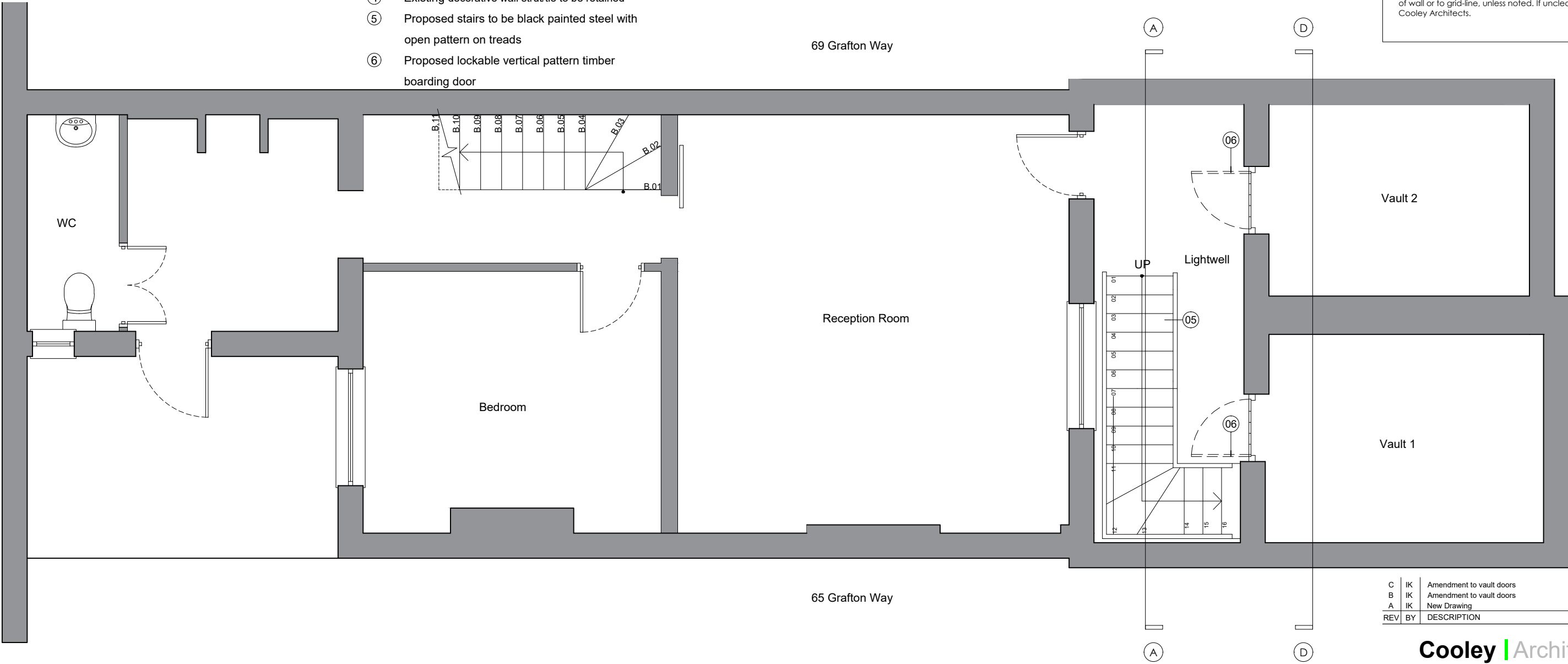

1 Lower Ground Floor
As proposed

C	IK	Amendment to vault doors	CC	24.11.20
B	IK	Amendment to vault doors	CC	09.10.20
A	IK	New Drawing	CC	20.03.20
REV	BY	DESCRIPTION	CKD	DATE

Cooley Architects

123 Aldersgate Street
t: 020 3176 4481

London
www.cooleyarchitects.com

EC1A 4JQ

CLIENT

Mr Domingo

PROJECT

67 Grafton Way

W1T 6JB

DRAWING TITLE

Proposed Lower Ground Floor

DRAWN BY	DATE	CHECKED
IK	Mar' 20	CC
SCALE	SIZE	STATUS
1:50	A3	Planning

DRAWING No	REV
976 - CYA - A1 - B1- DR - A- 00018	C