

- General Notes:
1. Copyright of this drawing remains the sole property of Cooley Architects unless otherwise assigned in writing.
 2. Figured dimensions are to be worked in all cases with any discrepancies reported to the Architect prior to commencement of any work.
 3. Setting-out is based on inherited drawings (scaled at 1:100) and survey by others. All dimensions to be checked on site prior to construction/ordering.
 4. All dimensions are to edge/centre of structural element of wall/partition, unless noted. If unclear consult Cooley Architects.
 5. Extent of decoration to specific rooms TBC
 6. Drainage runs are illustratory and require further design input by specialist consultant and approval by Building Inspector

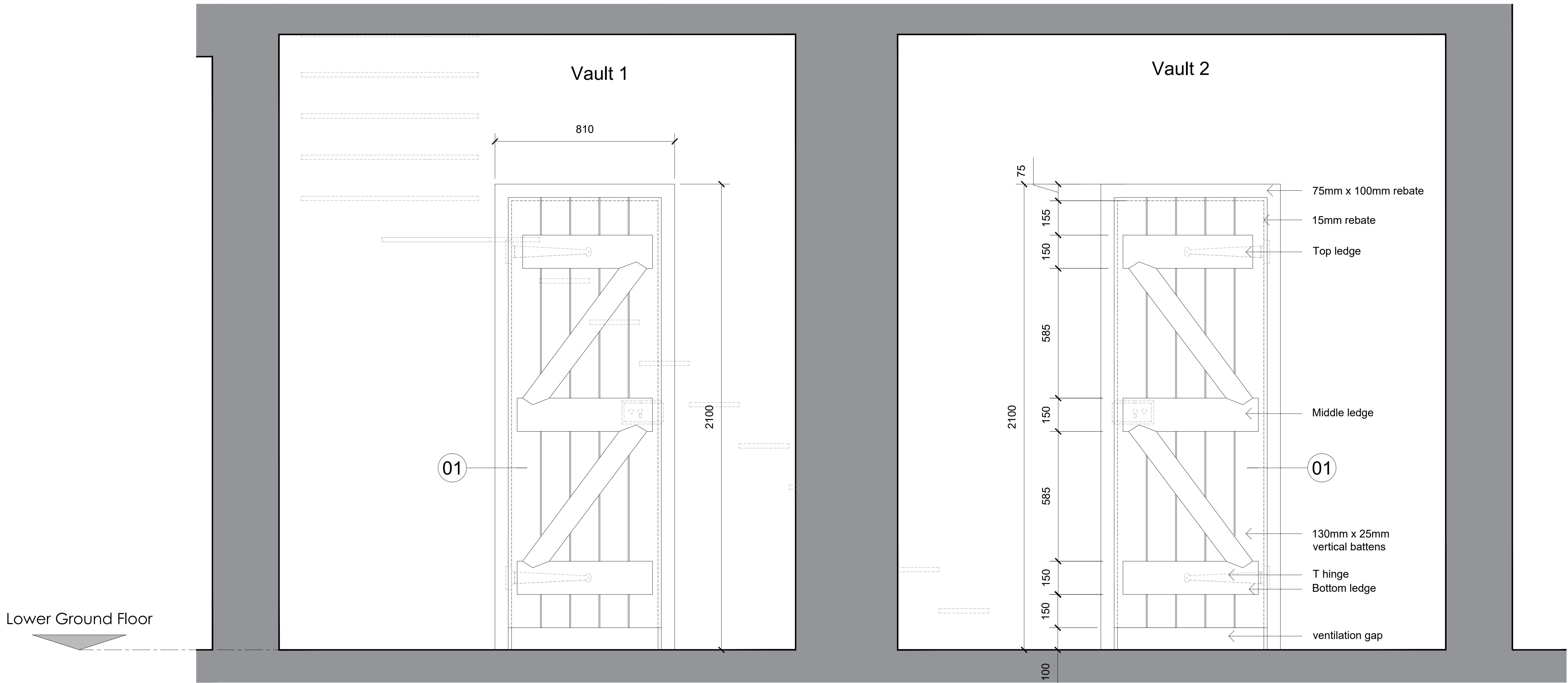
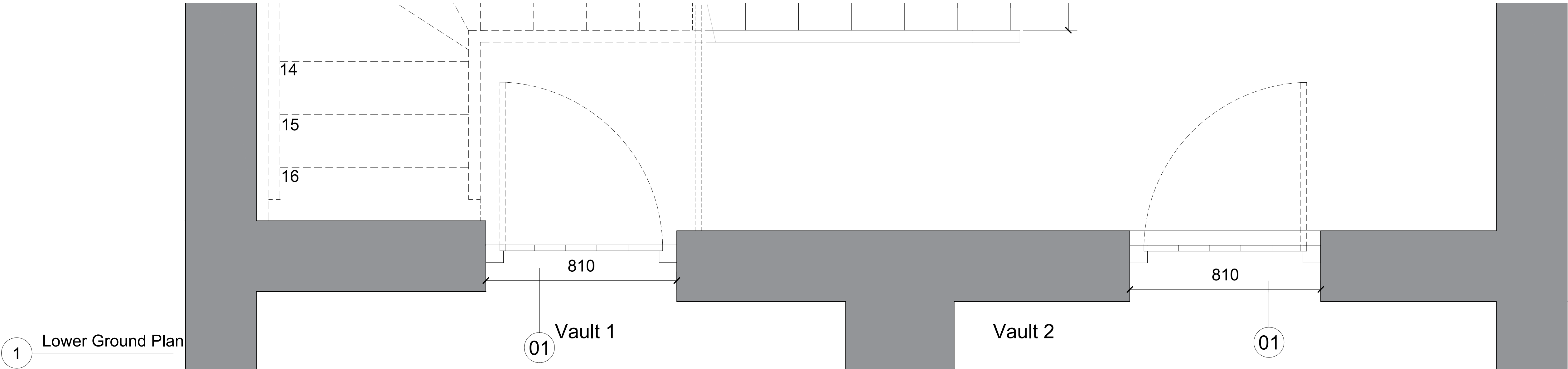

B	IK	Amendment to vault doors	CC	24.11.20
A	IK	New Drawing	CC	15.10.20
REV	BY	DESCRIPTION	CHKD	DATE

Cooley | Architects

123 Aldersgate Street London EC1A 4JQ
t: 020 3176 4481 www.cooleyarchitects.com

CLIENT
Mr Domingo
PROJECT
67 Grafton Way
SG5 1BB

DRAWING TITLE

Lightwell: Vault Door Detail

DRAWN BY	DATE	CHECKED
IK	Oct' 20	CC
SCALE	SIZE	STATUS
1:10	A1	Planning

DRAWING No
976-CYA-A1-ZZ-DR-A-00025

REVISION
B

1 Section AA

1 Timber boarding door in vertical pattern with timber bracing on its inner side.
(100mm gap at bottom of door to allow for ventilation) (As viewed from inside vault)