

13

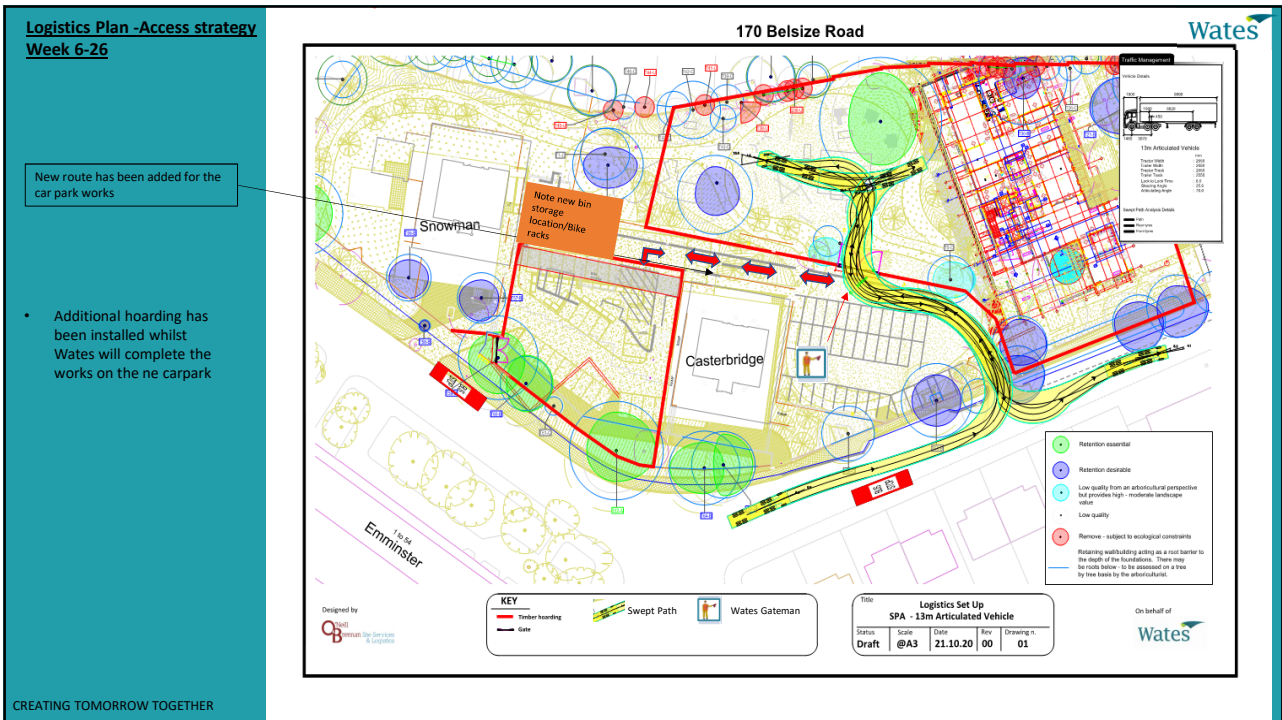

14

Travelling to the project

- All staff and operatives will use public transport to the project wherever possible.
- Strictly no parking available on the project or surrounding area and all operatives and visitors will be advised on this.

Security

- The project will have a 2.4m high hoarding
- Security operative will be on site from 06:30 till 18:30 out of hours the project will be monitored by a external guard reviewing CCTV.

Evening and weekends

- All office and task lighting will be switched off with only the hoarding lights left on

Community engagement

- Notice boards with monthly updates
- Construction working group
- Facebook



