

KEY

- BUILDING FABRIC RETAINED AND PROTECTED DURING WORKS
- PROPOSED STRUCTURAL ELEMENTS
- CONSENTED RETAINING/PARTY WALL
- PROPOSED CONSTRUCTION (NON-STRUCTURAL)
- INTERNAL WALLS AND FINISHES INSTALLED IN 2012 TO BE REINSTATED FOLLOWING COMPLETION OF BASEMENT WORKS WITH LOCALISED MODIFICATION TO SUIT NEW BASEMENT ACCESS

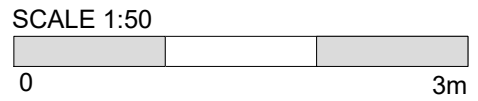

EXISTING BASEMENT WALL TO No.13b

**No. 13b
NORTHINGTON
STREET EXISTING
BASEMENT**
(BASED ON PLANNING
DRAWINGS BY BUTTON
RICHARDSON ARCHITECTS)

PROPOSED SUPPLY AND EXTRACT
DUCTS FROM ABOVE TO OFFSET
AT H/L WITHIN NEW BASEMENT
CEILING VOID

**No. 27 JOHN'S MEWS
PROPOSED BASEMENT**

SEE NOTE

THIS RETAINING WALL FORMS
PART OF PLANNING APPROVAL
REF 2018/4934/P

UNDER-PINNING TO EXISTING
PARTY WALL ABOVE

APPROXIMATE/ ASSUMED LINE OF
INNER FACE OF WALL OVER
(DASHED LINE OVER)

PROPOSED BASEMENT PLAN

SCALE 1:50 @ A3

**DRAWING STATUS
PLANNING**

- NOTES:
1. DO NOT SCALE FROM THIS DRAWING.
 2. ALL DIMENSIONS ARE TO BE VERIFIED ON SITE BY THE CONTRACTOR.
 3. ANY DISCREPANCY FOUND BETWEEN THIS DRAWING AND ANY OTHER DOCUMENTS MUST BE REPORTED IMMEDIATELY TO THE CONTRACT ADMINISTRATOR.
 4. REMOVE THIS DRAWING FROM CURRENCY WHEN A REVISED DRAWING IS ISSUED.
 5. COPYRIGHT OF THIS DRAWING REMAINS WITH SCH ARCHITECTS.
 6. THIS DRAWING IS TO BE READ IN CONJUNCTION WITH THE EMPLOYER'S AND CONSULTANT'S PROJECT DOCUMENTS.

A3 NOT FOR CONSTRUCTION

A 14.12.20 ISSUED FOR PLANNING
- 10.03.20 ISSUED FOR PRE-APPLICATION

**SMITH C-H
ARCHITECTS**

23 WEXNER BUILDING
2 STRYPE STREET
LONDON E1 7LF
TEL : 07879 637 560
email : mail@sch-architects.com
www.sch-architects.com

ARCHITECTS ■ DESIGNERS

CLIENT

COLIN FRASER

PROJECT

25 JOHN'S MEWS

SCALE 1:50	DATE 24/02/20
DRAWN LG	CHKD DS

DRAWING TITLE

PROPOSED
BASEMENT PLAN

PROJECT NO. 826	DRAWING NO. A102	REV. A
--------------------	---------------------	-----------

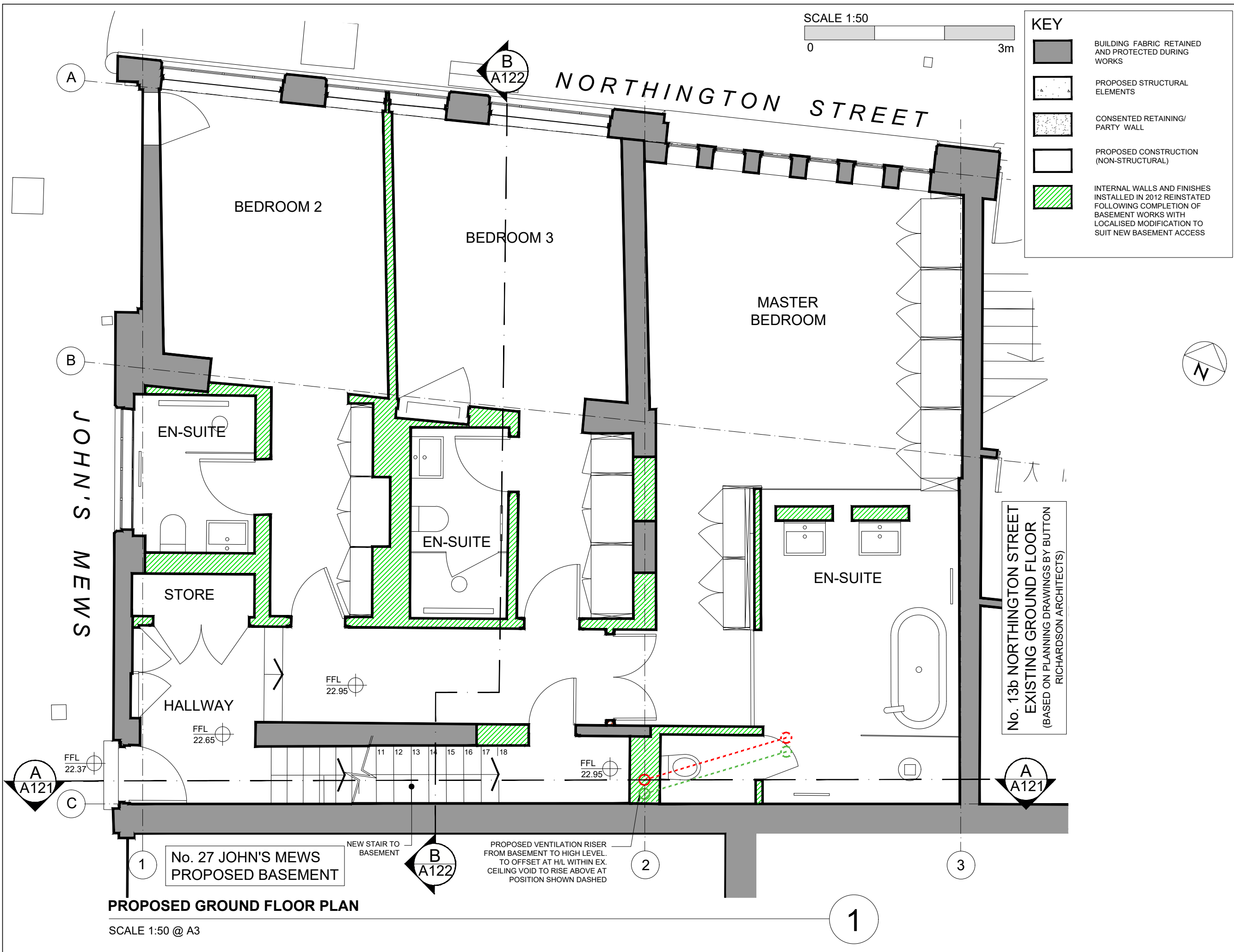

SCALE 1:50
0 3m

KEY

- BUILDING FABRIC RETAINED AND PROTECTED DURING WORKS
- PROPOSED STRUCTURAL ELEMENTS
- CONSENTED RETAINING/PARTY WALL
- PROPOSED CONSTRUCTION (NON-STRUCTURAL)
- INTERNAL WALLS AND FINISHES INSTALLED IN 2012 REINSTATED FOLLOWING COMPLETION OF BASEMENT WORKS WITH LOCALISED MODIFICATION TO SUIT NEW BASEMENT ACCESS

DRAWING STATUS
PLANNING

- NOTES:
1. DO NOT SCALE FROM THIS DRAWING.
 2. ALL DIMENSIONS ARE TO BE VERIFIED ON SITE BY THE CONTRACTOR.
 3. ANY DISCREPANCY FOUND BETWEEN THIS DRAWING AND ANY OTHER DOCUMENTS MUST BE REPORTED IMMEDIATELY TO THE CONTRACT ADMINISTRATOR.
 4. REMOVE THIS DRAWING FROM CURRENCY WHEN A REVISED DRAWING IS ISSUED.
 5. COPYRIGHT OF THIS DRAWING REMAINS WITH SCH ARCHITECTS.
 6. THIS DRAWING IS TO BE READ IN CONJUNCTION WITH THE EMPLOYER'S AND CONSULTANT'S PROJECT DOCUMENTS.

A3 NOT FOR CONSTRUCTION

A 14.12.20 ISSUED FOR PLANNING
- 10.03.20 ISSUED FOR PRE-APPLICATION

SMITH C-H ARCHITECTS
23 WEXNER BUILDING
2 STRYPE STREET
LONDON E1 7LF
TEL. 07879 637 560
email: mail@sch-architects.com
www.sch-architects.com

ARCHITECTS ■ DESIGNERS

CLIENT
COLIN FRASER

PROJECT
25 JOHN'S MEWS

SCALE 1:50	DATE 24/02/20
DRAWN LG	CHKD DS

DRAWING TITLE
PROPOSED
GROUND FLOOR PLAN

PROJECT NO. 826	DRAWING NO. A103	REV. A
--------------------	---------------------	-----------

**No. 27 JOHN'S MEWS
PROPOSED BASEMENT**
PROPOSED GROUND FLOOR PLAN
SCALE 1:50 @ A3

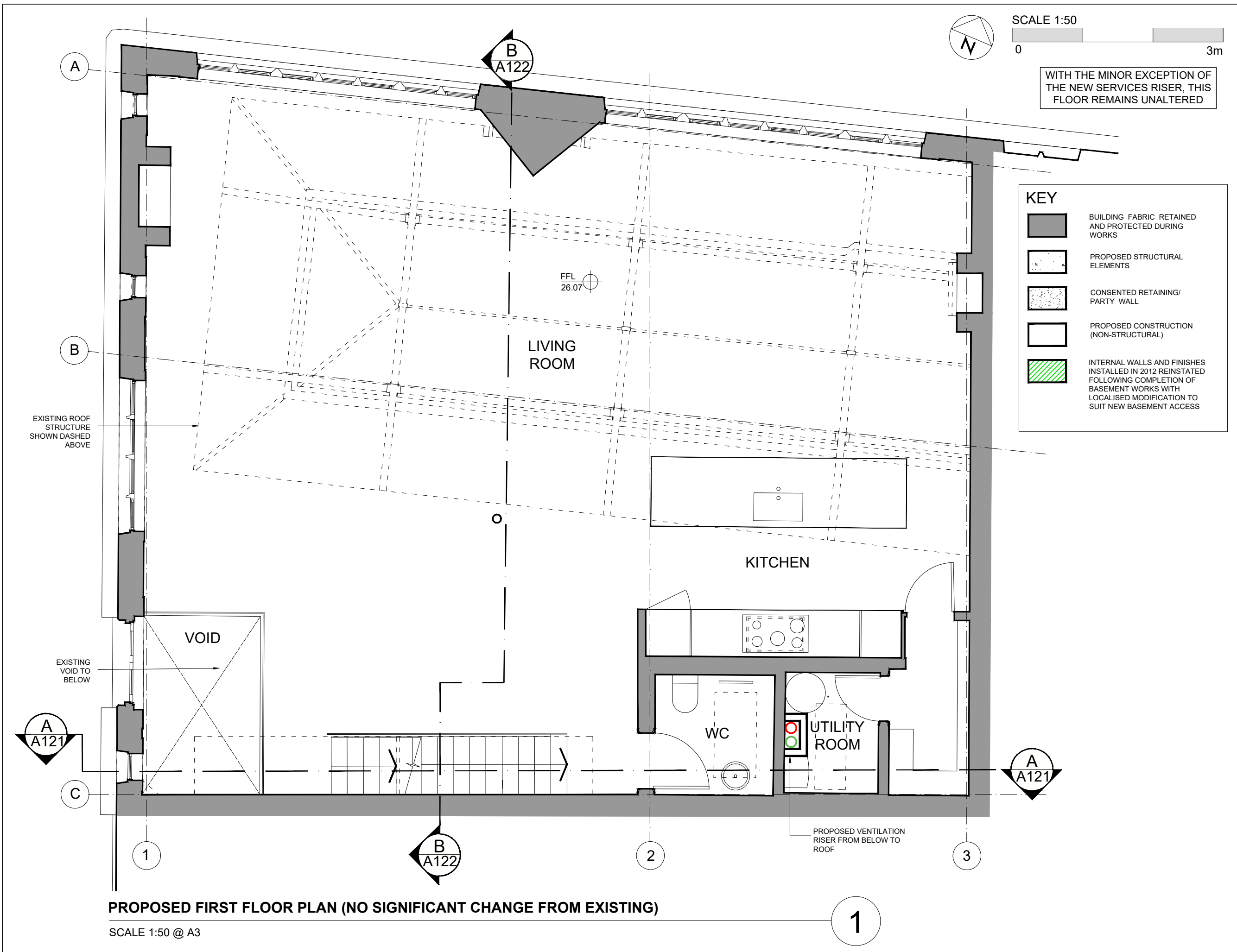

DRAWING STATUS
PLANNING

- NOTES:
- DO NOT SCALE FROM THIS DRAWING.
 - ALL DIMENSIONS ARE TO BE VERIFIED ON SITE BY THE CONTRACTOR.
 - ANY DISCREPANCY FOUND BETWEEN THIS DRAWING AND ANY OTHER DOCUMENTS MUST BE REPORTED IMMEDIATELY TO THE CONTRACT ADMINISTRATOR.
 - REMOVE THIS DRAWING FROM CURRENCY WHEN A REVISED DRAWING IS ISSUED.
 - COPYRIGHT OF THIS DRAWING REMAINS WITH SCH ARCHITECTS.
 - THIS DRAWING IS TO BE READ IN CONJUNCTION WITH THE EMPLOYER'S AND CONSULTANT'S PROJECT DOCUMENTS.

A3 NOT FOR CONSTRUCTION

A 14.12.20 ISSUED FOR PLANNING
- 10.03.20 ISSUED FOR PRE-APPLICATION

SMITH C-H ARCHITECTS

23 WEXNER BUILDING
2 STRYPE STREET
LONDON E1 7LF
TEL . 07879 637 560
email . mail@sch-architects.com
www.sch-architects.com

ARCHITECTS ■ DESIGNERS

CLIENT
COLIN FRASER

PROJECT
25 JOHN'S MEWS

SCALE 1:50	DATE 04/03/20
DRAWN LG	CHKD DS

DRAWING TITLE
PROPOSED FIRST FLOOR
(REMAINS UNALTERED UNLESS NOTED)



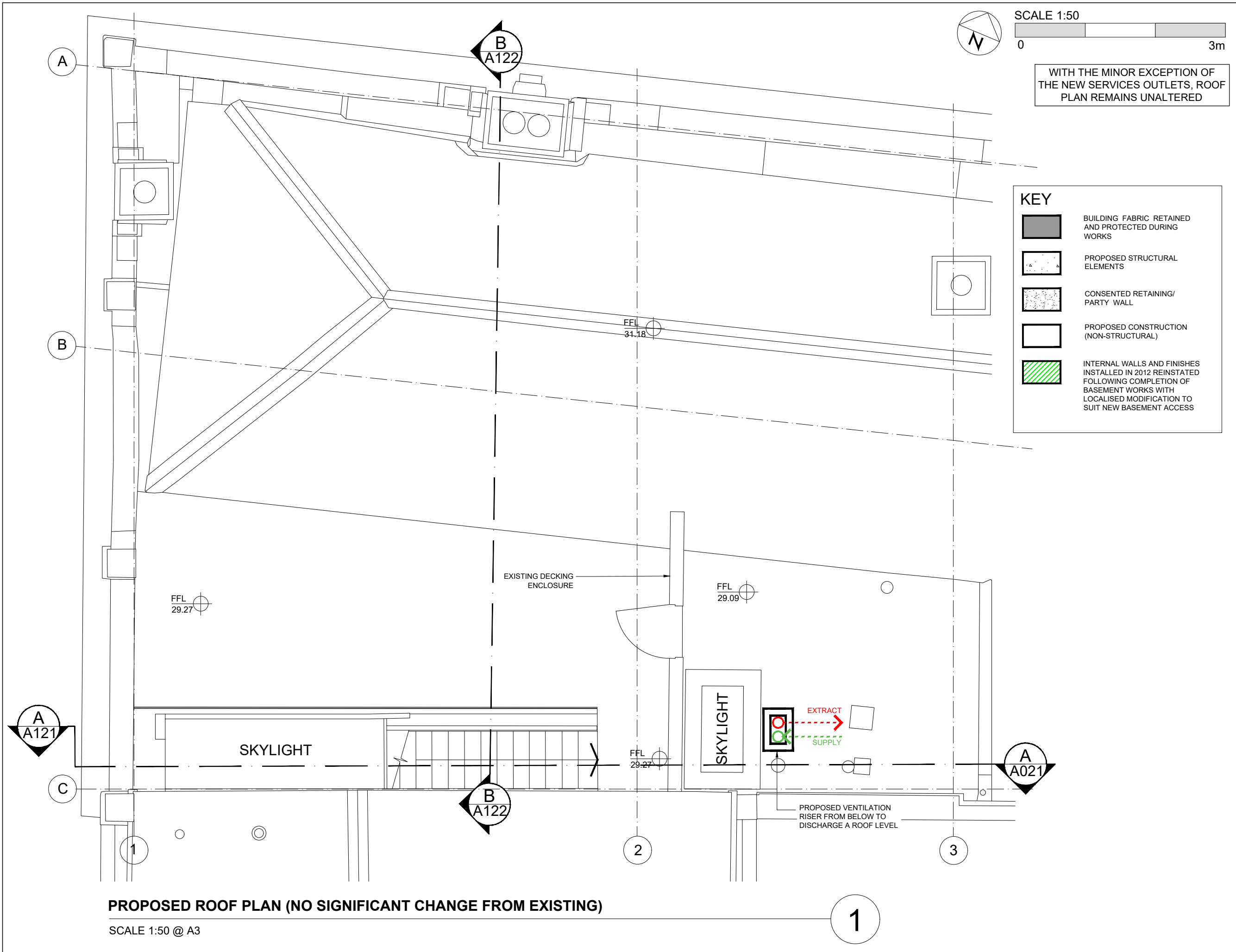

PROJECT NO. 826	DRAWING NO. A104	REV. A
--------------------	---------------------	-----------



SCALE 1:50
0 3m

WITH THE MINOR EXCEPTION OF THE NEW SERVICES OUTLETS, ROOF PLAN REMAINS UNALTERED

KEY

-  BUILDING FABRIC RETAINED AND PROTECTED DURING WORKS
-  PROPOSED STRUCTURAL ELEMENTS
-  CONSENTED RETAINING/PARTY WALL
-  PROPOSED CONSTRUCTION (NON-STRUCTURAL)
-  INTERNAL WALLS AND FINISHES INSTALLED IN 2012 REINSTATED FOLLOWING COMPLETION OF BASEMENT WORKS WITH LOCALISED MODIFICATION TO SUIT NEW BASEMENT ACCESS

DRAWING STATUS
PLANNING

- NOTES:
1. DO NOT SCALE FROM THIS DRAWING.
 2. ALL DIMENSIONS ARE TO BE VERIFIED ON SITE BY THE CONTRACTOR.
 3. ANY DISCREPANCY FOUND BETWEEN THIS DRAWING AND ANY OTHER DOCUMENTS MUST BE REPORTED IMMEDIATELY TO THE CONTRACT ADMINISTRATOR.
 4. REMOVE THIS DRAWING FROM CURRENCY WHEN A REVISED DRAWING IS ISSUED.
 5. COPYRIGHT OF THIS DRAWING REMAINS WITH SCH ARCHITECTS.
 6. THIS DRAWING IS TO BE READ IN CONJUNCTION WITH THE EMPLOYER'S AND CONSULTANT'S PROJECT DOCUMENTS.

A3 NOT FOR CONSTRUCTION

A 14.12.20 ISSUED FOR PLANNING
- 10.03.20 ISSUED FOR PRE-APPLICATION

SMITH C-H ARCHITECTS
23 WEXNER BUILDING
2 STRYPE STREET
LONDON E1 7LF
TEL : 07879 637 560
email : mail@sch-architects.com
www.sch-architects.com

ARCHITECTS ■ DESIGNERS

CLIENT
COLIN FRASER

PROJECT
25 JOHN'S MEWS

SCALE 1:50	DATE 04/03/20
DRAWN LG	CHKD DS

DRAWING TITLE
PROPOSED ROOF PLAN
(REMAINS UNALTERED UNLESS NOTED)

PROJECT NO. 826	DRAWING NO. A105	REV. A
--------------------	---------------------	-----------

PROPOSED ROOF PLAN (NO SIGNIFICANT CHANGE FROM EXISTING)

SCALE 1:50 @ A3

1

THIS ELEVATION WILL REMAIN UNALTERED UNDER THESE WORKS

DRAWING STATUS
PLANNING

- NOTES:
- DO NOT SCALE FROM THIS DRAWING.
 - ALL DIMENSIONS ARE TO BE VERIFIED ON SITE BY THE CONTRACTOR.
 - ANY DISCREPANCY FOUND BETWEEN THIS DRAWING AND ANY OTHER DOCUMENTS MUST BE REPORTED IMMEDIATELY TO THE CONTRACT ADMINISTRATOR.
 - REMOVE THIS DRAWING FROM CURRENCY WHEN A REVISED DRAWING IS ISSUED.
 - COPYRIGHT OF THIS DRAWING REMAINS WITH SCH ARCHITECTS.
 - THIS DRAWING IS TO BE READ IN CONJUNCTION WITH THE EMPLOYERS AND CONSULTANTS PROJECT DOCUMENTS.

A3 NOT FOR CONSTRUCTION

14.12.20 ISSUED FOR PLANNING

SMITH C-H ARCHITECTS

23 WEXNER BUILDING
2 STRYPE STREET
LONDON E1 7LF
TEL : 07879 637 560
email : mail@sch-architects.com
www.sch-architects.com

ARCHITECTS ■ DESIGNERS

CLIENT
COLIN FRASER

PROJECT
25 JOHN'S MEWS

SCALE 1:50	DATE 26/02/20
DRAWN LG	CHKD DS

DRAWING TITLE
PROPOSED JOHN'S MEWS ELEVATION (NO CHANGE FROM EXISTING)

PROJECT NO. 826	DRAWING NO. A111	REV.
--------------------	---------------------	------



PROPOSED JOHNS MEWS ELEVATION - NO CHANGES FROM EXISTING

SCALE 1:50 @ A3

1

SCALE 1:50

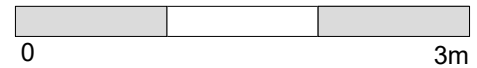



THIS ELEVATION WILL REMAIN UNALTERED UNDER THESE WORKS

DRAWING STATUS
PLANNING

- NOTES:
- DO NOT SCALE FROM THIS DRAWING.
 - ALL DIMENSIONS ARE TO BE VERIFIED ON SITE BY THE CONTRACTOR.
 - ANY DISCREPANCY FOUND BETWEEN THIS DRAWING AND ANY OTHER DOCUMENTS MUST BE REPORTED IMMEDIATELY TO THE CONTRACT ADMINISTRATOR.
 - REMOVE THIS DRAWING FROM CURRENCY WHEN A REVISED DRAWING IS ISSUED.
 - COPYRIGHT OF THIS DRAWING REMAINS WITH SCH ARCHITECTS.
 - THIS DRAWING IS TO BE READ IN CONJUNCTION WITH THE EMPLOYERS AND CONSULTANTS PROJECT DOCUMENTS.

A3 NOT FOR CONSTRUCTION

14.12.20 ISSUED FOR PLANNING

SMITH C-H ARCHITECTS
 23 WEXNER BUILDING
 2 STRYPE STREET
 LONDON E1 7LF
 TEL . 07879 637 560
 email . mail@sch-architects.com
 www.sch-architects.com

ARCHITECTS ■ DESIGNERS

CLIENT
COLIN FRASER

PROJECT
25 JOHN'S MEWS

SCALE 1:50	DATE 26/02/20
DRAWN LG	CHKD DS

DRAWING TITLE
PROPOSED NORTHINGTON ST. ELEVATION (REMAINS UNALTERED)

PROJECT NO. 826	DRAWING NO. A112	REV.
--------------------	---------------------	------

13 NORTHINGTON STREET

PROPOSED NORTHINGTON STREET ELEVATION - NO CHANGES FROM EXISTING

SCALE 1:50 @ A3

1

SCALE 1:50

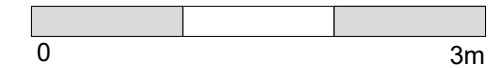

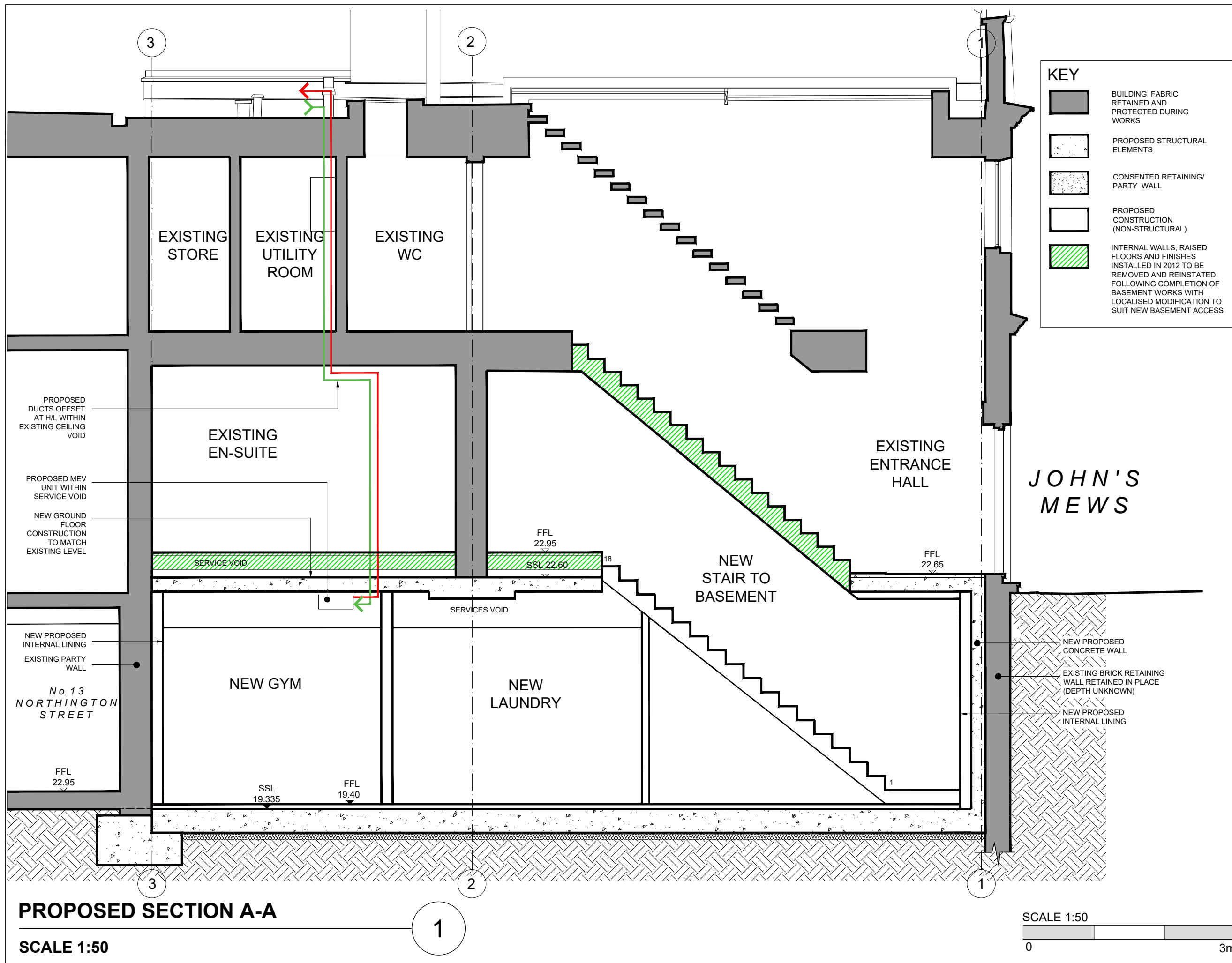

DRAWING STATUS PLANNING		
NOTES: 1. DO NOT SCALE FROM THIS DRAWING. 2. ALL DIMENSIONS ARE TO BE VERIFIED ON SITE BY THE CONTRACTOR. 3. ANY DISCREPANCY FOUND BETWEEN THIS DRAWING AND ANY OTHER DOCUMENTS MUST BE REPORTED IMMEDIATELY TO THE CONTRACT ADMINISTRATOR. 4. REMOVE THIS DRAWING FROM CURRENCY WHEN A REVISED DRAWING IS ISSUED. 5. COPYRIGHT OF THIS DRAWING REMAINS WITH SCH ARCHITECTS. 6. THIS DRAWING IS TO BE READ IN CONJUNCTION WITH THE EMPLOYERS AND CONSULTANTS PROJECT DOCUMENTS.		
A3	NOT FOR CONSTRUCTION	
A 14.12.20	ISSUED FOR PLANNING	
- 10.03.20	ISSUED FOR PRE-APPLICATION	
SMITH C-H ARCHITECTS 23 WEXNER BUILDING 2 STRYPE STREET LONDON E1 7LF TEL : 07879 637 560 email : mail@sch-architects.com www.sch-architects.com ARCHITECTS ■ DESIGNERS		
CLIENT COLIN FRASER		
PROJECT 25 JOHN'S MEWS		
SCALE 1:50	DATE 24/02/20	
DRAWN LG	CHKD DS	
DRAWING TITLE PROPOSED SECTION A-A		
PROJECT NO. 826	DRAWING NO. A121	REV. A

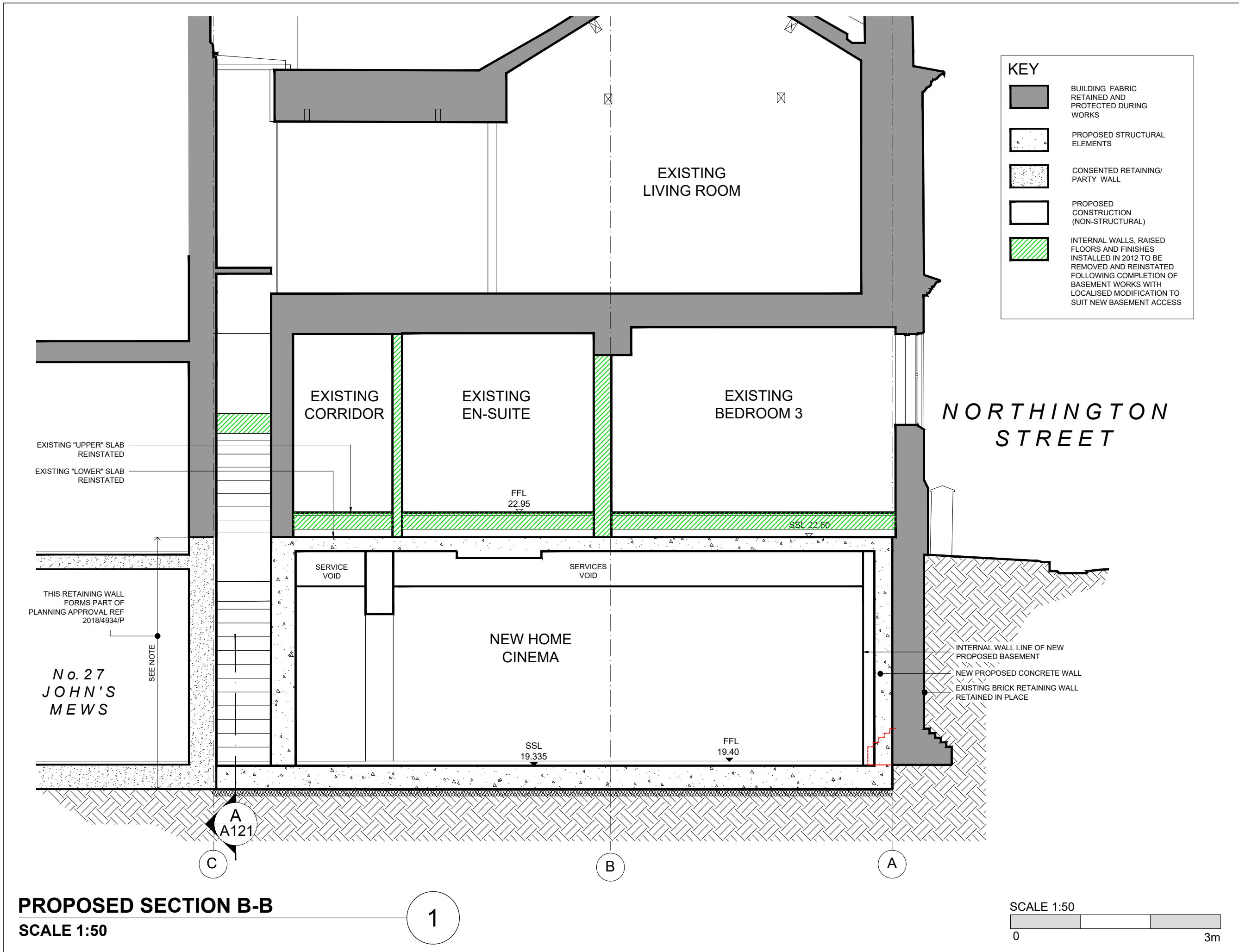

KEY

- BUILDING FABRIC RETAINED AND PROTECTED DURING WORKS
- PROPOSED STRUCTURAL ELEMENTS
- CONSENTED RETAINING/PARTY WALL
- PROPOSED CONSTRUCTION (NON-STRUCTURAL)
- INTERNAL WALLS, RAISED FLOORS AND FINISHES INSTALLED IN 2012 TO BE REMOVED AND REINSTATED FOLLOWING COMPLETION OF BASEMENT WORKS WITH LOCALISED MODIFICATION TO SUIT NEW BASEMENT ACCESS

DRAWING STATUS
PLANNING

- NOTES:
1. DO NOT SCALE FROM THIS DRAWING.
 2. ALL DIMENSIONS ARE TO BE VERIFIED ON SITE BY THE CONTRACTOR.
 3. ANY DISCREPANCY FOUND BETWEEN THIS DRAWING AND ANY OTHER DOCUMENTS MUST BE REPORTED IMMEDIATELY TO THE CONTRACT ADMINISTRATOR.
 4. REMOVE THIS DRAWING FROM CURRENCY WHEN A REVISED DRAWING IS ISSUED.
 5. COPYRIGHT OF THIS DRAWING REMAINS WITH SCH ARCHITECTS.
 6. THIS DRAWING IS TO BE READ IN CONJUNCTION WITH THE EMPLOYERS AND CONSULTANT'S PROJECT DOCUMENTS.

A3 NOT FOR CONSTRUCTION

A	14.12.20	ISSUED FOR PLANNING
-	10.03.20	ISSUED FOR PRE-APPLICATION

SMITH C-H ARCHITECTS

23 WEXNER BUILDING
2 STRYPE STREET
LONDON E1 7LF
TEL: 07879 637 560
email: mail@sch-architects.com
www.sch-architects.com

ARCHITECTS ■ DESIGNERS

CLIENT

COLIN FRASER

PROJECT

25 JOHN'S MEWS

SCALE	DATE
1:50	24/02/20
DRAWN	CHKD
LG	DS

DRAWING TITLE

PROPOSED SECTION B-B

PROJECT NO.	DRAWING NO.	REV.
826	A122	A

PROPOSED SECTION B-B
SCALE 1:50

1

