

**LEGEND**

- TITAN PROPS
- MABEY MASS 25 TEMPORATY PROPS TO BEAM OVER

**DEMOLISHING WORKS LEGEND**

- Elements to be demolished

- GENERAL NOTES:**
- Do not scale this drawing in either paper or digital form. Use figured dimensions only.
  - All 'Ross & Partners' drawings to be read in conjunction with all relevant Architect's drawings and any discrepancies reported to all relevant parties.
  - This drawing is to be read in conjunction with other 'Ross & Partners' drawings and 'Ross & Partners' Structural Specification documents and any discrepancies reported to all relevant parties.
  - Settling out will be in accordance with the Architect's dimensions and as discussed and agreed between Client, Contractor and the Architects and any discrepancies reported to all relevant parties.
  - For General Notes refer to drawings:
    - 2012-RP-XX-XX-FN-S-001
    - 2012-RP-XX-XX-FN-S-002
    - 2012-RP-XX-XX-FN-S-003

- Sequence 1**
- Form individual pits not exceeding 1m in length in the sequence shown on the plan
  - Shuttering is to be installed on all four sides of the pits and secured in place with trench props. The geotechnical investigation indicate the near surface soils to comprise of Made Ground deposits which will be of varying composition. So temporary propping and boarding should be installed as excavation proceeds. All temporary boarding must be adequately braced to prevent collapse.
- Sequence 2**
- The formation is to bear within the Lynch Hill Gravels. Arrange for the Engineer to inspect and approve the formation.
  - Cast blinding, fix reinforcement - including continuity strips for adjoining bases and wall starters. Secure hydro seal waterbars to side shutters
  - Cast Base
- Sequence 3**
- Fix wall stem reinforcing bars - including continuity strips for adjoining wall stems, shutter and cast concrete ensuring thorough compaction.
  - After 24 hours dry pack between top of RC wall and underside of existing wall.

**Construction Plan - Stage 4**  
1 : 50

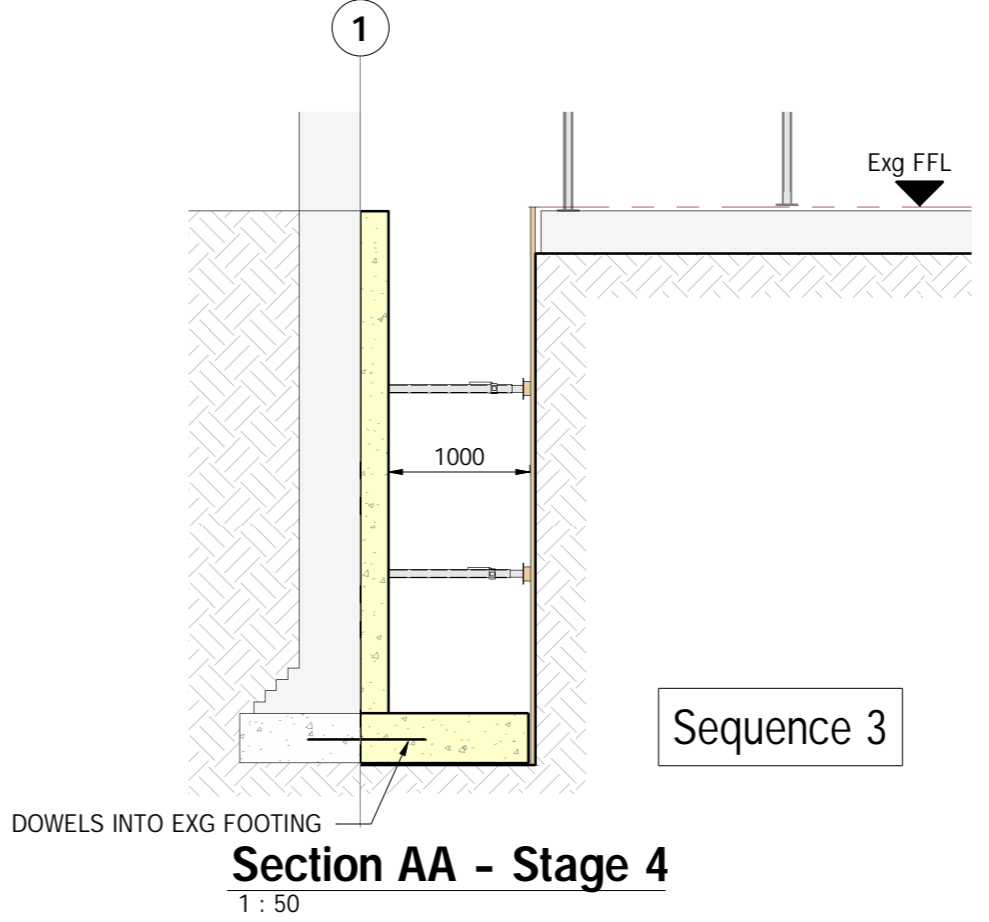
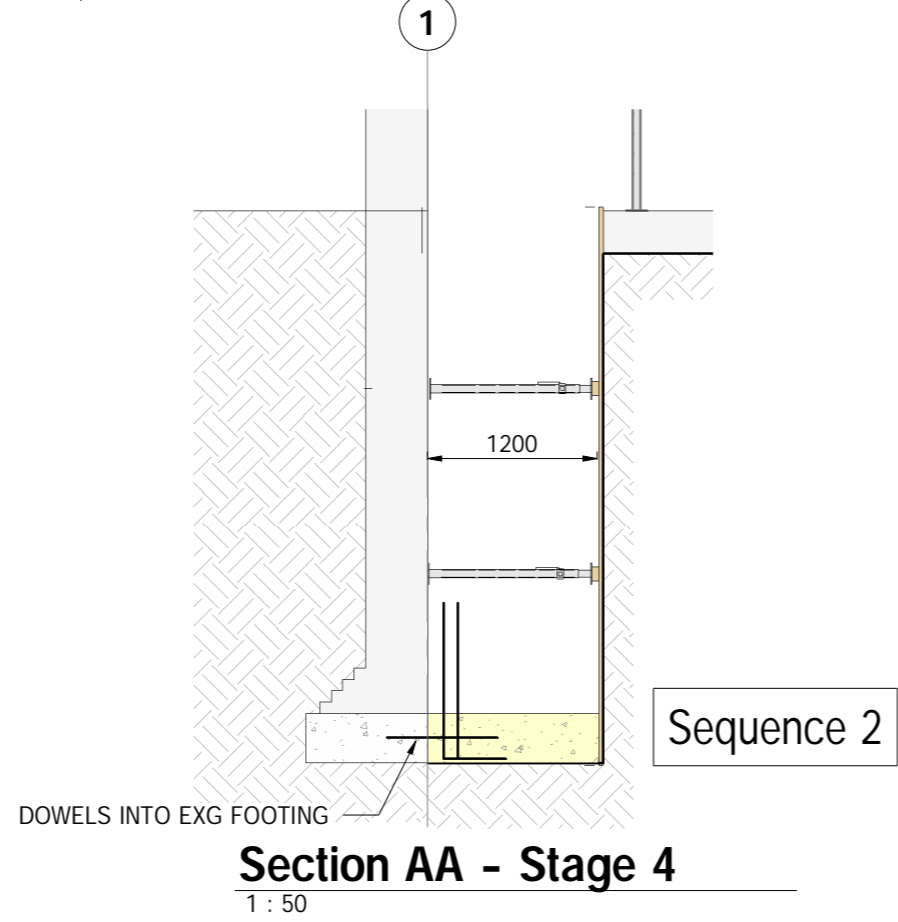
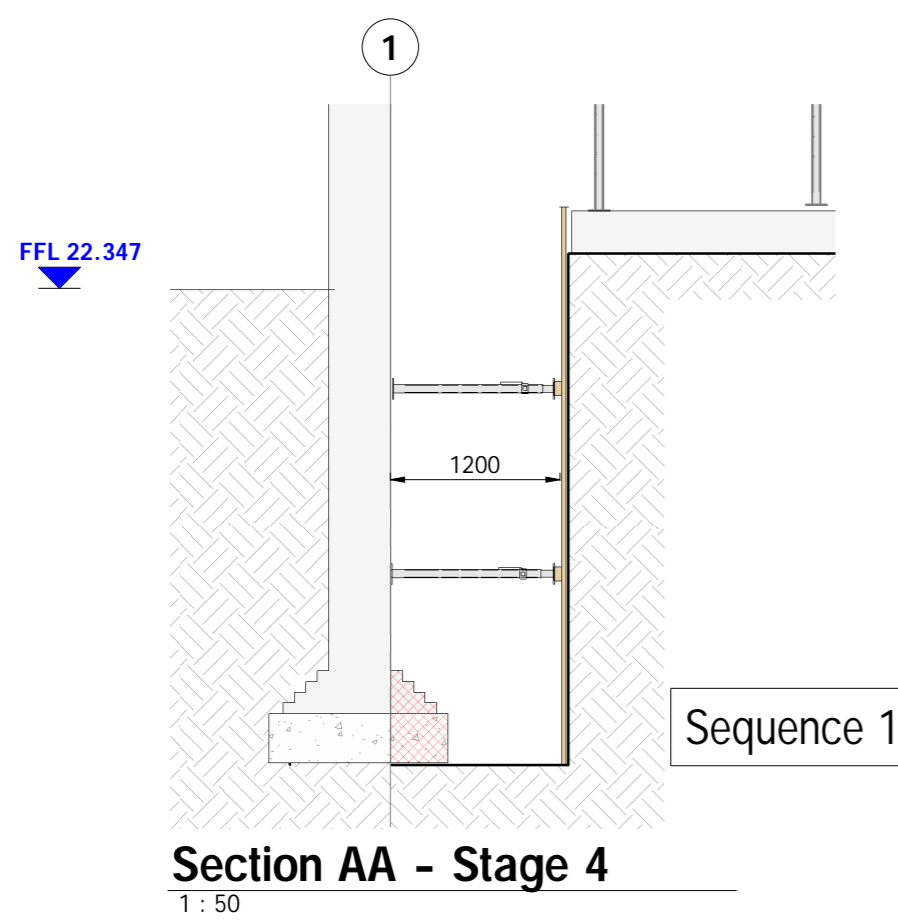

No.	Rev.	By	Description	Date
3	P03	AA	Issued for Planning Application	2020 12 03
2	P02	AA	Updated to comments	2020 11 06
1	P01	AA	Issued for Comments	2020 08 20

CLIENT: COLIN FRASER  
PROJECT MANAGER:  
ARCHITECT: SMITH C-H ARCHITECTS  
M+E ENGINEER:

**ROSS & PARTNERS**  
Consulting Civil & Structural Engineers  
1 Bastwick Street, Clerkenwell, London, EC1V 3NU  
tel. 020 755 360 50  
ross-partners.co.uk

JOB TITLE: 25 JOHN'S MEWS LONDON  
DRG TITLE: Basement Construction Sequence Stage 4  
DIRL: AA CHKD: MO'R DATE: September 2020  
STATUS: S4 - FOR STAGE APPROVAL SCALE: 1 : 50 @ A2  
Project/DRG No. 2012-RP-XX-ZZ-DR-S-104 Rev. P03