

1. No information or designs contained within this document should be copied or reproduced without the specific consent of Gunter & Co Interiors Ltd.
2. Do not scale from this drawing. Any areas, measurements or distances given are approximate only and should be confirmed before design or fabrication.
3. Any drawings, photos, or computer generated images shown are indicative and cannot be guaranteed to represent the complete interiors or exteriors of a scheme.
4. © 2017 Gunter & Co Interiors Ltd. All Rights Reserved

Notes A3

**NOTE:
FOR DESIGN INTENT ONLY.
ALL DIMENSIONS SHOULD
BE CHECKED ON SITE.**

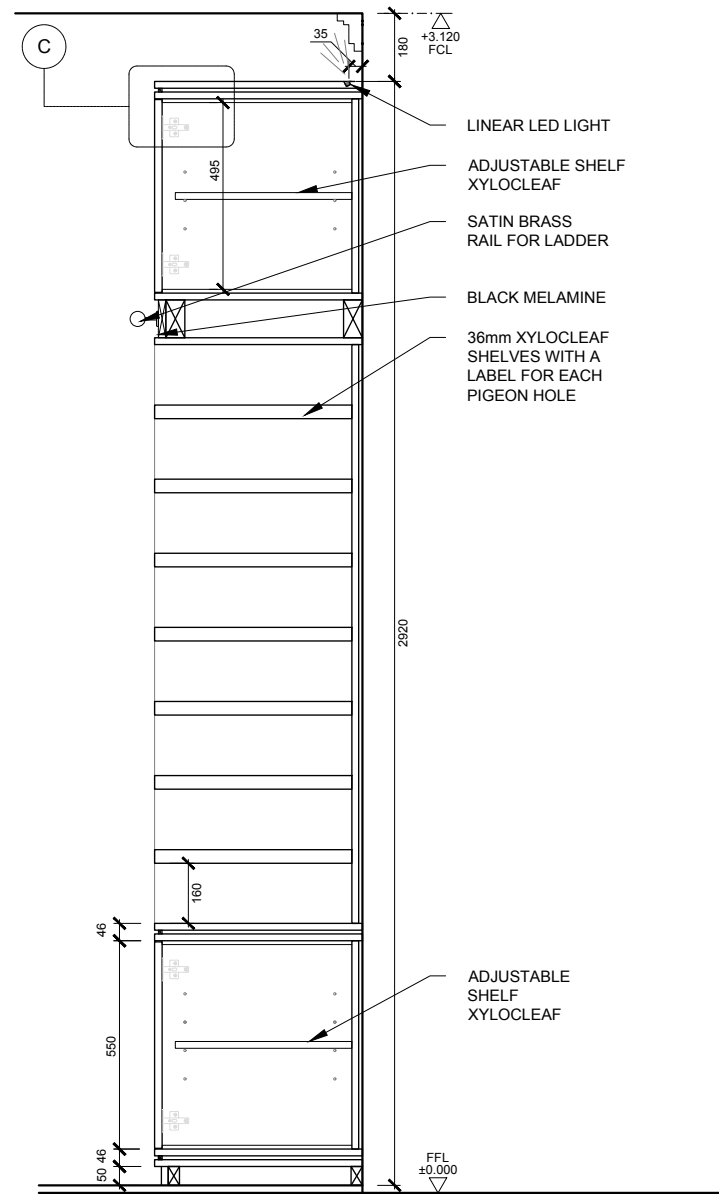

01 Room 3 - Joinery around Doors - Section B
scale 1:20 @A3



03 Reference - Shadow Gap Detail
scale 1:N/A @A3

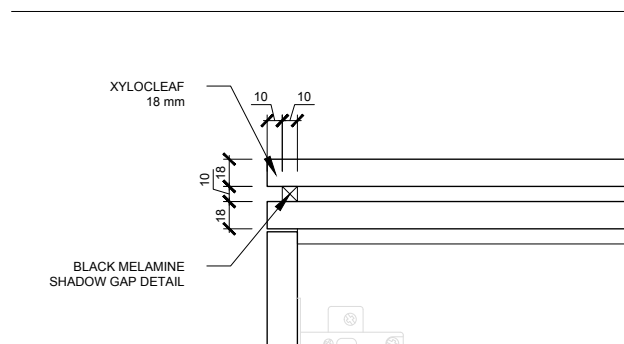

02 Room 3 - Joinery around Doors - Detail C
scale 1:5 @A3



HANDLES - Flat Black
The Hardware Hut
-Top Knobs Lynwood 12" c.c.
Hillmont Cabinet Pull TOP-TK909BLK
-Top Knobs Lynwood 12" c.c. Hollin
Pull Backplate TOP-TK929BLK

PAINT
to match XYLOCLEAF color.
G&CO to approve.

XYLOCLEAF
Kaki FA44 - Penelope

Black Melamine MDF
to be approved by G&CO



**RAIL & LADDER
BAR FITTINGS**
- SB-76-25 -Satin Brass Closed Upright
Gallery Bracket 25mm
- SB-75-25 – Satin Brass Open Upright
Gallery Bracket 25mm
- PB-96-25 – Liner joint fittings 25mm
Satin Brass
- SB 212 – Ladder hooks pair satin
brass

A	REVISION AFTER CLIENT MEETING	27.11.2020
-		20.10.2020
Rev	Note	Date

Project Title

FALCON

Drawing Title
**Joinery - Room 3
Joinery around Doors**

Date	Scale	Drawn By
27.11.2020	1:20 at A3	MB

Drawing No	Rev
FL- FF - 431	A

GUNTER & Co. INTERIORS

Unit 1.23 The Plaza
535 King's Road
London, SW10 0SZ
United Kingdom
+44 (0)20 7993
8583

