

GENERAL NOTES

- Do not scale from drawings. Check all dimensions and conditions on site.
- All works to be carried out in accordance with current health and safety including CDM regulations. All works to comply with current British standards and regulations, codes of practice and building regulations, and appropriate European standards.
- All structural work is to be carried out in accordance with the structural engineers details and calculations.
- Precise positions of all fixtures and fittings are subject to confirmation on site.
- All drawings are to be read in conjunction with the relevant specification and schedules.

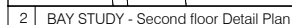
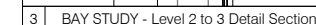

P1	30.11.20	Planning Issue	JIM	KS
rev	dsize	description	drawn	checked
drawn		job no.	000000	

1702

20004
294-295 High Holborn
Bay Study - North Elevation Levels Second to third
1:10 @ A1, 1:20 @ A3