

**DETAIL E**  
TYPICAL FOURTH FLOOR PARAPET DETAIL

- 25MM RIGID INSULATION TO UPSTAND TO ROOF PERIMETER
- FULLY ADHERED SINGLE PLY MEMBRANE TAKEN OVER 18MM WPB PLYPARD (LAID TO FALL) FORMING PROJECTING PARAPET
- BLACK ROOF TRIM. ENSURE 30MM GAP AS INDICATED
- BREATHABLE MEMBRANE TO ACHIEVE FIRE CLASSIFICATION OF B-s3, d0 OR BETTER
- 70MM KINGSPAN KOOLTHERM K112 FRAMING BOARD
- BREATHABLE MEMBRANE ON 12MM SUITABLE MINERAL SHEATHING BOARD TO ACHIEVE FIRE CLASSIFICATION OF A2-s1, d0 OR BETTER
- 70MM KINGSPAN KOOLTHERM K112 FRAMING BOARD BETWEEN STUDS
- 'EQUITONE' CLADDING (NATURA) N074 OBSIDIAN. MECHANICAL SECURE FIX USING 'EQUITONE TERGO' ALUMINIUM SUPPORTING FRAME. ALLOW FOR SPECIALIST DESIGN OF THE ALUMINIUM SUPPORTING FRAME PROVIDING NECESSARY STATIC CALCULATIONS AND POSITIONING. FIRE CLASSIFICATION A2-s1, d0
- INSECT MESH BARRIER
- PROJECTING POWDER COATED ALUMINIUM FRAME TO WINDOW RECESS FIXED BACK TO SUB-STRUCTURE
- DOUBLE GLAZED ALUMINIUM FRAMED WINDOW SUPPLIED BY PCW GLAZING SPECIALIST. TO MATCH EXISTING. TO ACHIEVE 1.4 W/M2.K
- POLYTHENE VAPOUR CONTROL LAYER BEHIND PLASTERBOARD
- DOUBLE DOTTED LINE DENOTES STANCHION BEHIND
- WALL CONSTRUCTION TO ACHIEVE A U-VALUE OF 0.14W/M2.K

EXTERNAL WALL CONSTRUCTION TO TO REVIEWED AND SIGNED OFF BY SPECIALIST FIRE CONSULTANT. ALL INSTALLED IN ACCORDANCE WITH PART B FIRE SAFETY

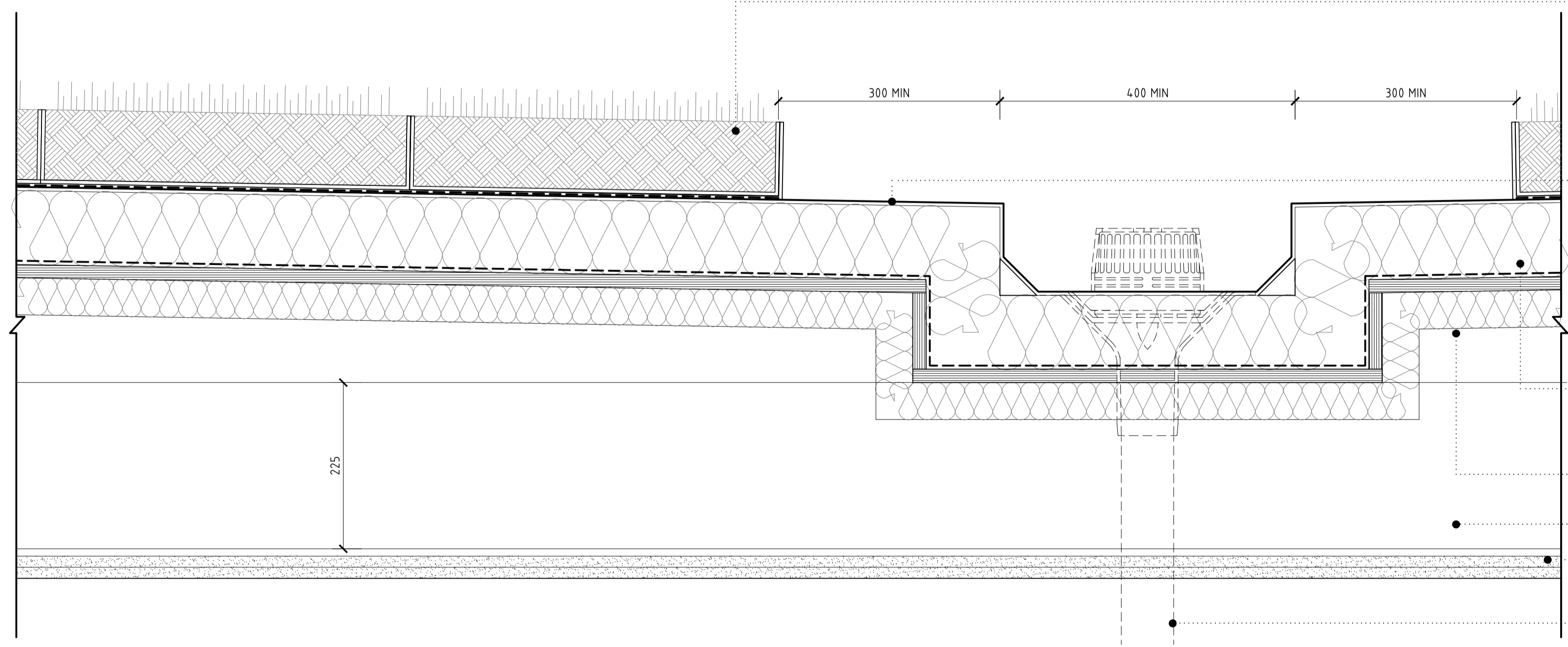

**DETAIL F**  
TYPICAL ROOF GUTTER DETAIL

- WALLBARN, M-TRAY SYSTEM, 500X500X100MM MODULE SYSTEM INSTALLED TO MANUFACTURES RECOMMENDATIONS. INCLUDE FOR SEPARATION AND FILTRATION GEOTEXTILE LAYER OVER DECK BELOW M-TRAY. ALUMINIUM EDGE TRIM TO ALL EXPOSED EDGES. EDGES ALSO FILLED WITH A BOARDER OF WASHED RIVERSTONES, IN ACCORDANCE WITH THE GRO CODE OF PRACTICE, INCLUDING AROUND ROOF LIGHTS AND AOV'S
- FULLY ADHERED SINGLE PLY MEMBRANE BY SARNAFIL [OR SIMILAR APPROVED] LAPPING AND JUNCTIONS DETAILS IN ACCORDANCE WITH MANUFACTURES SPECIFICATION. CONTRACTOR TO CONFIRM COMPATIBILITY WITH INSULATION
- EXTERNAL FIRE PERFORMANCE TESTED ACCORDING TO EN 1187 AND CLASSIFIED ACCORDING TO EN 13501-5: BROOF(T4).
- 100MM KINGSPAN THERMAROOF TR27 LPC/FM LAID OVER VAPOUR CONTROL LAYER LAID OVER 18MM PLY DECK LAID TO 1:60 FALLS, 1:80 FALLS TO GUTTERING. TBC BY ROOFING SUPPLIER
- 50MM KINGSPAN THERMAROOF TR27 LPC/FM BELOW PLY DECK BETWEEN FIRINGS
- ROOF JOISTS TO S.E. SPECIFICATION
- 2 LAYER OF GYPROC FIRELINE PLASTERBOARD, WITH 3MM SKIM COAT PLASTER FINISH TO ACHIEVE MINIMUM 60 MINUTE FIRE RESISTANCE
- HARMER [OR SIMILAR APPROVED] RVO/RWP BEHIND. ALLOW FOR 50MM ACOUSTIC INSULATION WRAPPED AROUND THE PIPES AND 2 LAYERS OF SOUNDBLOCK PLASTERBOARD
- ROOF CONSTRUCTION TO ACHIEVE A U-VALUE OF 0.15W/M2.K

Do not scale off this drawing.

All indicated dimensions to be checked and verified on site by the Main Contractor before commencement of any fabrication drawings or work whatsoever on site.

Report all discrepancies to the Architect immediately. This drawing is to be read in conjunction with all the related Architect's and Structural Engineer's drawings, details and all relevant information.

rev.	rev. date	rev. description

**tasou**  
associates architects + structural engineers

**TENDER**

4 Amwell Street, London. EC1R 1UG  
T: 020 7713 7070 F: 020 7713 7071 E: tasou@tasou.co.uk

project  
**ST PANCRAS WAY (18-20)  
LONDON, NW1 0QG**

dwg title  
**DETAIL E - F  
Typical Paraper and Roof Details**

date OCTOBER 2020	dwg no. DD.04	rev. -
scale @ A1 1:5	job no. 1744	