

MANSFIELD ROAD

→ A C ←

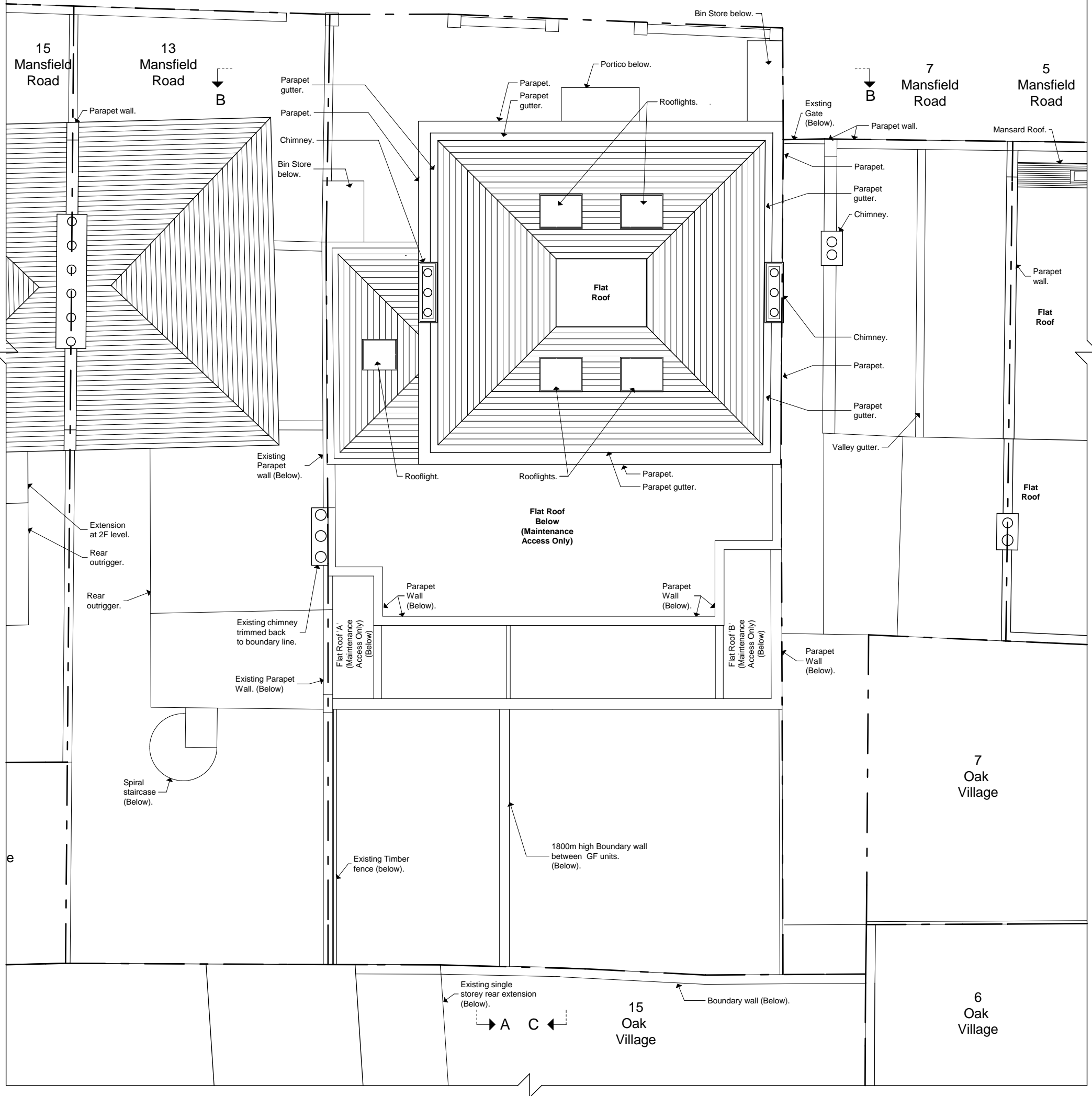

Key	
	Existing.
	Existing removed.
	Proposed.

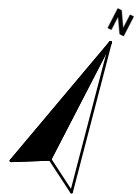

Project	9-11 Mansfield Road	Reference Number	1110-BA-117 B	Preliminary		Rev	Date	Amendment to bin stores.
Client	Mr. & Mrs. Hauser	Date	Dec 13	Planning	<input checked="" type="checkbox"/>			
Drawing	Proposed Roof Plan	Scale	1:100	Building Regs		B	16-04-18	
		Drawing Size	A3	Tender				
				Construction				
				As Built				

File Ref: 1401 - BA - Plans 3.pln © Copyright

DS
ARCHITECTS
DONALD SHEARER
CHARTERED ARCHITECTS

Scholar's House, Shotton Brook Office Park,
Timothy's Bridge Road, Stratford-upon-Avon,
Warwickshire, CV37 9NR

Tel: 01789 294 560
ds-architects@hotmail.co.uk