

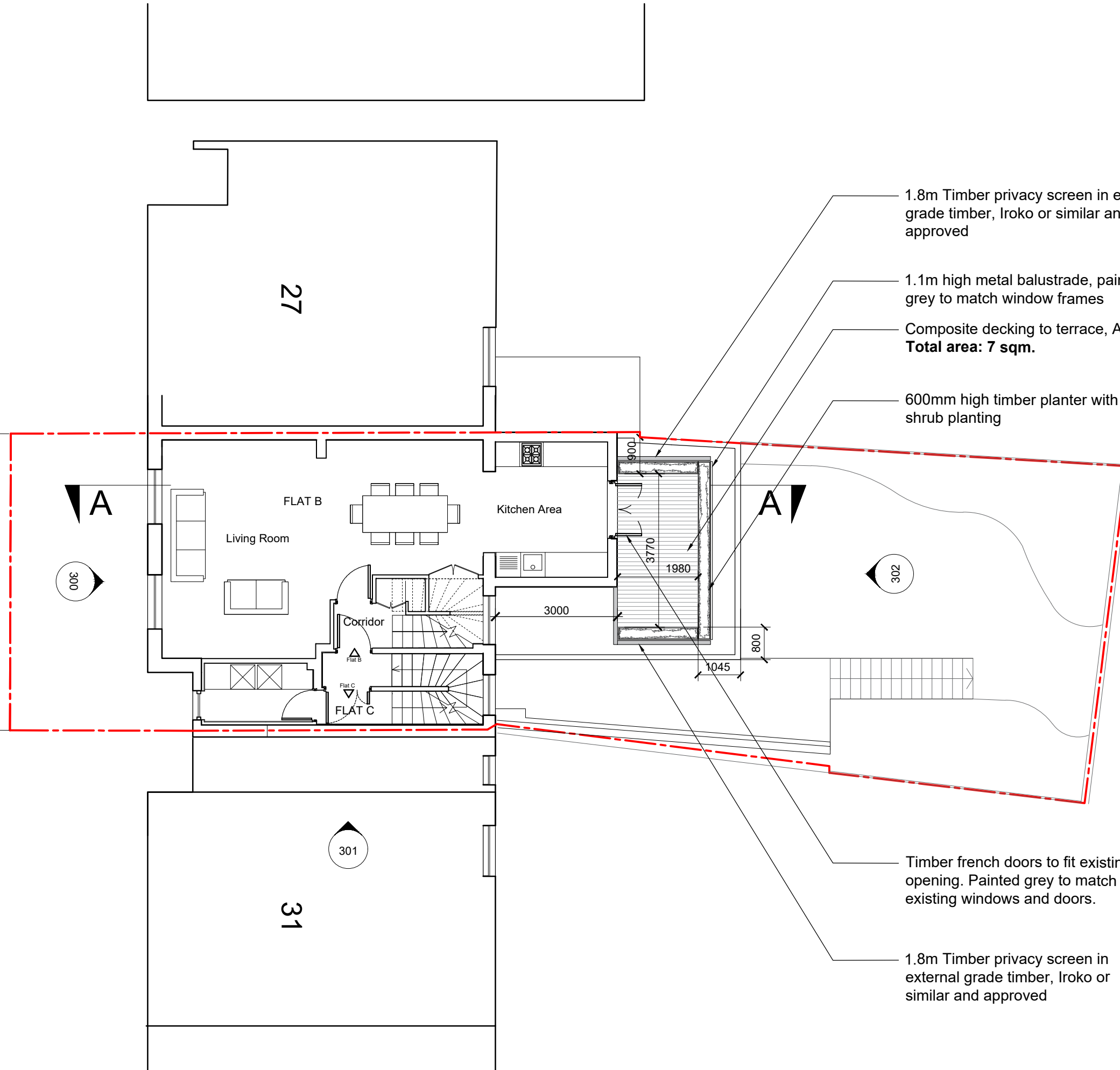

27 Prince of Wales Road

29 Prince of Wales Road

31 Prince of Wales Road



1.8m Timber privacy screen in external grade timber, Iroko or similar and approved

1.1m high metal balustrade, painted in grey to match window frames

Composite decking to terrace, Ash Grey. **Total area: 7 sqm.**

600mm high timber planter with shrub planting

Timber french doors to fit existing opening. Painted grey to match existing windows and doors.

1.8m Timber privacy screen in external grade timber, Iroko or similar and approved

P1	11.12.20	Planning Issue
Rev	Date	Note

Services

Structures

Client

Nadav Kander & Nicole Verity

Project title

29 Prince of Wales Road

Drawing Title

Proposed First Floor Plan

Scale 1:100 @ A3

Project No.	Drawing no.	Revision
191	102	P1

Status

Planning

Date of Issue

11.12.20



Clive Sall Architecture Ltd.

2 Providence Yard
Ezra Street
London E2 7RJ

Copyright CLIVE SALL ARCHITECTURE LTD

