

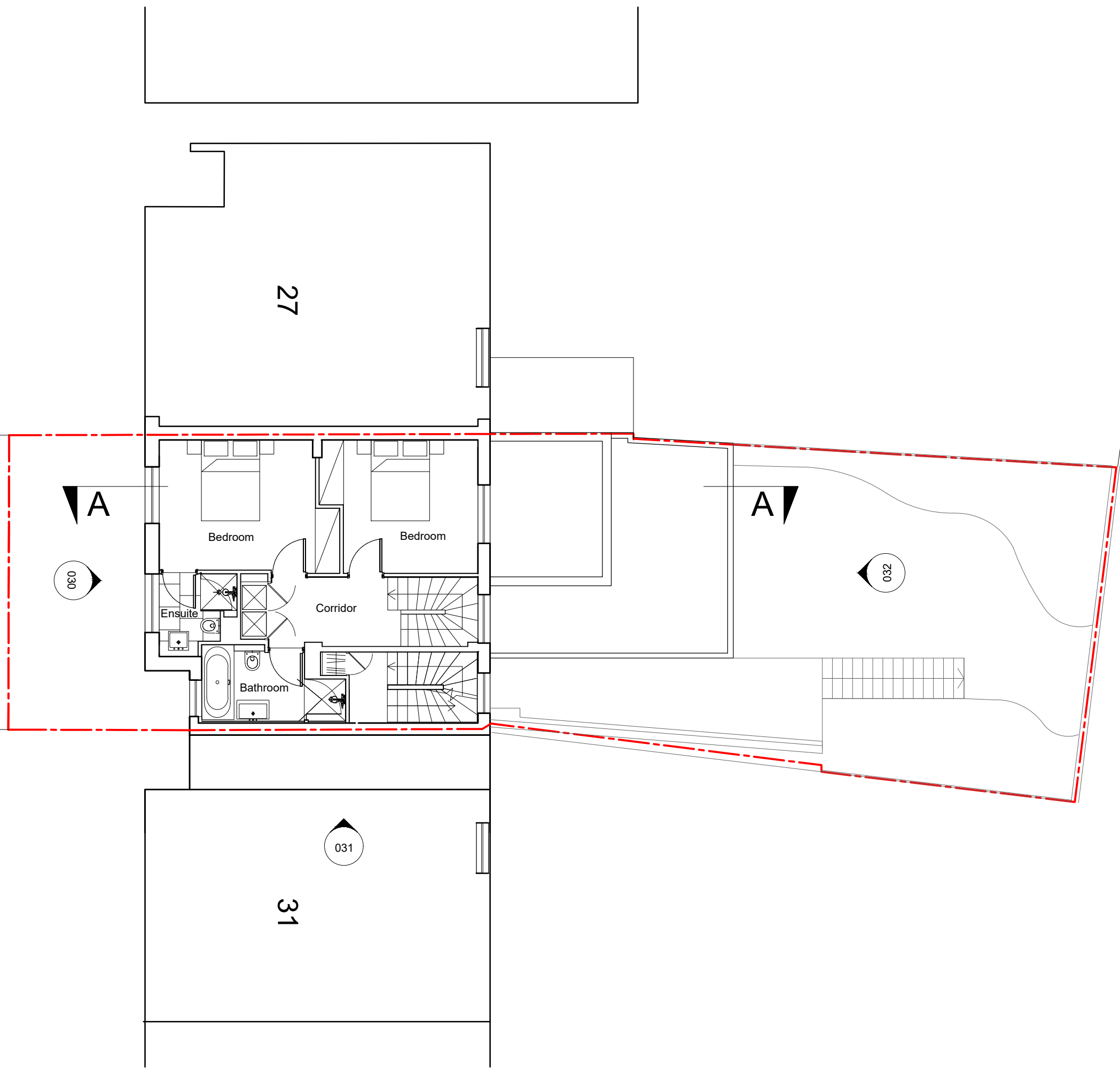

27 Prince of Wales Road

29 Prince of Wales Road

31 Prince of Wales Road



P1	11.12.20	Planning Issue
Rev	Date	Note

Services

Structures

Client
Nadav Kander & Nicole Verity

Project title
29 Prince of Wales Road

Drawing Title
Existing Second Floor Plan
Scale 1:100 @ A3

Project No.	Drawing no.	Revision
191	013	P1

Status	Date of Issue
Planning	11.12.20



Clive Sall Architecture Ltd.
2 Providence Yard
Ezra Street
London E2 7RJ
Copyright CLIVE SALL ARCHITECTURE LTD

