

Notes: New timber windows throughout to accomodate new wall thickness with insulated plasterboard.
Windows to be painted white externally to match existing.
60mm insulated plasterboard to be added to all internal faces of external walls
Timber ceiling to be made good where required and painted white

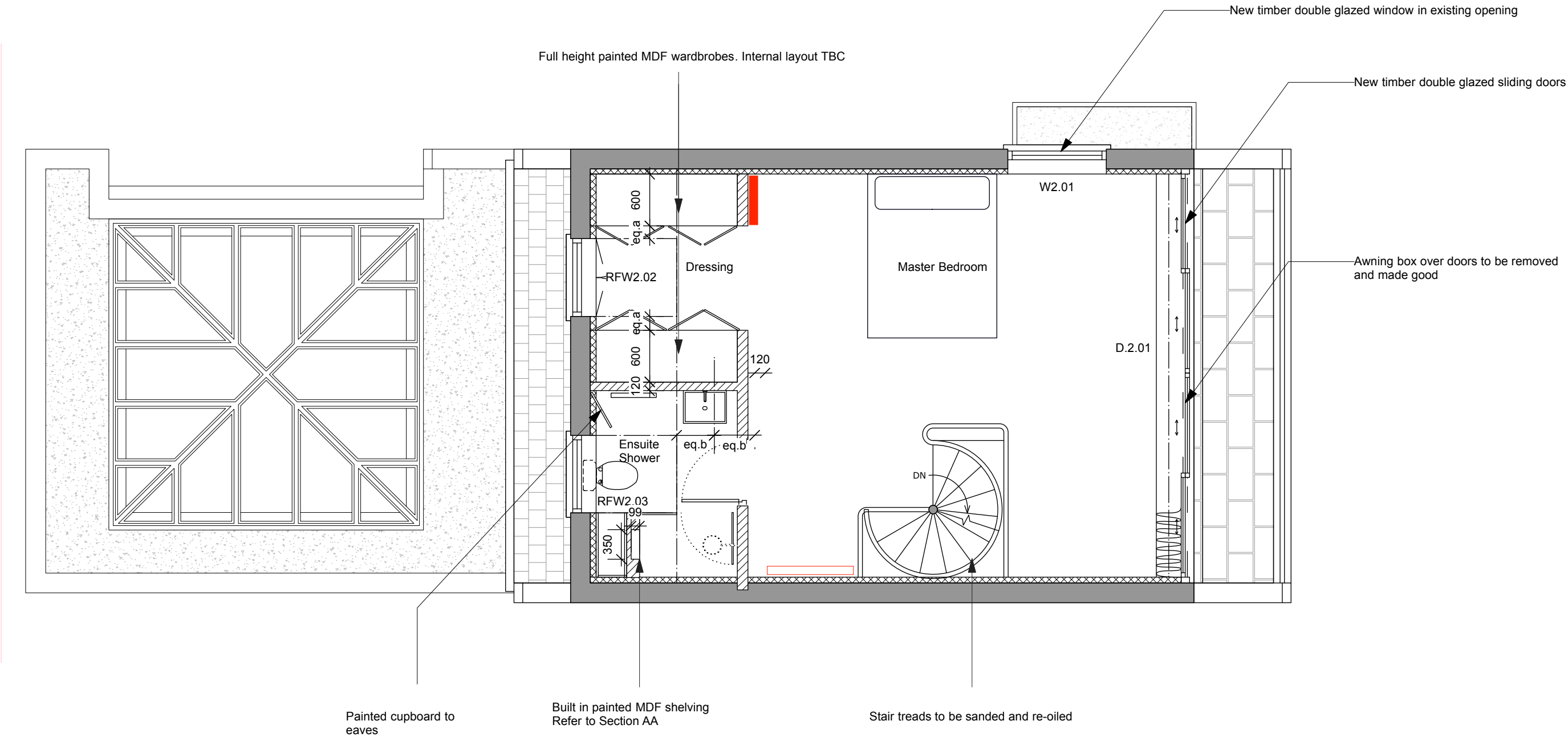

Revision			
A	21.09.20	Issued for Comment	14.10.20 Issued for Planning
B	27.09.20	Issued for Comment	18.11.20 Issued for Construction
C	01.10.20	Issued for Structural Engineer	

Notes:
All dimensions in millimetres.
In event of discrepancy contact architect for clarification prior to proceeding.

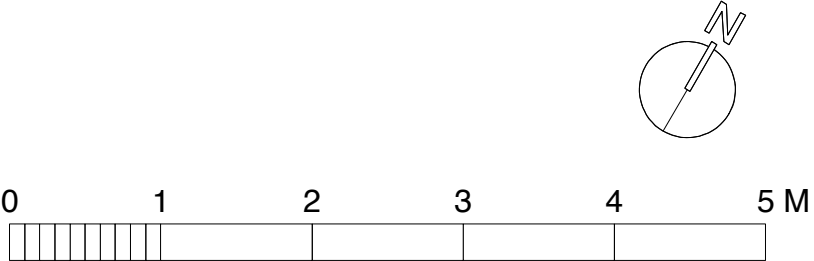

CLIENT PROJECT
DRAWING TITLE
DRAWING NUMBER
SCALE
DATE

Vanessa & Gabriel Grey-Hernandez
19 Torriano Cottages
Proposed Second Floor Option 02
L(00)03
1:50@A3
17.09.20

mwa

11 MELBOURNE ROAD LONDON E17 6LR
t: 07779 626845
e: melanie@melaniewhittingtonarchitects.com