

UCL South Quad - Pop-Up Learning Hub

Design and Access Statement : 27th November 2020



Contents

- 1.0 Project Overview
- 1.1 The Site
- 1.2 Application Context
- 1.3 Proposal
- 1.4 Design & Access
- 1.5 Principle for Development
- 1.6 Local Faculty Buildings
- 1.7 Plans
- 1.9 Elevations
- 2.0 Photograph of Existing

UCL South Quad - Pop-Up Learning Hub

Design and Access Statement : 27th November 2020

1.1 The Site

The existing Temporary Teaching Facility is located within the South Quad adjacent to the Anatomy Building. South Quad falls within the Bloomsbury Conservation Area.

The proposed site is not visible from any of the nearby streets and is enclosed on all four sides by buildings that are owned and occupied by UCL. The site is not designated as 'open space'.

The existing Temporary Teaching facility was erected and has continued to be occupied for teaching purposes since 2016 as a number of capital projects have been undertaken across the campus.



Site looking towards South Wing



Existing building looking towards Anatomy

1.2 Application Context

The facility has helped to alleviate pressure on existing teaching facilities on Central Campus during a number of refurbishment projects. However, a number of major capital projects for the Main Campus are now on hold and **retaining the current Temporary facilities is essential for the provision of socially distanced teaching space due to the 2020 Covid pandemic.**

1.3 Proposal

It is proposed that the existing facilities be retained **for a further 3 academic years** and continue to be used in a similar fashion.

1.4 Design & Access

As discussed with Camden Council officers, there is a requirement for social distanced teaching space.

1. The temporary building is two storeys high.
2. The external graphic is UCL branded, and will remain unaltered.
3. Access to the building is via shallow steps to the front, with a timber decking landing area outside the entrances. Due to the existing raised concrete plinths to the front of the facility, ramped access to the ground floor lecture theatre is provided via the side of the building.
4. The building is entirely temporary and will be removed without harming the area.

1.5 Principle for Development

The provision of new facilities for Higher Education institutions is supported in the Camden Local Plan 2017:

Policy C2 Community Facilities. The concentration of educational and research institutions in Central London is also strongly encouraged.

Policy G1 The Council will create the conditions for growth to deliver the homes, jobs, infrastructure and facilities to meet Camden's identified needs and harness the benefits for those who live and work in the borough.

Policy E1 - The Council will secure a successful and inclusive economy in Camden by creating the conditions for economic growth and harnessing the benefits for local residents and businesses.

Part (E) of Policy E1 supports the development of Camden's health and education sectors and promote the development of the Knowledge Quarter around Euston and King's Cross while ensuring that any new facilities meet the other strategic objectives of this Local Plan.

This structure will also continue to facilitate the wider strategic transformation of UCL's core Bloomsbury campus and will help to minimise the student learning experience during the pandemic. The proposal will therefore help support UCL's role as a key education and research institution in the borough.

LB Camden have previously acknowledged the intense pressure on existing teaching facilities and the need for temporary space.



1.6 Local Faculty Buildings/Users

The following faculties will benefit from the temporary teaching facilities:



Anatomy



Arts & Humanites

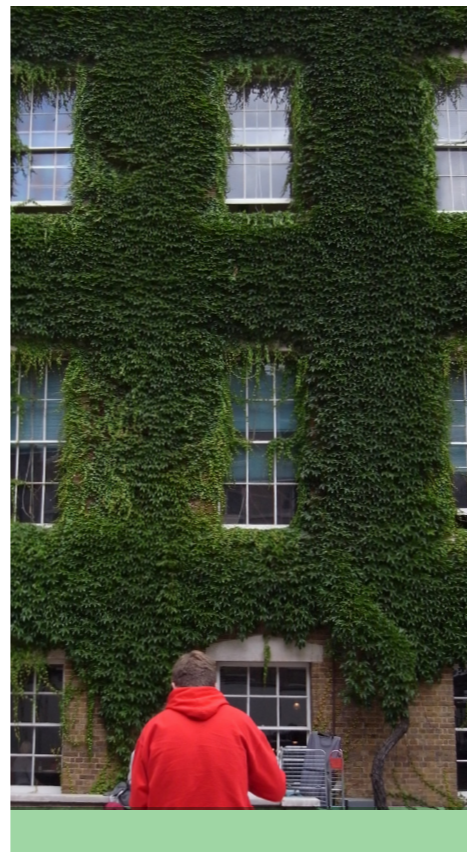

Wilkins South Wing



Medical Sciences



SU Print Room Cafe

1.7 Existing Plan to be retained : Ground Floor

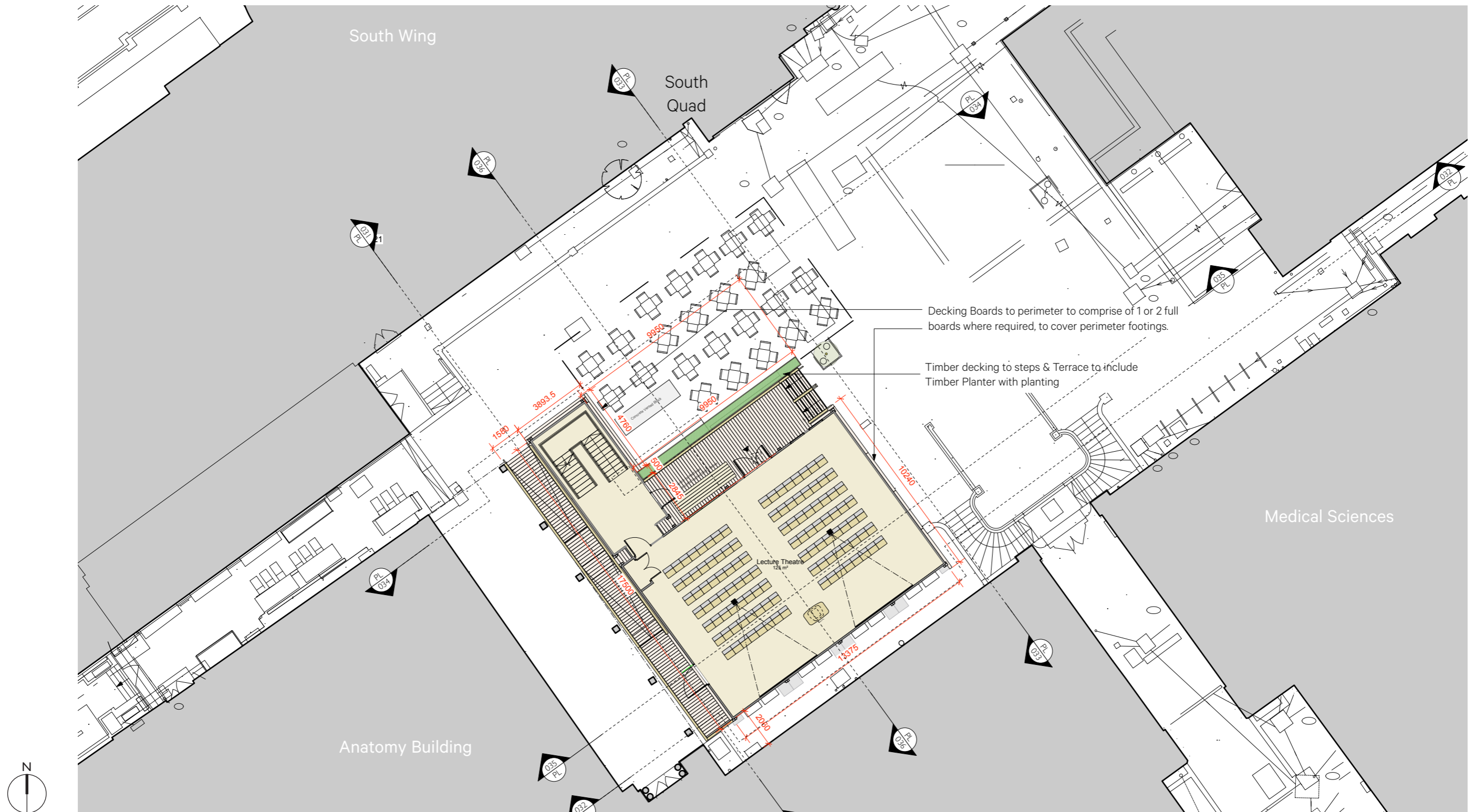

1.8 Existing Plan to be retained : First Floor



1.9 Existing Elevations: To be retained



South-East Elevation



South-West Elevation

For final layout of supergraphic see adjacent image (page 9)

2.0 Existing Temporary Facility

