

Tree Protection Plan

There are 8 trees located to the rear of 31 Daleham Gardens. These are shown within the associated Tree Location Plan (02/12/2020).

The trees on the site already benefit from a degree of protection through the provisions of the Town and Country Planning Act 1990, as the site is located within a Conservation Area. Therefore, any works to the trees would require the submission of a *Notification of proposed works to trees in a conservation area*. There are no works proposed to the trees in order to facilitate the demolition of the fire-damaged building.

As there is no construction proposed, only demolition, the provision of no-dig or sub-surface protection is not required in this instance. Traffic entering the site (either vehicular or on foot) will be diverted away from the RPA's.

The erection of protective fencing as per the figures outlined below will minimise any adverse effect and/or impact on the trees. This protective fencing will be used on any trees that may be impacted by the demolition.

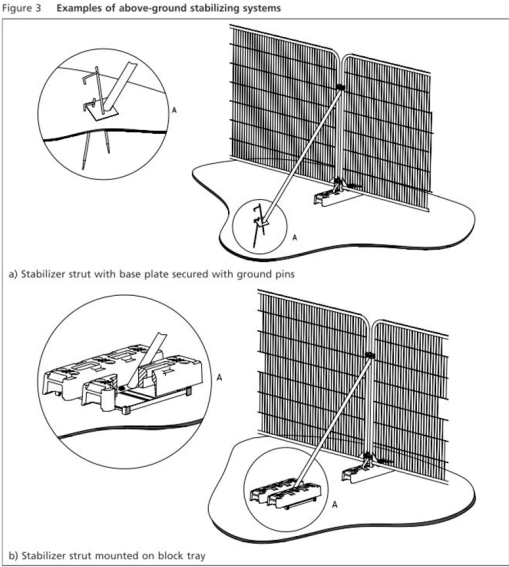
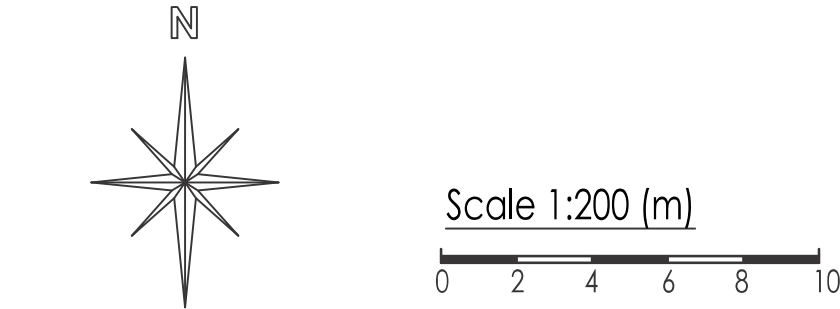
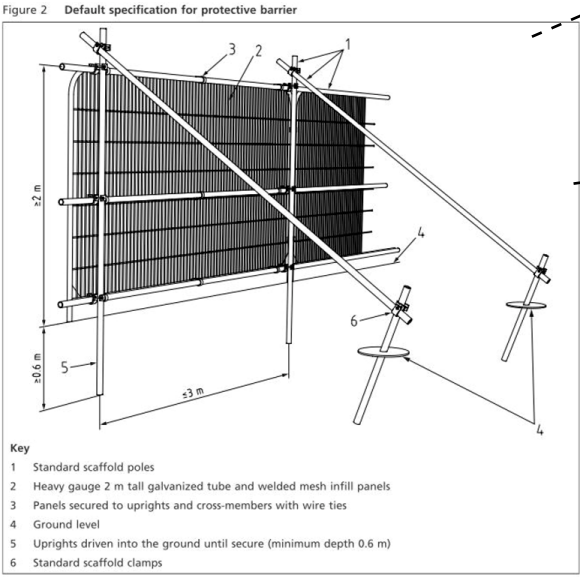
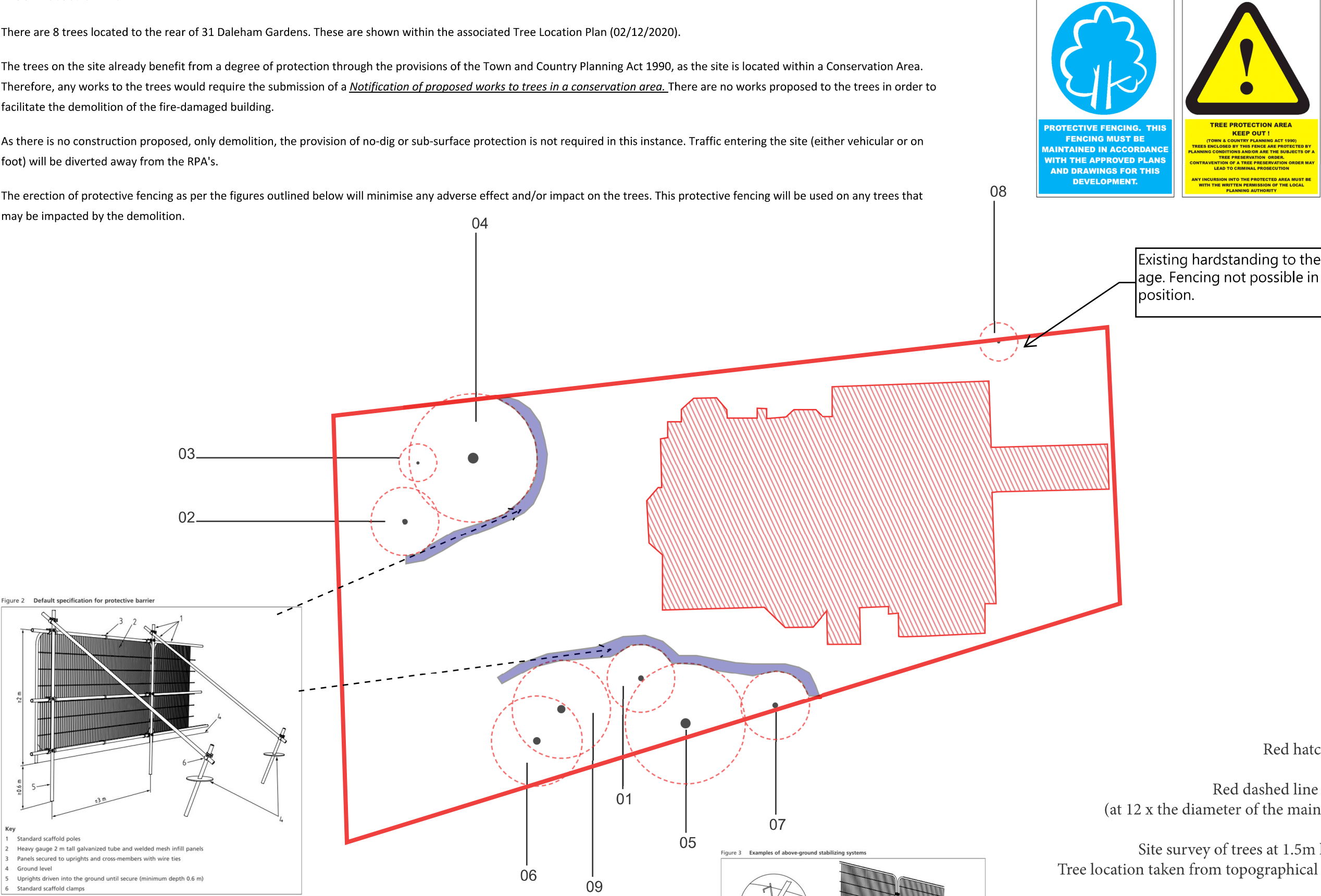

Key	Tree Type
01	Ilex aquifolium
02	Sambucus nigra
03	Magnolia- unidentified species
04	Acer pseudoplatanus
05	Prunus unidentified species
06	Salix caprea
07	Sambucus nigra
08	Unknown
09	Unknown (topo identifies as bush)

Red hatch indicates extent of proposed demolition

Red dashed line indicates placement of the tree protection (at 12 x the diameter of the main stem measured 1.5m above ground level)

Site survey of trees at 1.5m h above ground level undertaken 08.12.20
Tree location taken from topographical survey by Whymark & Moulton Feb 2020

To be read inconjunction with Tree Location Plan

Location of protective barriers
Placement of Tree Protection Plan
31 Daleham Gardens, NW3
08/12/2020

