

Copyright: All rights reserved. This drawing must not be reproduced without permission.

Only the original drawing should be relied upon. Contractors, sub-contractors and suppliers must verify all dimensions on site before commencing any work or making any shop drawings.

All shop drawings to be submitted to the architect / interior designer for comment prior to fabrication.

This drawing is to be read in conjunction with the architect's / interior designer's specification, bills of quantities / schedules, structural, mechanical & electrical drawings and all discrepancies are to be reported to the architect / interior designer.

Do not scale from this drawing. Dimensions are in millimetres unless otherwise stated.

NOTES

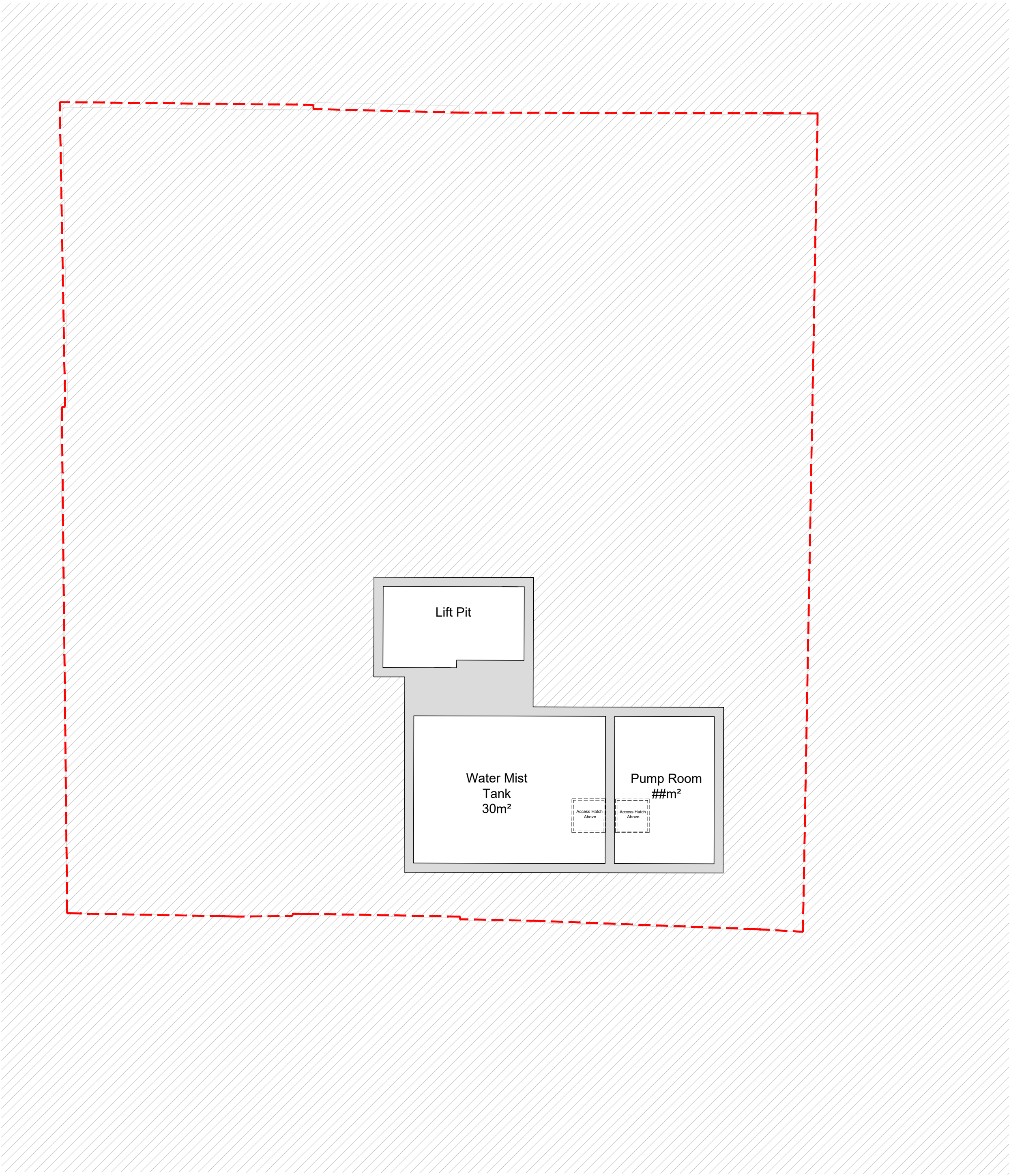

Proposed Basement -2 Floor Plan  
1:100

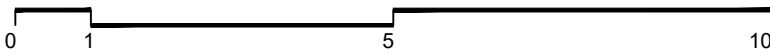

P0 ISSUED FOR PLANNING		20.11.20	FJ	PW
rev	amendments	date	by	chk
<b>dexter moren associates</b> architecture urban design interior design creative media <a href="http://www.dextermoren.com">www.dextermoren.com</a> <a href="mailto:dmaj@dextermoren.com">dmaj@dextermoren.com</a>		57d jamestown road london nw1 7db UK  t: 020 7267 4440		
architecture				
project Bayham Street London, NW1 0EY				
client Camden Lifestyle (UK) Ltd				
drawing title Proposed Basement -2 Floor Plan				
drawing status PLANNING				
scale	date	drawn by		
1:100 @ A1	20.11.20	FJ		
1:200 @ A3				
job no.	drawing no.	revision		
1783	A-100-097	P0		