

Appendix A

DRAFT

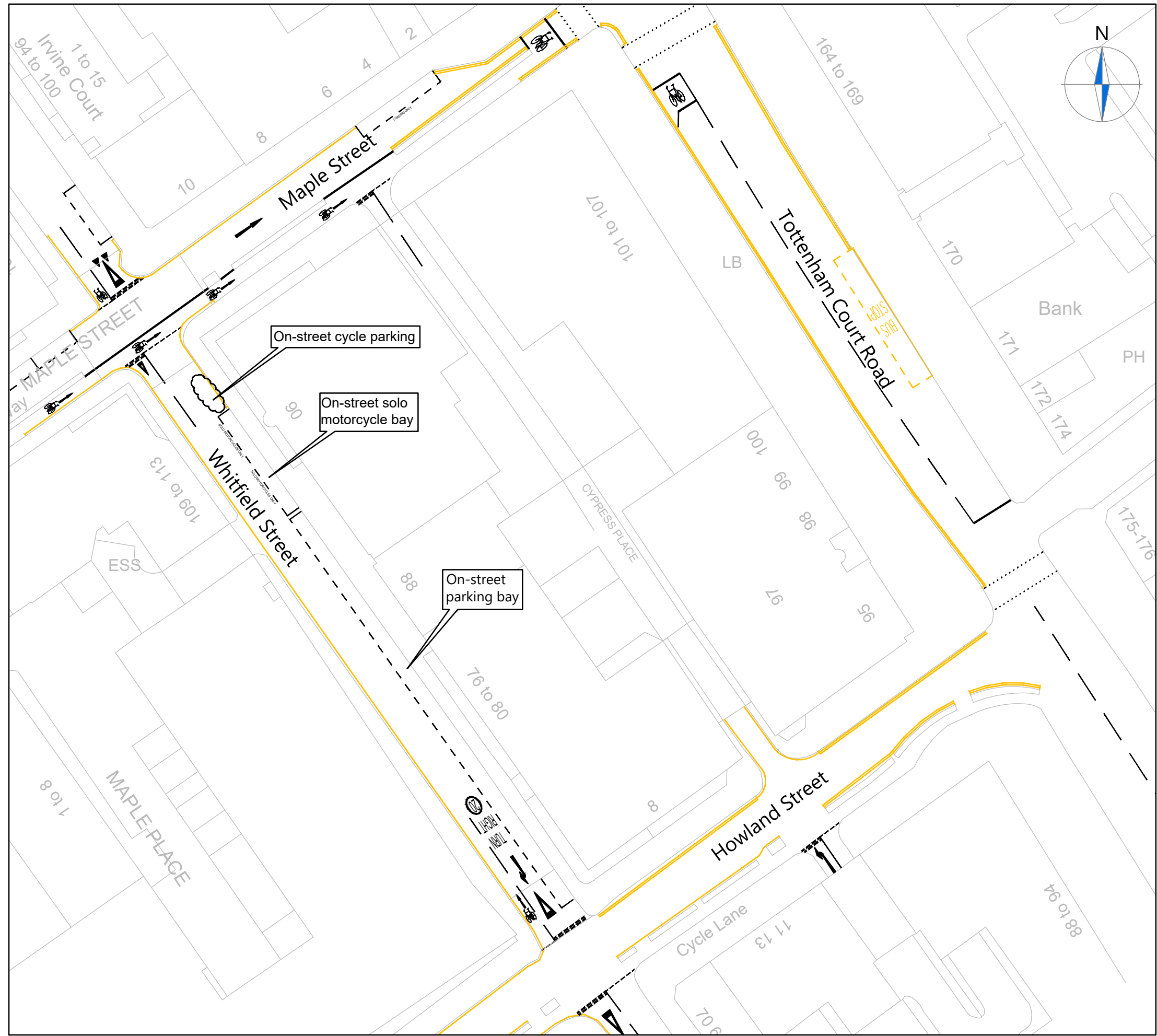

NOTES

1. Do not scale from this drawing.
2. This drawing to be read & printed in colour.
3. This drawing is for illustrative purposes only.

Rev	Details	REVISION HISTORY			Drawn	Checked	Date
Status:	<input type="checkbox"/> Preliminary	<input type="checkbox"/> For Approval	<input type="checkbox"/> For Construction	<input checked="" type="checkbox"/> For Information	<input type="checkbox"/> For Tender	<input type="checkbox"/> As Built	

Client:
Derwent Valley Property Development Limited

Project:
Network Building

Drawing Title:
Existing Highway Arrangement

Scale: 1:500 Size: A3

Drawn by: COS Checked by: AFG Date: 30.10.2020

CANEPARO ASSOCIATES
Transport Planning & Highway Design
21 Little Portland Street • London • W1W 8BT • Tel. 020 3617 8200

Scheme Ref: CA4312 Drawing No: 001 Sheet: 1 of 1 Rev: ...

Appendix B

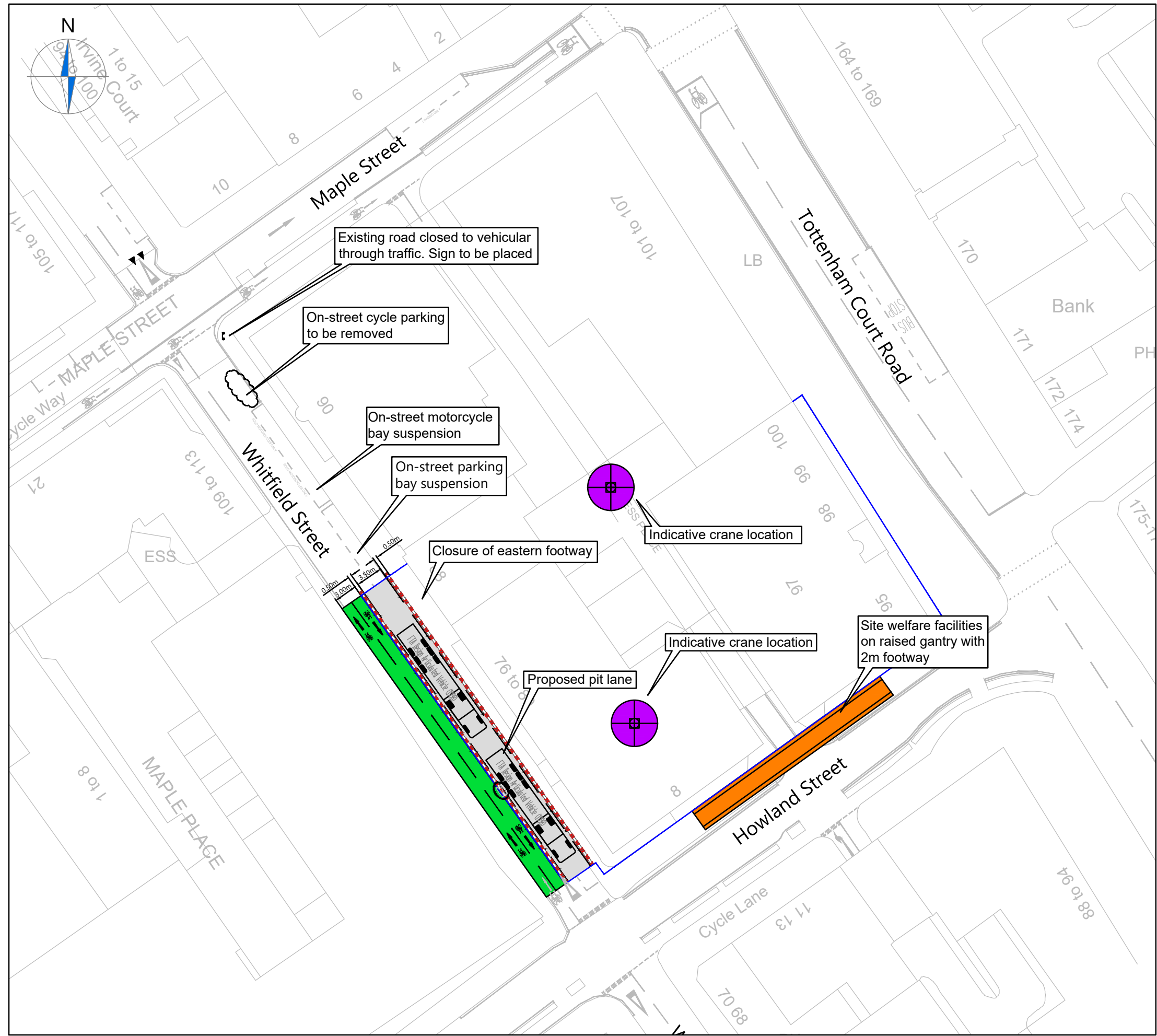

DRAFT



NOTES

1. Do not scale from this drawing.
2. This drawing to be read & printed in colour.
3. This drawing is for illustrative purposes only.

KEY:

	Site Hoarding
	Cycle Lane
	Pit Lane
	Welfare Facilities

Rev	Details	REVISION HISTORY			Drawn	Checked	Date
Status:	<input type="checkbox"/> Preliminary	<input type="checkbox"/> For Approval	<input type="checkbox"/> For Construction				
	<input checked="" type="checkbox"/> For Information	<input type="checkbox"/> For Tender	<input type="checkbox"/> As Built				

Client: **Derwent Valley Property Development Limited**

Project: **Network Building**

Drawing Title: **Construction Management Plan
Site Arrangement Plan**

Scale: **1:500** Size: **A3**

Drawn by: **AFG** Checked by: **AS** Date: **30.10.2020**

CANEPARO ASSOCIATES
Transport Planning & Highway Design
21 Little Portland Street • London • W1W 8BT • Tel. 020 3617 8200

Scheme Ref: **CA4312** Drawing No: **0002** Sheet: **1 of 1** Rev: **...**

Appendix C

DRAFT

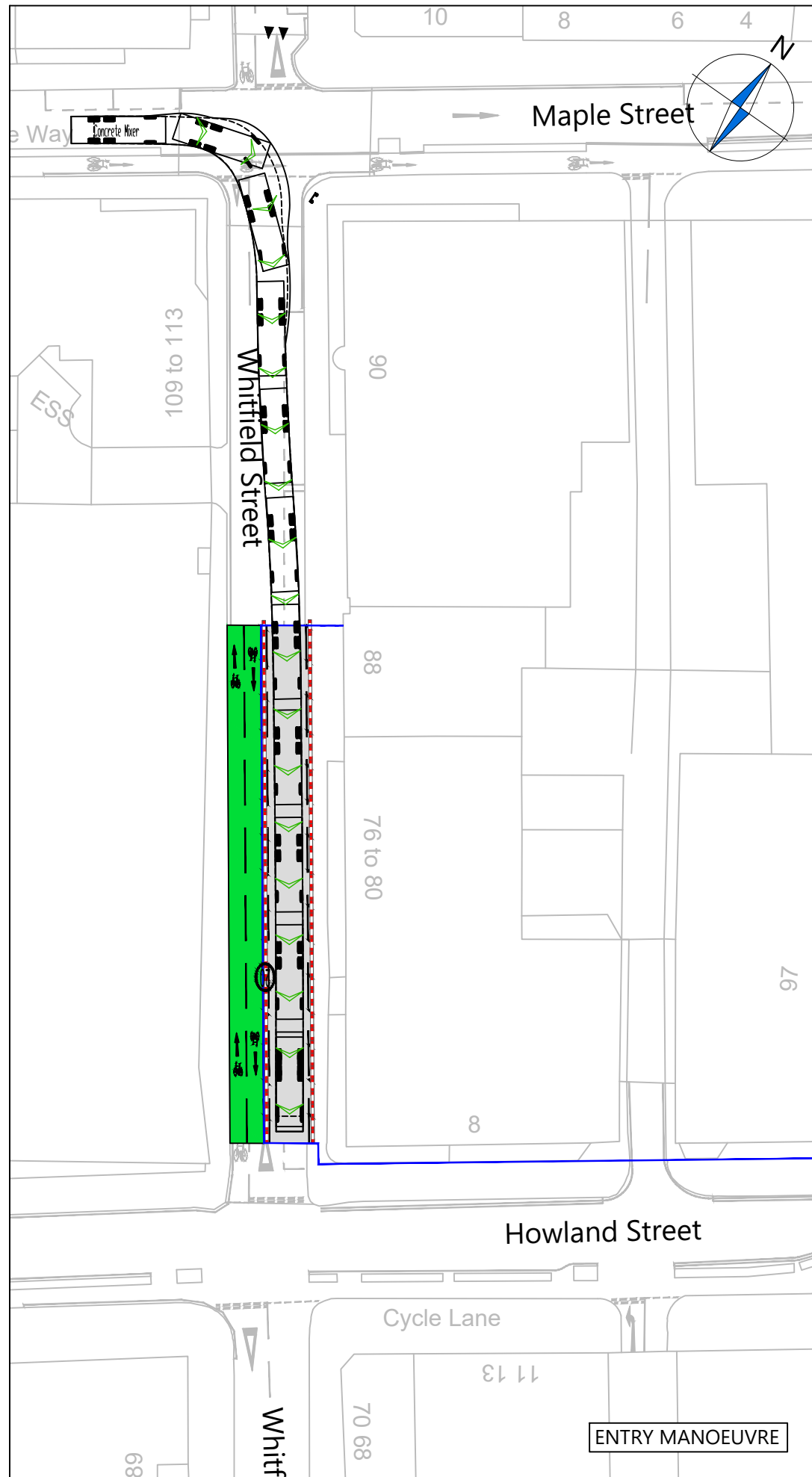

ENTRY MANOEUVRE

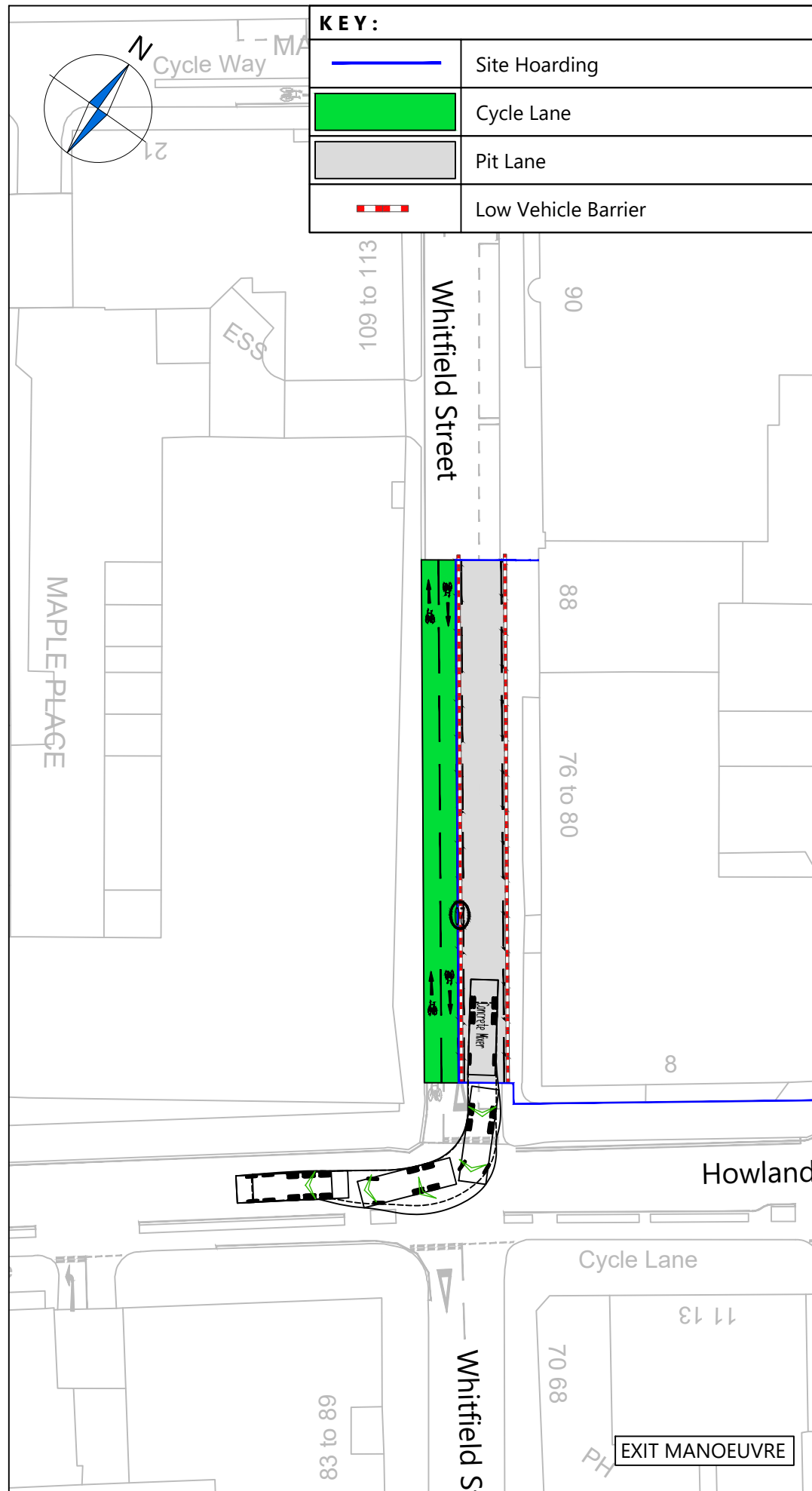

EXIT MANOEUVRE

KEY:

	Site Hoarding
	Cycle Lane
	Pit Lane
	Low Vehicle Barrier

NOTES

1. Do not scale from this drawing.
2. This drawing to be read & printed in colour.
3. This drawing is for illustrative purposes only.

CONCRETE MIXER

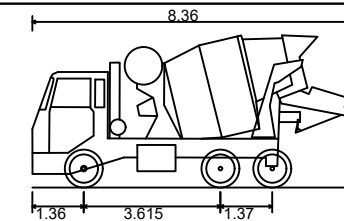

Overall Length	8.360m
Overall Width	2.390m
Overall Body Height	4.027m
Min Body Ground Clearance	0.358m
Max Track Width	2.413m
Lock to Lock Time	6.00s
Kerb to Kerb Turning Radius	8.210m

FORWARD MOVEMENTS ARE SHOWN IN BLACK (design speed - 5kph)

REVERSE MOVEMENTS ARE SHOWN IN BLUE (design speed - 2.5kph)

Rev	Details	REVISION HISTORY			Drawn	Checked	Date
Status: <input type="checkbox"/> Preliminary <input type="checkbox"/> For Approval <input type="checkbox"/> For Construction <input checked="" type="checkbox"/> For Information <input type="checkbox"/> For Tender <input type="checkbox"/> As Built							

Client: Derwent Valley Property Development Limited

Project: Network Building

Drawing Title: Vehicle Swept Path Analysis of a Concrete Mixer

Scale: 1:500 Size: A3

Drawn by: AFG Checked by: AS Date: 30.10.2020

CANEPARO ASSOCIATES
Transport Planning & Highway Design
21 Little Portland Street • London • W1W 8BT • Tel. 020 3617 8200

Scheme Ref: CA4312	Drawing No: TR009	Sheet: 1 of 3	Rev: ...
--------------------	-------------------	---------------	----------

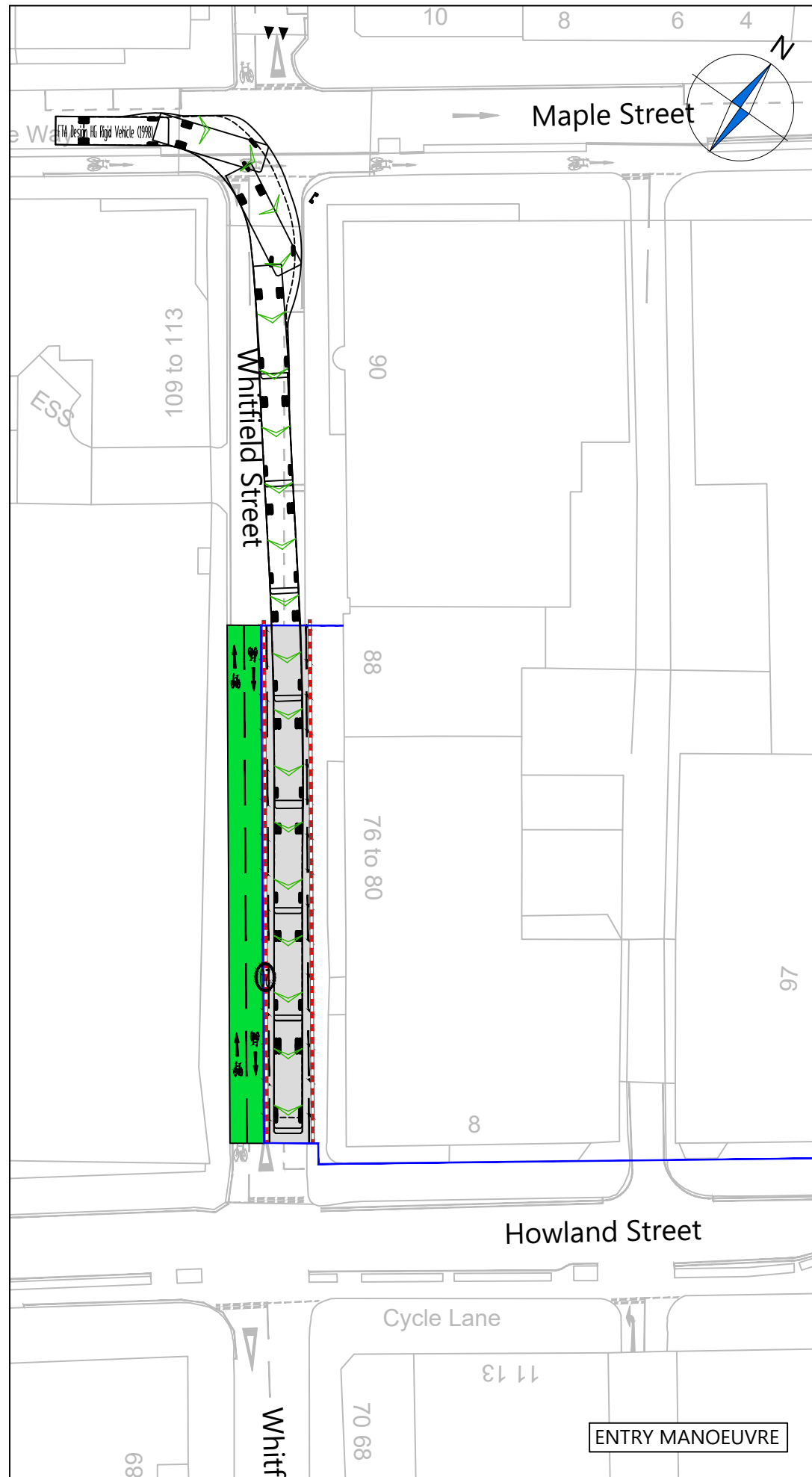

ENTRY MANOEUVRE

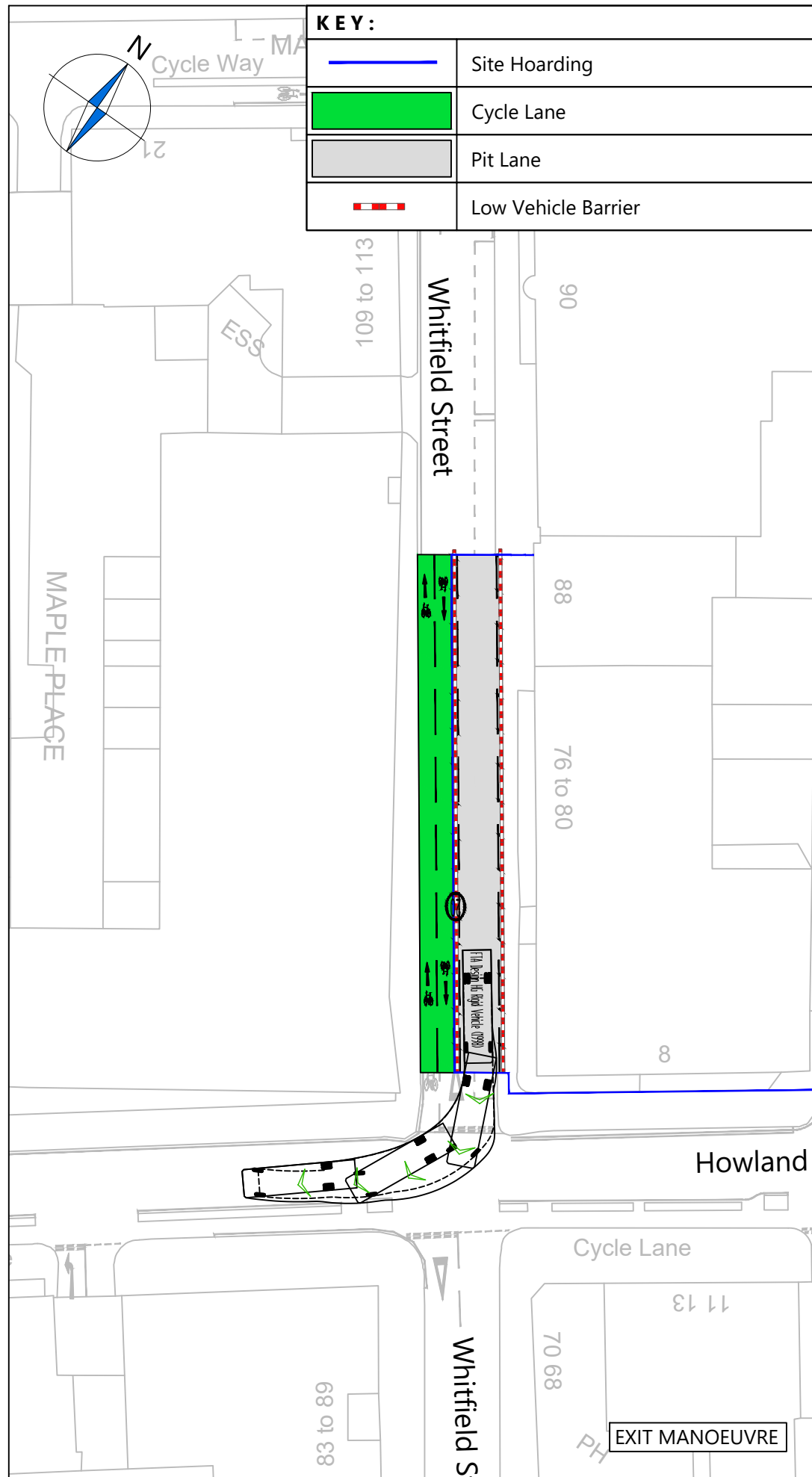

EXIT MANOEUVRE

KEY:

	Site Hoarding
	Cycle Lane
	Pit Lane
	Low Vehicle Barrier

NOTES

1. Do not scale from this drawing.
2. This drawing to be read & printed in colour.
3. This drawing is for illustrative purposes only.

FTA DESIGN HG RIGID VEHICLE (1998)

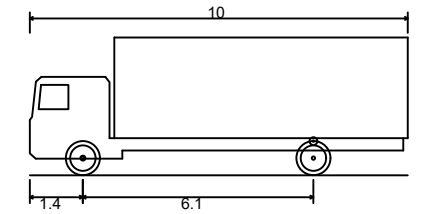

Overall Length	10.000m
Overall Width	2.500m
Overall Body Height	3.645m
Min Body Ground Clearance	0.440m
Track Width	2.470m
Lock to Lock Time	3.00s
Kerb to Kerb Turning Radius	11.000m

- FORWARD MOVEMENTS ARE SHOWN IN BLACK (*design speed - 5kph*)
- REVERSE MOVEMENTS ARE SHOWN IN BLUE (*design speed - 2.5kph*)

Rev	Details	REVISION HISTORY			Drawn	Checked	Date
Status: <input type="checkbox"/> Preliminary <input type="checkbox"/> For Approval <input type="checkbox"/> For Construction <input checked="" type="checkbox"/> For Information <input type="checkbox"/> For Tender <input type="checkbox"/> As Built							

Client: **Derwent Valley Property Development Limited**

Project: **Network Building**

Drawing Title: **Vehicle Swept Path Analysis of FTA HG Rigid Vehicle**

Scale: **1:500** Size: **A3**

Drawn by: **AFG** Checked by: **AS** Date: **30.10.2020**

CANEPARO ASSOCIATES
Transport Planning & Highway Design
21 Little Portland Street • London • W1W 8BT • Tel. 020 3617 8200

Scheme Ref:	Drawing No:	Sheet :	Rev:
CA4312	TR009	2 of 3	...

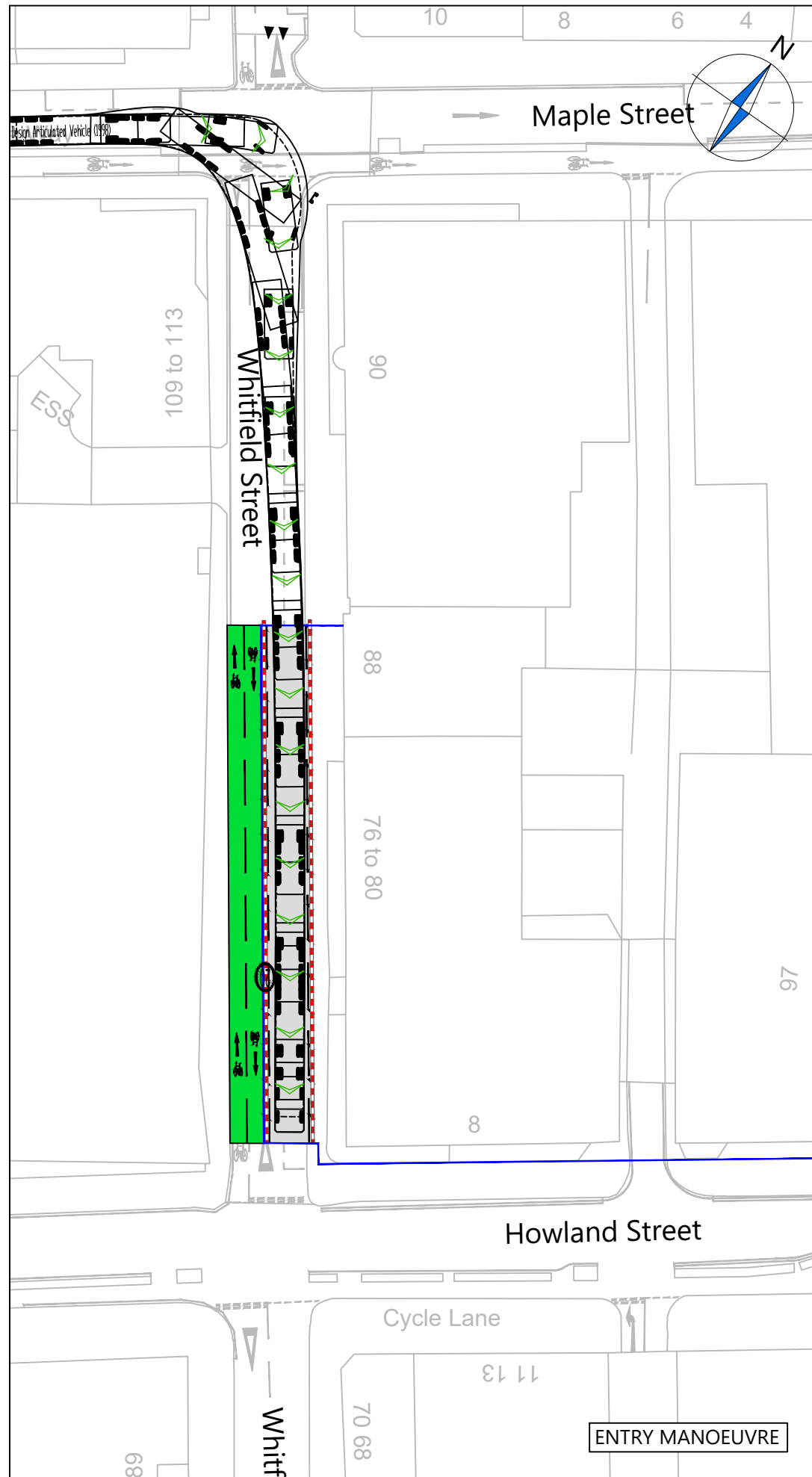

ENTRY MANOEUVRE

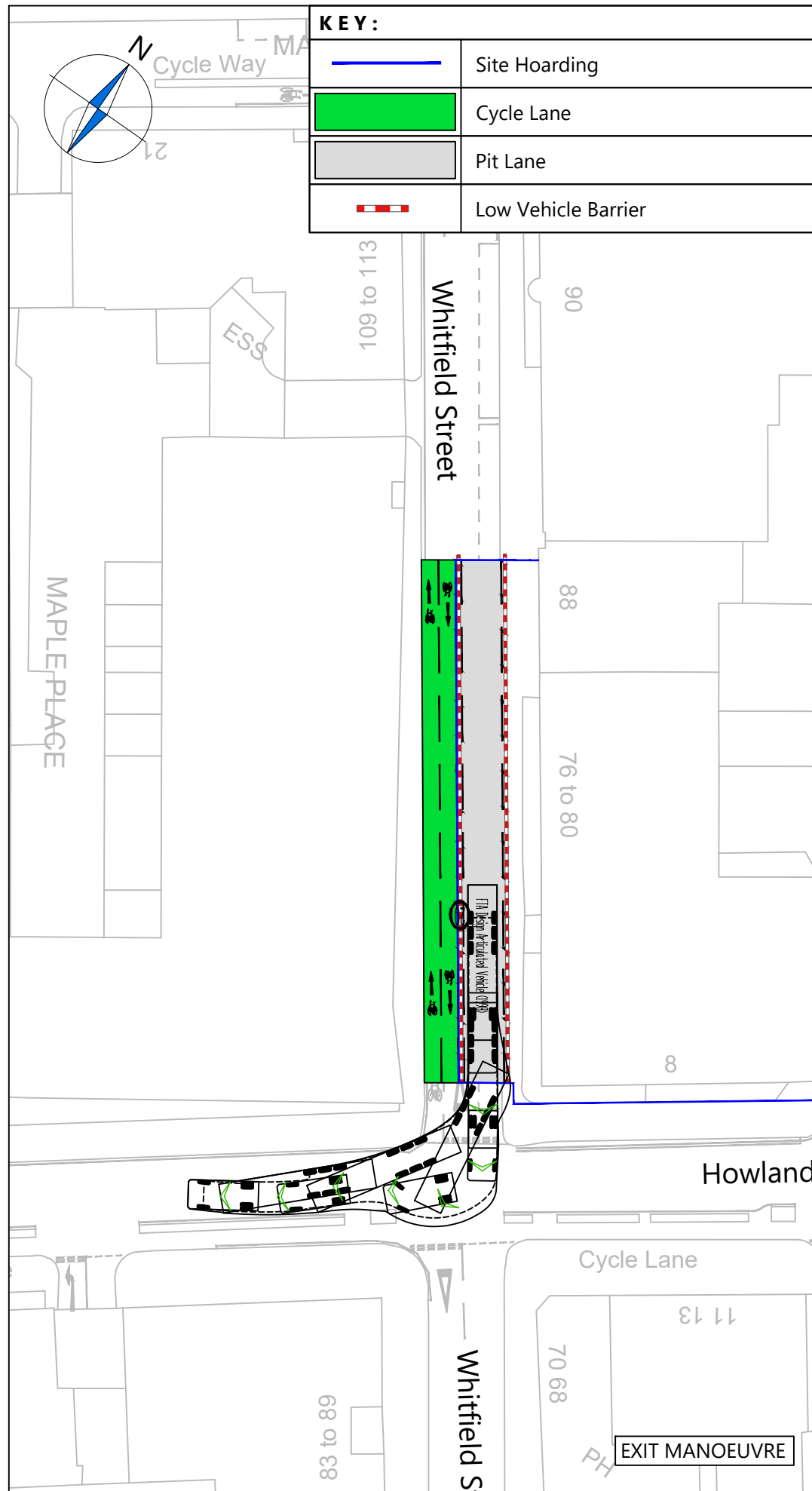

EXIT MANOEUVRE

KEY:

	Site Hoarding
	Cycle Lane
	Pit Lane
	Low Vehicle Barrier

NOTES

1. Do not scale from this drawing.
2. This drawing to be read & printed in colour.
3. This drawing is for illustrative purposes only.

FTA DESIGN ARTICULATED VEHICLE (1998)

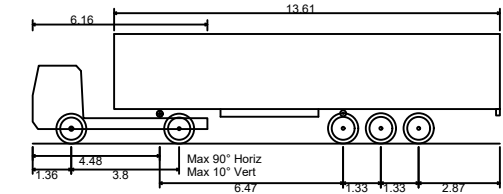

Overall Length	16.480m
Overall Width	2.550m
Overall Body Height	3.870m
Min Body Ground Clearance	0.515m
Max Track Width	2.470m
Lock to Lock Time	3.00s
Kerb to Kerb Turning Radius	6.550m

FORWARD MOVEMENTS ARE SHOWN IN BLACK (design speed - 5kph)

REVERSE MOVEMENTS ARE SHOWN IN BLUE (design speed - 2.5kph)

Rev	Details	REVISION HISTORY			Drawn	Checked	Date
Status: <input type="checkbox"/> Preliminary <input type="checkbox"/> For Approval <input type="checkbox"/> For Construction <input checked="" type="checkbox"/> For Information <input type="checkbox"/> For Tender <input type="checkbox"/> As Built							

Client: **Derwent Valley Property Development Limited**

Project: **Network Building**

Drawing Title: **Vehicle Swept Path Analysis of FTA Design Articulated Vehicle**

Scale: **1:500** Size: **A3**

Drawn by: **AFG** Checked by: **AS** Date: **30.10.2020**



21 Little Portland Street • London • W1W 8BT • Tel. 020 3617 8200

Scheme Ref:	Drawing No:	Sheet :	Rev:
CA4312	TR009	3 of 3	...