

01
2001

First Floor - Existing Plan and Proposed Removal of Unconsented Work
1:50 @ A1

02
2001

First Floor - Proposed Regularisation and Corrective Work
1:50 @ A1

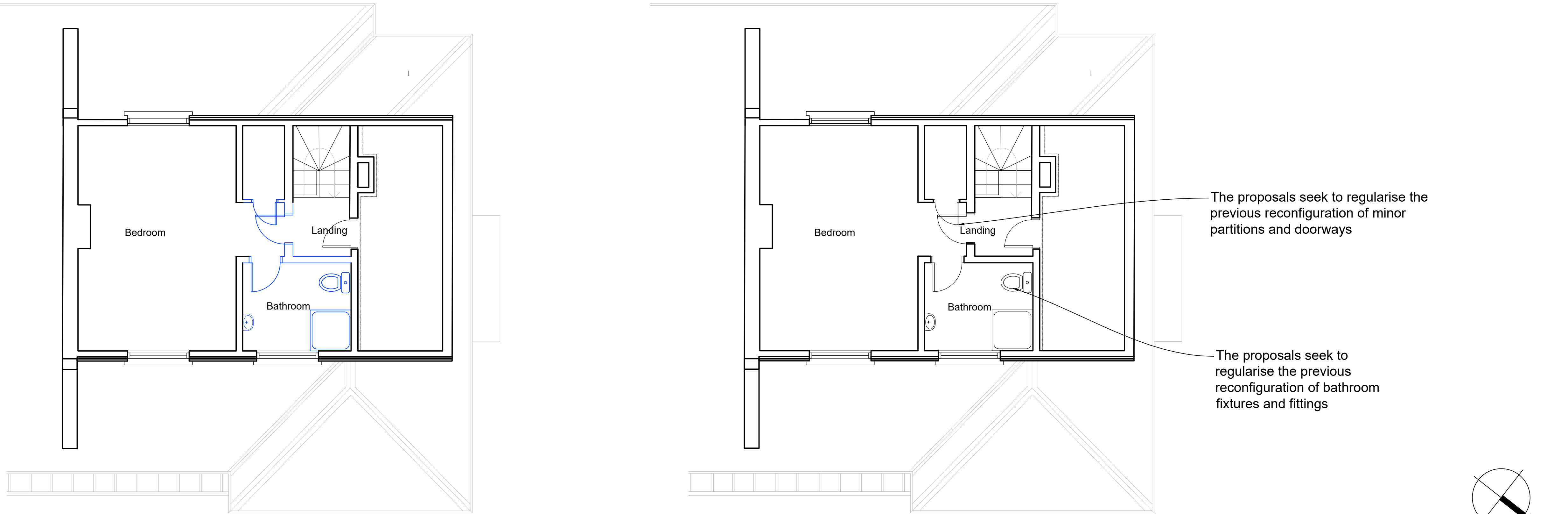

03
2001

Second Floor - Existing Plan and Proposed Removal of Unconsented Work
1:50 @ A1

04
2001

Second Floor - Proposed Regularisation and Corrective Work
1:50 @ A1

GENERAL NOTES

- Based on survey data received from client.
- Modern glazed doors have been replaced with painted panelled doors generally.

GENERAL NOTES

- Read all drawings in conjunction with associated specification, schedules and drawings.
- Read all the notes on this drawing.
- Based on survey information by others.

HATCH KEY

Document to be printed/read in colour only.

- Fabric implemented as part of unconsented works, which this application seeks to regularise
- Fabric implemented as part of unconsented works, which this application seeks to remove
- New fabric proposed as part of corrective and regularisation work
- Existing Fabric
- Assumed line of existing structure

Notes

- Any dwg format drawing is to be read in conjunction with and at the scale of the accompanying pdf.
- Where colours other than black or grey are used, the drawing must be plotted in colour.
- For status 'C' (Construction) drawings all dimensions are to be checked on site by the contractor, scaling is for Local Authority purposes only.
- Unless otherwise indicated, all dimensions are in millimeters.
- All information on this drawing is to be read in conjunction with the relevant Donald Insall Associates specification and trade contractors' drawings and information by specialists.
- In the event of any discrepancy, please contact us immediately.
- This drawing may contain survey information by others and is to be used solely for the purposes for which it was issued.
- These are uncontrolled documents issued for information purposes only. If you have any queries regarding the drawings, please contact DIA immediately. Please note DIA cannot be held responsible for any errors arising from changes made to an uncontrolled dwg file.
- Please note DIA cannot be held responsible for any errors arising from changes made to an uncontrolled dwg file.

© 2017 DONALD INSALL ASSOCIATES LTD

Drawing Status					
F	Feasibility	B	Building Control	T	Tender
S	Sketch Design	D	Developed Design	C	Construction
P	Planning	M	Measurement	R	Record

Rev	Date	Dwn	Auth	Revision
02	19.11.2020	GXH	RMD	Client Issue
01	16.11.2020	GXH	RMD	Revised to match site conditions
00	29.09.2020	GXH	RMD	Submitted for Listed Building Consent

26 Park Village East
London

First and Second Floor Plans

Project	PVE26.02	No	2001
Scale (A1)	1:50	Status	3P
		Revision	02

Donald Insall Associates
Chartered Architects and Historic Building Consultants

12 Devonshire Street, London W1G 7AB
(+44) 020 7245 9888
london@insall-architects.co.uk