

This drawing is to be read in conjunction with all relevant architects, engineers and specialists drawings and specifications. Do not scale from this drawing.

rev	date	by	chk	description
P1	05/09/19	LG	JG	Preliminary

COVER: 75mm TO U/S OF UNDERPIN AND 50mm ELSEWHERE  
Lap Lengths: H16 - 650mm, H20 - 875mm  
CONCRETE TO BE GRADE C35/45

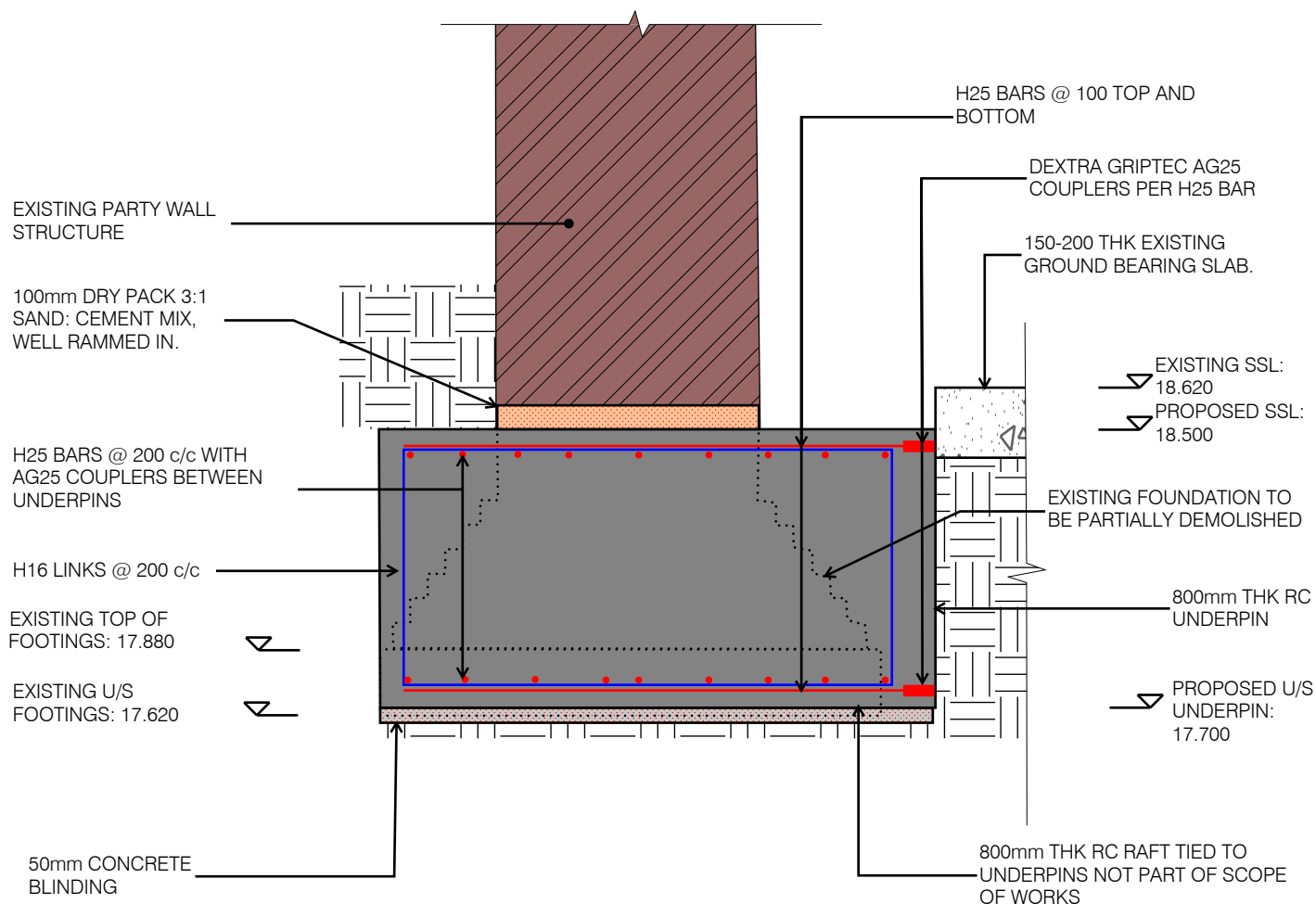

**Enabling Works Detail**  
**1:20**

**Drawing title**

Enabling Works Underpin Detail

**elliottwood**

Elliott Wood Partnership Ltd  
Central London • Wimbledon • Nottingham  
Consulting Structural and Civil Engineers  
(020) 7499 5888 • [elliottwood.co.uk](http://elliottwood.co.uk)

**Project**

Kingsway House Enabling Works

**Drawing status**

Preliminary

**Status**

S2

**Revision**

P1

**Scale**

1:50@ A4

**Date**

September 2019

**Drawn**

LGa

**Project no.**

213461

**Originator**

-EWP - ZZ - 00 - SK - S - 0018

**Zone**

-EWP - ZZ - 00 - SK - S - 0018

**Level**

-EWP - ZZ - 00 - SK - S - 0018

**Type**

-EWP - ZZ - 00 - SK - S - 0018

**Role**

-EWP - ZZ - 00 - SK - S - 0018

**drg no.**

-EWP - ZZ - 00 - SK - S - 0018