

Existing Basement

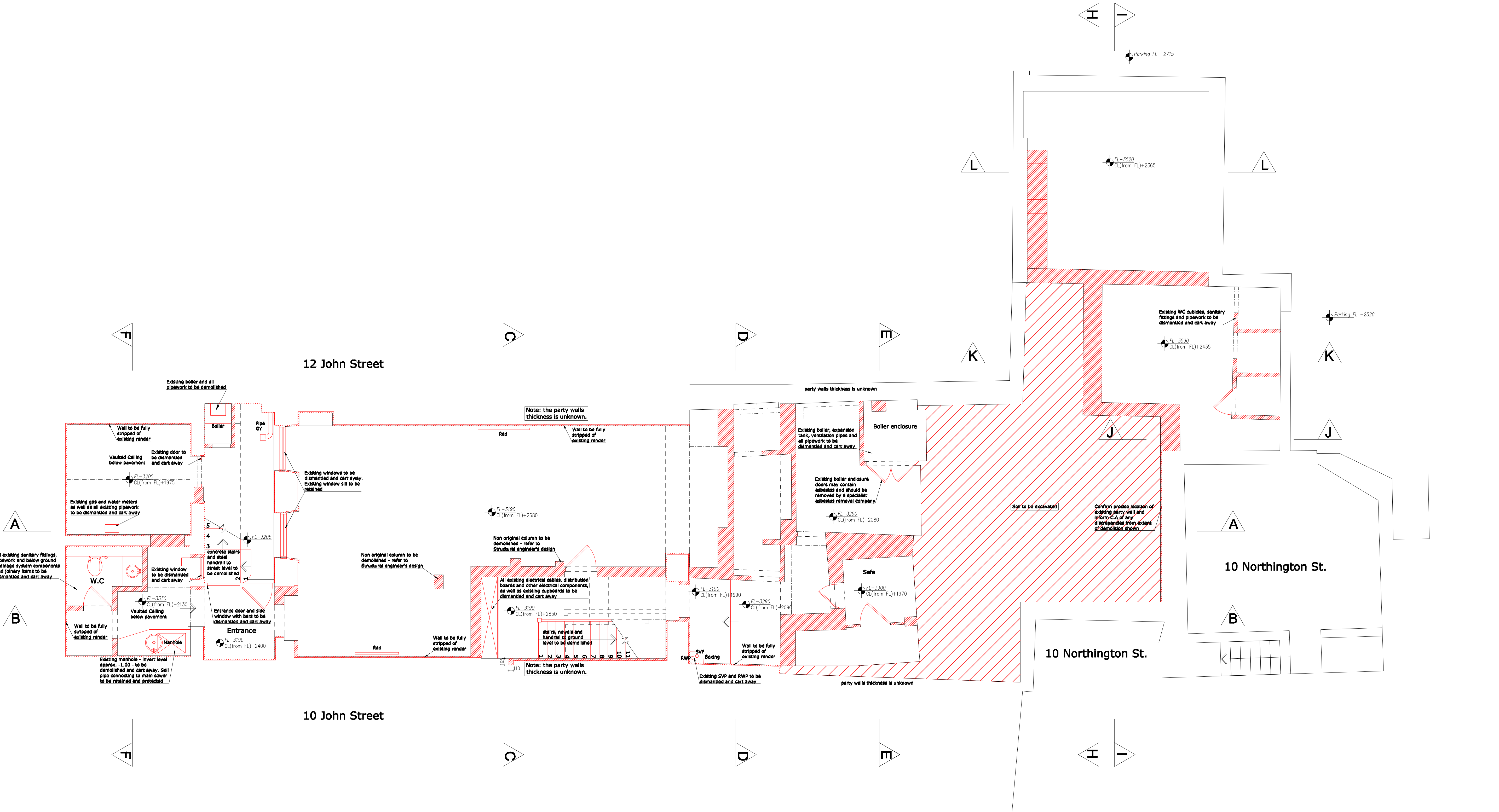

Project:
The Clockhouse, 11 John Street,
WC1N 2EB

0 1 2

Client: Mr. Ian Rosenfeld & Ms. Marianna Segato
Scale: 1:50 Size: A1
Date: October 2020 Drawing No: A_310
Title: L -01_Enabling plan

Architects

extrArchitecture

General Notes
Do not scale drawings. Dimensions govern. All dimensions shall be verified on site before proceeding with the work. All dimensions are in millimetres unless noted otherwise. extrArchitecture shall be notified in writing of any discrepancies.
All areas indicated on this sheet are approximate and indicative only. They are not to be relied upon. If the client or any other party requires precise measurements it is to engage specialist advice for that purpose.

Rev.	Date	Reason For Issue
00	04/18	Scheme Design
01	09/20	No Basement excavation