

Title Number : NGL412707

This title is dealt with by HM Land Registry, Croydon Office.

The following extract contains information taken from the register of the above title number. A full copy of the register accompanies this document and you should read that in order to be sure that these brief details are complete.

Neither this extract nor the full copy is an 'Official Copy' of the register. An official copy of the register is admissible in evidence in a court to the same extent as the original. A person is entitled to be indemnified by the registrar if he or she suffers loss by reason of a mistake in an official copy.

This extract shows information current on 13 OCT 2020 at 12:33:03 and so does not take account of any application made after that time even if pending in HM Land Registry when this extract was issued.

REGISTER EXTRACT

| | |
|---------------------|--|
| Title Number | : NGL412707 |
| Address of Property | : 136-138 Kentish Town Road, London (NW1 9QB) |
| Price Stated | : Not Available |
| Registered Owner(s) | : T + P HOLDINGS LIMITED (Co. Regn. No. 1717778) of 136 Kentish Town Road, London NW1 9QB and of Unit 2, 53 Hargrave Road, London N19 5SH. |
| Lender(s) | : None |

This is a true copy of the document consisting of 4 pages and referred to as EXHIBIT PA1 in the statement of Philip Andrews

Signed 

Name: PHILIP ANDREW

Date 10/11/2020

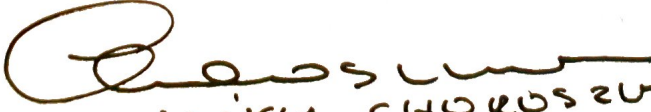
Witness: 
Date DONIMIKA CHOROSZUWA
10/11/2020

This is a copy of the register of the title number set out immediately above. The entries in the register on 13 OCT 2020 at 12:33:03. This copy does not take account of any application made after that time even if still pending in HM Land Registry when this copy was issued.

This copy is not an 'Official Copy' of the register. An official copy of the register is admissible in evidence in a court to the same extent as the original. A person is entitled to be indemnified by the registrar if he or she suffers loss by reason of a mistake in an official copy. If you want to obtain an official copy, the HM Land Registry web site explains how to do this.

A: Property Register

This register describes the land and estate comprised in the title.

CAMDEN

- 1 (23.06.1981) The Freehold land shown edged with red on the plan of the above Title filed at the Registry and being 136-138 Kentish Town Road, London (NW1 9QB).
- 2 The land has the benefit of the rights granted by but is subject to the rights reserved by a Conveyance of the land in this title and other land dated 24 March 1981 made between (1) The Special Trustees For St. Bartholomew's Hospital (2) John Strand (Holdings) Limited and (3) Antonis Evangelou.
NOTE: Original filed under NGL399740.
- 3 The Conveyance dated 24 March 1981 referred to above contains provisions as to light or air and boundary structures.

B: Proprietorship Register

This register specifies the class of title and identifies the owner. It contains any entries that affect the right of disposal.

Title absolute

- 1 (21.12.1983) PROPRIETOR: T + P HOLDINGS LIMITED (Co. Regn. No. 1717778) of 136 Kentish Town Road, London NW1 9QB and of Unit 2, 53 Hargrave Road, London N19 5SH.
- 2 (23.03.2009) RESTRICTION: No disposition of the registered estate by the proprietor of the registered estate is to be completed by registration without a certificate signed by a conveyancer that that conveyancer is satisfied that the document submitted for registration is executed by the disponor acting by Thomas Andrew and Philip Andrew.
- 3 (12.03.2020) The proprietor's address for service has been changed.

C: Charges Register

This register contains any charges and other matters that affect the land.

- 1 (06.08.2015) The parts of the land affected thereby are subject to the leases set out in the schedule of leases hereto.
The leases grant and reserve easements as therein mentioned.

Schedule of notices of leases

| Registration date and plan ref. | Property description | Date of lease and term | Lessee's title |
|---------------------------------|----------------------|------------------------|----------------|
|---------------------------------|----------------------|------------------------|----------------|

Title number NGL412707

| | | | | |
|---|------------|--|--|-----------|
| 1 | 06.08.2015 | Office Premises, 136-138 Kentish Town Road (Basement, Lower Ground, Ground and Mezzanine) | 09.07.2015 | NGL941107 |
| | | | From and including 2.7.2015 for a term of 20 years | |

End of register

| | | | |
|-----------------------------------|----------------|------------------------|---------------|
| H.M. LAND REGISTRY | | TITLE NUMBER | |
| | | NGL 412707 | |
| ORDNANCE SURVEY PLAN REFERENCE | COUNTY | SHEET | NATIONAL GRID |
| | GREATER LONDON | | TQ 2984 |
| | | | SECTION |
| | | | J |
| Scale: 1:1250 | | © Crown copyright 1974 | |

BOROUGH OF CAMDEN

Old Reference LN VII 2 K

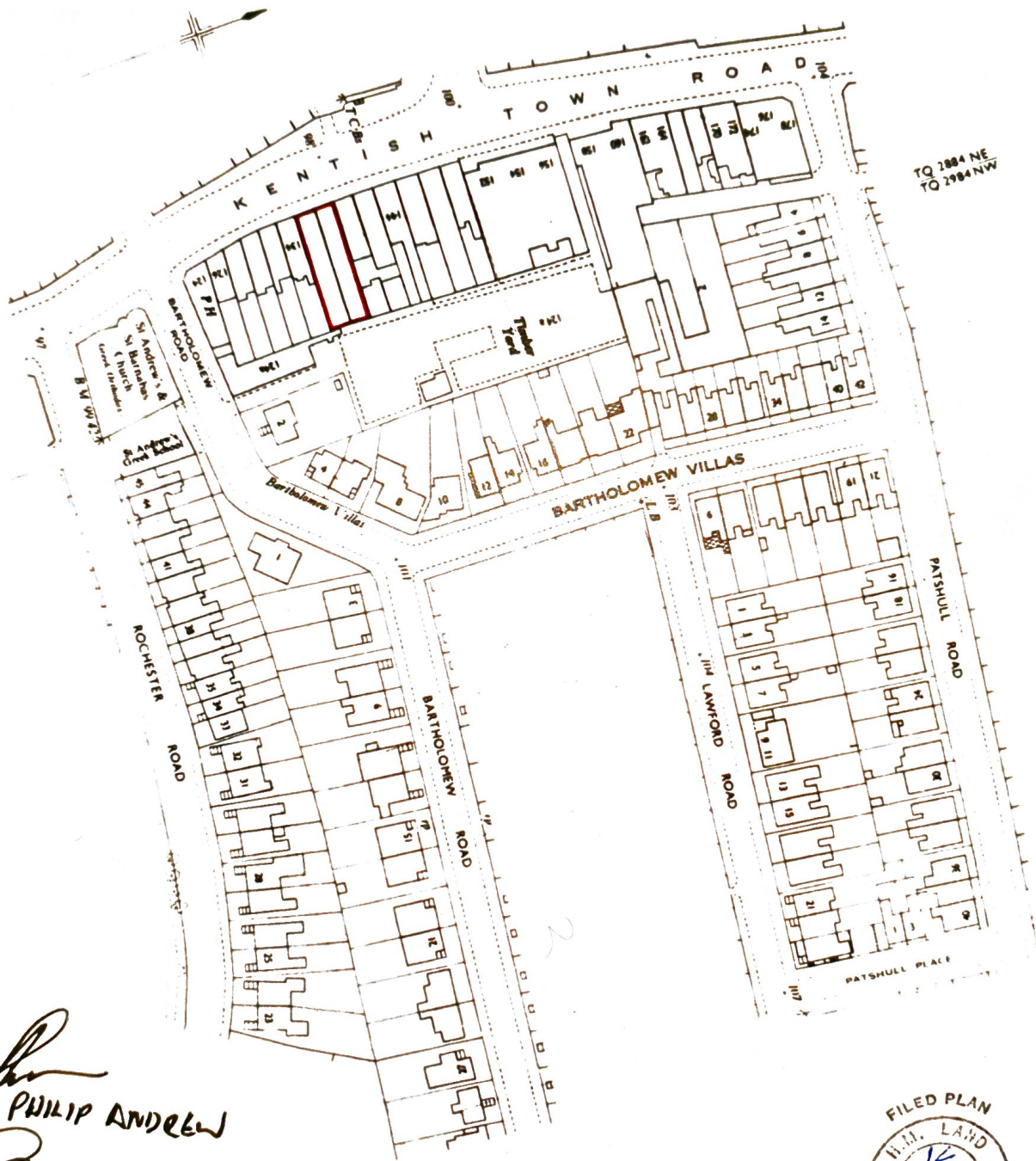

Philip Andrew
PHILIP ANDREW
Adminika Choudhury
Adminika Choudhury



This is a copy of the title plan on 13 OCT 2020 at 12:33:03. This copy does not take account of any application made after that time even if still pending in HM Land Registry when this copy was issued.

This copy is not an 'Official Copy' of the title plan. An official copy of the title plan is admissible in evidence in a court to the same extent as the original. A person is entitled to be indemnified by the registrar if he or she suffers loss by reason of a mistake in an official copy. If you want to obtain an official copy, the HM Land Registry web site explains how to do this.

HM Land Registry endeavours to maintain high quality and scale accuracy of title plan images. The quality and accuracy of any print will depend on your printer, your computer and its print settings. This title plan shows the general position, not the exact line, of the boundaries. It may be subject to distortions in scale. Measurements scaled from this plan may not match measurements between the same points on the ground.

This title is dealt with by HM Land Registry, Croydon Office.

© Crown Copyright. Produced by HM Land Registry. Further reproduction in whole or in part is prohibited without the prior written permission of Ordnance Survey. Licence Number 100026316.