

NOTES  
DO NOT SCALE FROM THIS DRAWING.  
CONTRACTOR TO CHECK ALL DIMENSIONS ON SITE.  
ANY DISCREPANCIES TO BE REPORTED TO THE ARCHITECT  
IMMEDIATELY.  
COPYRIGHT MICA ARCHITECTS LTD ©

Notes:  
Existing information is based on construction drawings for both the original refurbishment works and the subsequent retail fit out. A full survey of the space, including service routes and positions of physical features should be undertaken prior to construction. Please report any discrepancies to the Architect.  
Please note that furniture is not indicated on the drawings as it is assumed it will be removed by the outgoing retailer.

- Key
- Unit R05 area
  - Shared Plant room (second floor level)
  - Existing building (refurbishment works)
  - Existing building (retail fit-out works)
  - Proposed demolition / removal indicated in orange throughout
  - Blue indicates proposed works throughout

REVISIONS	REV	DATE	DESCRIPTION
PL2	19.10.20	PLANNING UPDATE	
PL1	04.09.20	ISSUED FOR PLANNING	
P2	02.09.20	PRELIMINARY ISSUE	
P1	26.08.20	PRELIMINARY ISSUE	

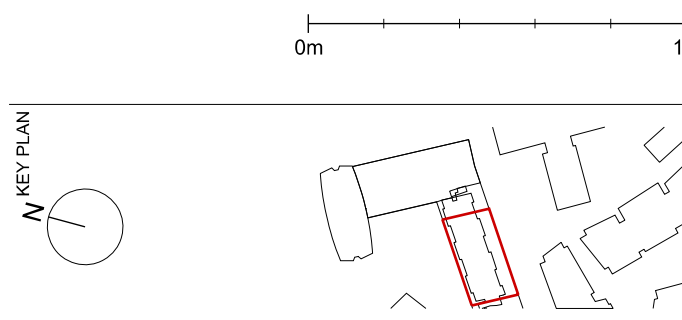

STATUS  
PLANNING

**MICA**  
123 Camden High Street London NW1 7JR  
T: 020 7284 1727 F: 020 7267 7626  
info@micaarchitects.com www.micaarchitects.com

JOB  
**Centre Point**  
Unit R05  
12 & 12A St Giles Square

TITLE  
**Demolition**  
Planning / Listed Building Consent  
First and First Mezzanine Floors

DRG # **709-MICA-CH-ZZ-DR-A-19111** REV **PL2**

CHECKED	JK	DRAWN	DL	SCALE	1:100	SIZE	A1	REV DATE	19.10.20
---------	----	-------	----	-------	-------	------	----	----------	----------