

SECOND FLOOR PLAN

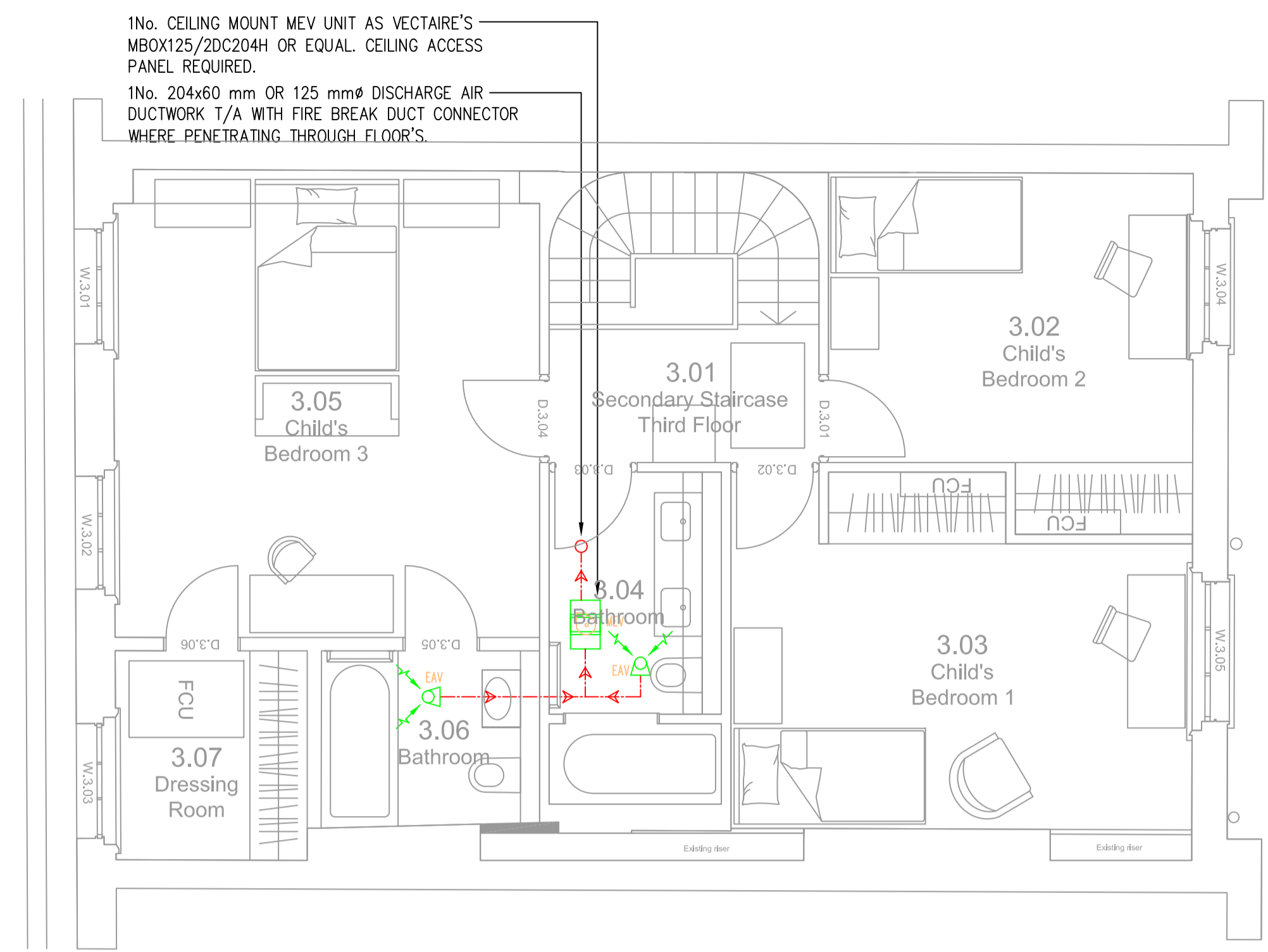

THIRD FLOOR PLAN

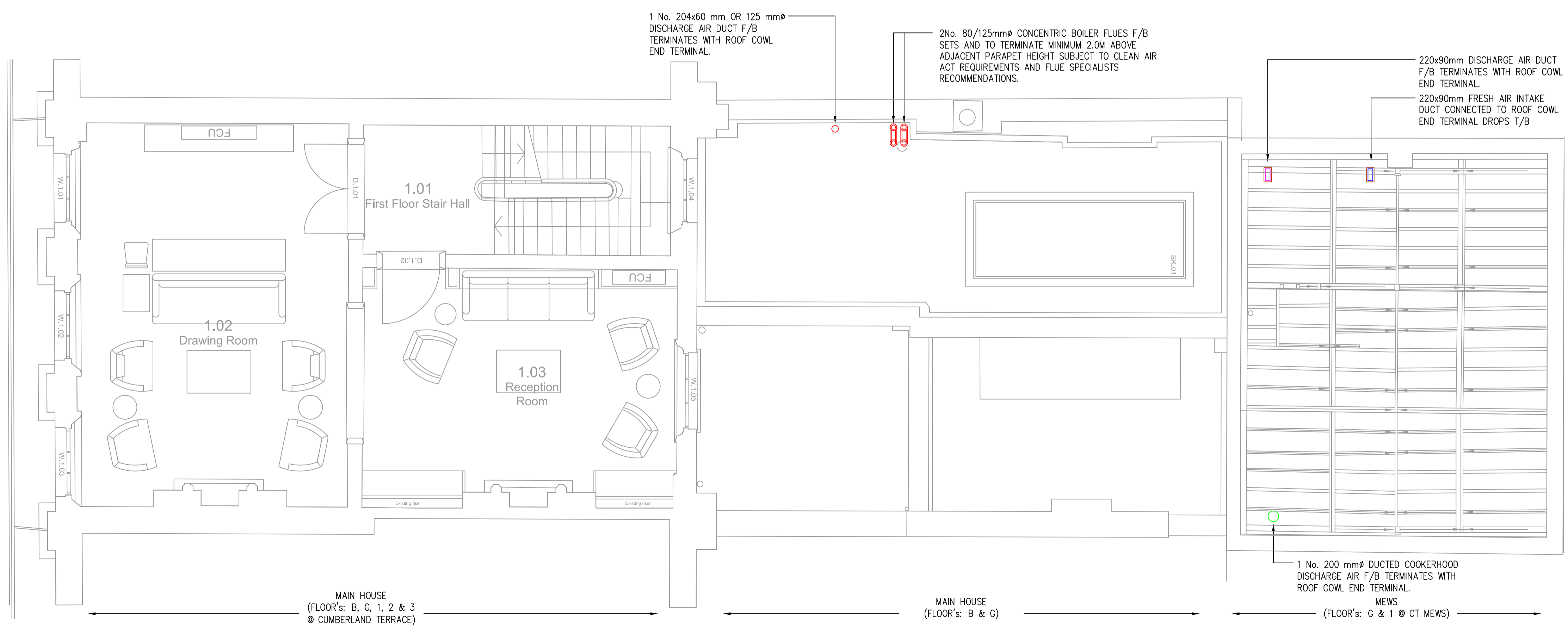

FIRST FLOOR PLAN

LEGEND

- CENTRAL MEV UNIT - SYSTEM 3 VENTILATION
- CENTRAL MVHR UNIT - SYSTEM 4 VENTILATION
NOTE: LOWER GROUND FLOOR ONLY
- EXTRACT AIR VALVE
- FRESH AIR SUPPLY VALVE
- RECTANGULAR VENTILATION DUCTWORK
- DUCTED COOKERHOOD
- MVHR/MEV UNIT BOOST SWITCH
- FIRE BREAK

NOTES

- FOR EXACT FLOOR FINISHES REFER TO INTERIOR DESIGNER/ARCHITECTS DRAWINGS.
- FINAL LOCATIONS OF AIR VALVES TO BE AGREED WITH ARCHITECT.
- FINAL LOCATION OF MVHR & MEV BOOST SWITCHES TO BE AGREED WITH ARCHITECT.
- FIRE BREAK 2 HR AS SUPPLIED BY DOMUS OR EQUAL & APPROVED TO BE PROVIDED WHERE PASSING THROUGH FIRE RATED WALLS & FLOORS.
- VENTILATION DUCTWORK SHALL BE INSTALLED WITH FIRE BREAK DUCT CONNECTOR WHERE PENETRATING THROUGH FLOORS & ROOF.

BWIC NOTE

USE OF EXISTING NOTCHES AND JOISTS TO BE USED WHERE PRACTICAL. ANY NEW NOTCH AND HOLES WILL BE CARRIED OUT IN ACCORDANCE TO LISTED BUILDING REGULATIONS AND STRUCTURAL ENGINEER'S DETAILS

DESIGN NOTE

DRAWING ISSUE FOR DESIGN INTENT DEVELOPMENT. FINAL LOCATION OF AIR VALVES VENTILATION END POSITIONS, IN PARTICULAR ILLUSTRATED AT THE EXTERNAL FACADES AND ROOF TO BE AGREED WITH PROJECT DESIGN TEAM AND SUBJECT TO PLANNING.

Note
ALL DIMENSIONS TO BE VERIFIED ON SITE BEFORE SETTING OUT OR MAKING ANY SHOP DRAWINGS. THIS DRAWING IS TO BE READ IN CONJUNCTION WITH THE CONSULTANT ENGINEER'S SPECIFICATION.

Orientation

ref./date	REVISIONS
P 15.09.20	PLANNING ISSUE
P1 24.09.20	PLANNING ISSUE
P2 09.11.20	PLANNING ISSUE AMENDED TO SUIT LATEST GA's

FOR PLANNING

KUT LLP
First Floor
2E Berol House
25 Ashley Road
London
N17 9LJ
Tel: +44(0)20 8348 5171
Fax: +44(0)20 8340 8926
Email: tkp@kut.co.uk
Web: www.kut.co.uk

FIRST, SECOND & THIRD FLOOR MECHANICAL SERVICES VENTILATION

Project
55 CUMBERLAND TERRACE
CAMDEN, LONDON
NW1 4HJ

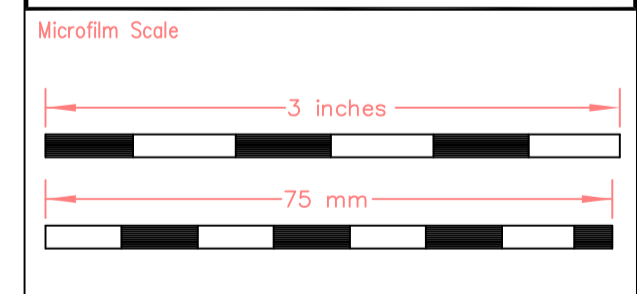

Architect
COLLETT-ZARZYCKI Ltd
Fernhead Studios, 2B
Fernhead Road, London W9 3ET
Tel: +44(0)20 8969 6967
email: mail@czltd.co.uk

xref 55CT - GA - (20-11-06)
Scale A1@1:50 **Drawn** SAS
Date Sep 2020 **Checked**

Issue PRELIMINARY

Project No.	Services	Dwg No.	Rev.
6618	M	113	P2

1st, 2nd & 3rd