

SECOND FLOOR PLAN

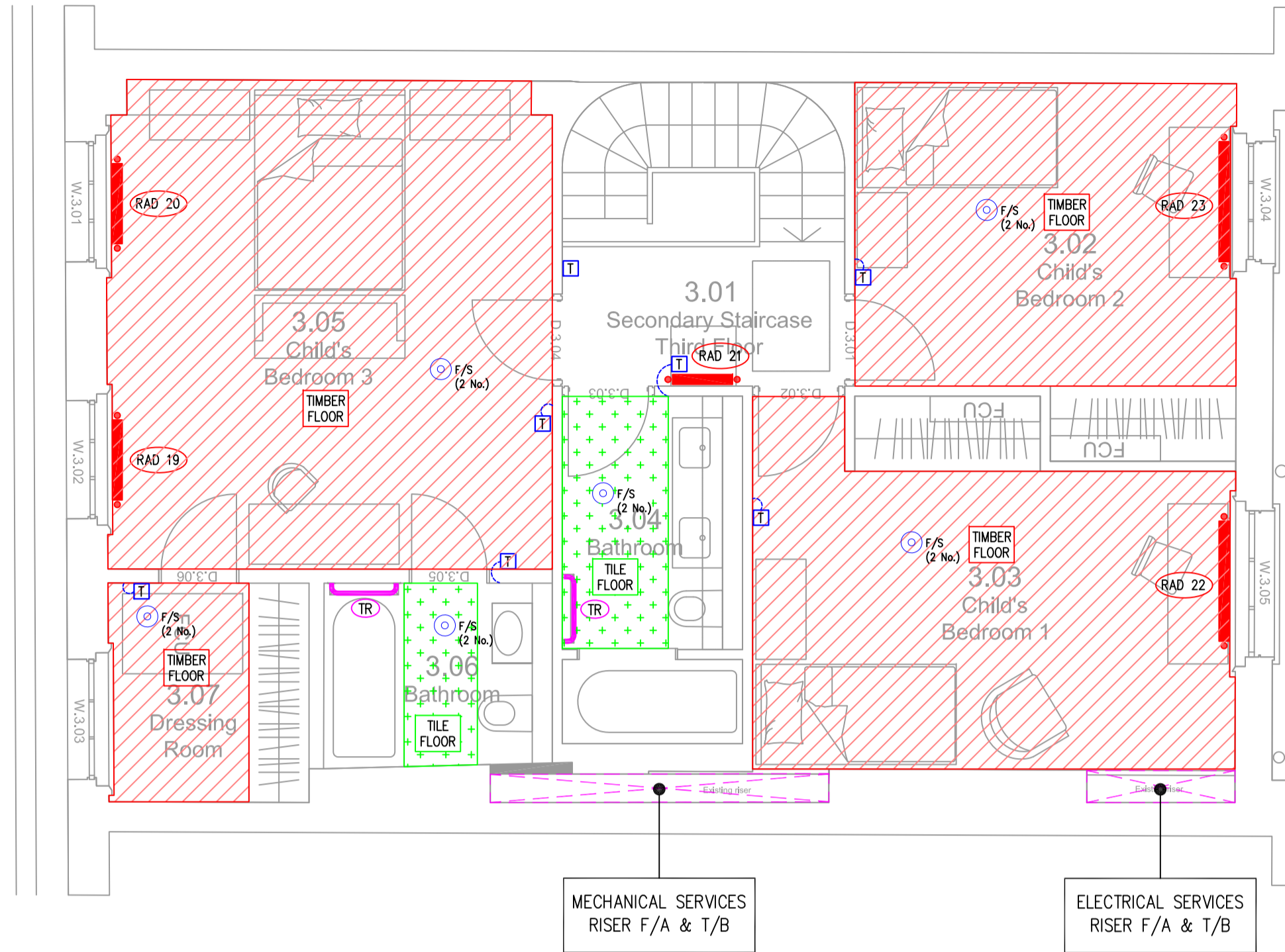

THIRD FLOOR PLAN

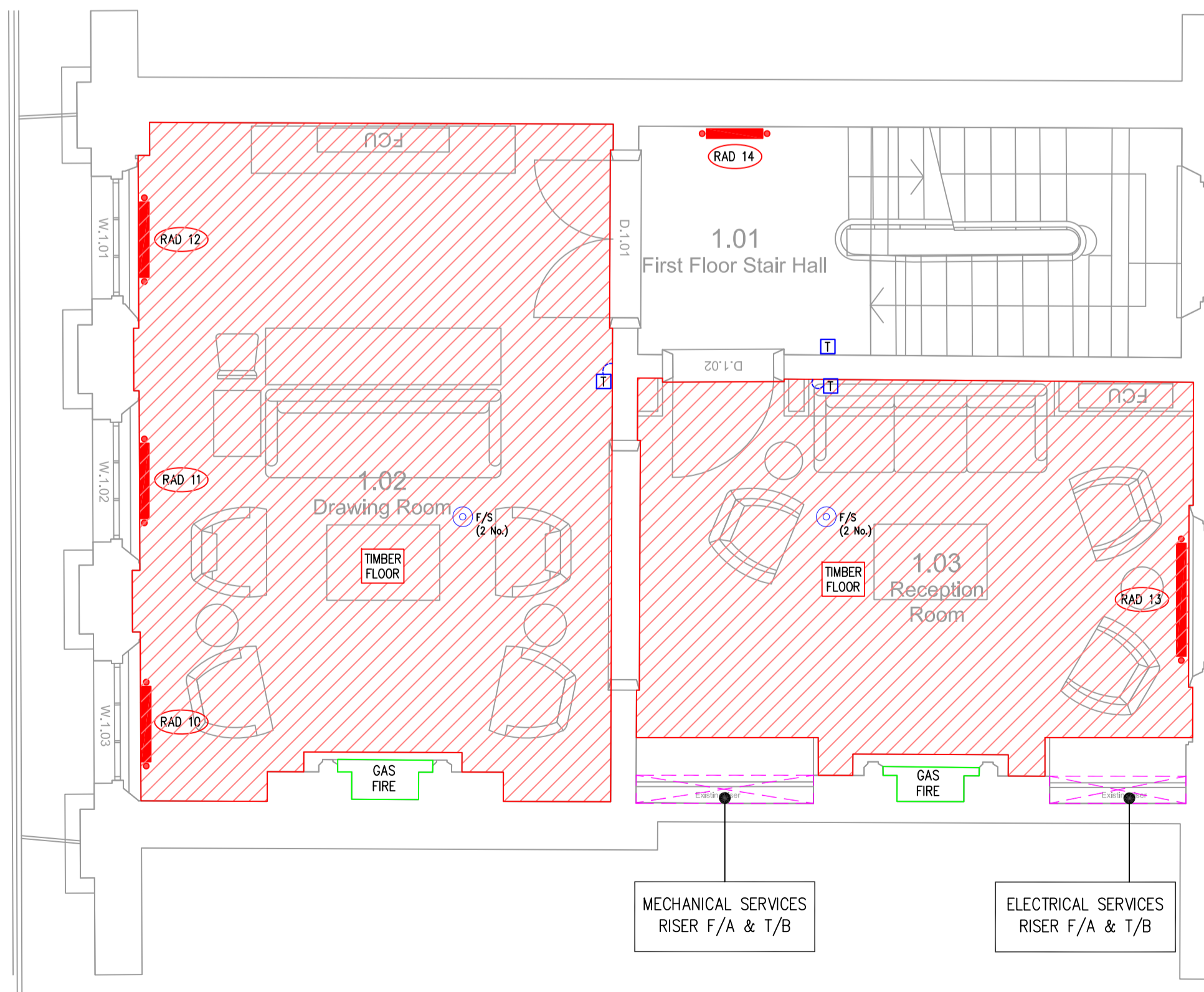

FIRST FLOOR PLAN

LEGEND

- NEW UP/HW UNDERFLOOR HEATING (WET SYSTEM) FOR WOOD/ CARPET/ TILE FLOORING WITHIN NEW CONCRETE SLAB WITH SCREED CONSTRUCTION IN GROUND FLOOR AND JOISTS ABOVE. SHALL BE AS SUPPLIED BY SPECIALIST UNDERFLOOR HEATING NOW (TEL: 07720 677 622 CONTACT GLYN DEWEY) OR EQUAL AND APPROVED
- NEW ELECTRIC UNDERFLOOR TILE HEATING IN WET AREAS I.E. BATHROOMS (CABLE MAT SYSTEM EMBEDDED IN TILE BEDDING). SHALL BE AS SUPPLIED BY SPECIALIST UNDERFLOOR HEATING NOW (TEL: 07720 677 622 CONTACT GLYN DEWEY) OR EQUAL AND APPROVED
- FLOOR FINISH. FOR EXACT FLOOR FINISHES REFER TO INTERIOR DESIGNER/ARCHITECTS DRAWINGS, SPECIFICATIONS AND FINISHES SCHEDULES.
- UP/HW UNDERFLOOR HEATING MANIFOLD, WHERE CONCEALED ACCESS TO BE PROVIDED TO ARCHITECTS/INTERIOR DESIGNERS DETAILS
- ROOM THERMOSTAT - TO CONTROL UNDERFLOOR HEATING. MAIN ROOM TO BE CONTROLLED WITH A ROOM SENSOR AND FLOOR SENSOR.
ROOM THERMOSTAT TYPICALLY AT 1200mm ABOVE FINISHED FLOOR LEVEL
- PROGRAMMABLE ROOM THERMOSTAT EXACT POSITION TO BE AGREED WITH THE ARCHITECT/INTERIOR DESIGNER
- WATER TOWEL RAIL. FOR MODEL OF TOWEL RAIL REFER TO SANITARYWARE SCHEDULE. INCLUDE FOR FITTING. 250 WATTS INDICATE MINIMUM HEAT OUTPUT TO BE PROVIDED.
- RADIATOR WITH THERMOSTATIC CONTROL
- FLOOR TEMPERATURE FOR HIGH LIMIT FLOOR TEMPERATURE CONTROL AND SUMMER FLOOR WARMING. TWO SENSORS TO BE INSTALLED TO UP/HW MANUFACTURERS REQUIREMENTS, No SPARE FOR FUTURE.

NOTES

1. FOR EXACT FLOOR FINISHES REFER TO INTERIOR DESIGNER/ARCHITECTS DRAWINGS.
 2. ALL THERMOSTAT LOCATIONS TO BE AGREED WITH ARCHITECT.
 3. WHERE RADIATORS ARE CONCEALED BEHIND JOINERY, VENTILATION SLOTS AT THE TOP & BOTTOM OF RADIATOR POSITIONS ARE REQUIRED TO ALLOW FOR THE AIR FLOW AND SLOTS MUST BE THE LENGTH OF THE RADIATOR.
 4. ALL RADIATORS SHALL BE COMPLETE WITH AIR VENT, OPPOSITE END CONNECTIONS AND MOUNTING BRACKETS. WALL MOUNTING BRACKETS SHALL BE PROVIDED AT CENTRE'S, AS RECOMMENDED BY THE MANUFACTURER. BOILER F&R TEMPERATURE 80/60 DEG C. THE RADIATORS SHALL BE DELIVERED WITHIN A PROTECTIVE CARTON. IF ANY DAMAGE OCCURS TO THE RADIATORS THEY SHALL BE REPAIRED OR REPLACED AS APPROPRIATE AT NO EXTRA COST.
- THE CONTRACTOR SHALL CHECK ALL RELEVANT DIMENSIONS BEFORE ORDERING THE RADIATORS TO ENSURE THAT THE SIZE AS SPECIFIED CAN BE ACCOMMODATED IN THE SPACE AVAILABLE. THE MOUNTING HEIGHT OF THE RADIATORS SHALL BE AGREED PRIOR TO THE RADIATOR BEING FIXED. CONTRACTOR SHALL ALSO CHECK THAT RADIATORS ON STUD WALL CAN TAKE THE WEIGHT, IF NECESSARY ADVISE THE BUILDER ADDITIONAL STRENGTHENING IS REQUIRED TO WALL.
- THE CONTRACTOR SHALL INCLUDE FOR REMOVING RADIATORS ONCE AFTER FITTING FOR PAINTING AND REDECORATING AND FOR THEIR REINSTATEMENT.
- RADIATORS TO BE APPROVED AND INCLUDE RAL COLOUR FINISHED TO ARCHITECT/ INTERIOR DESIGNERS REQUIREMENTS.

BWIC NOTE

USE OF EXISTING NOTCHES AND JOISTS TO BE USED WHERE PRACTICAL. ANY NEW NOTCH AND HOLES WILL BE CARRIED OUT IN ACCORDANCE TO LISTED BUILDING REGULATIONS AND STRUCTURAL ENGINEER'S DETAILS

DESIGN NOTE

1. DRAWING ISSUE FOR DESIGN INTENT DEVELOPMENT. FINAL RADIATOR POSITIONS, IN PARTICULAR ILLUSTRATED AT THE WINDOWS TO BE AGREED WITH ARCHITECT DUE TO LOW WINDOW SILL HEIGHTS.
2. LOWER GROUND HEATING SHALL BE IN SCREED OR OVERBOARD UFH SYSTEM AS MANUFACTURED BY OMNIE FLOOR.
3. GROUND TO THIRD FLOOR HEATING SHALL BE PRIMARILY BY UFH SYSTEM LIKELY BATTENED SYSTEM WITH PIPES RUN BETWEEN JOISTS USING EXISTING/NEW NOTCHES.
4. RADIATORS ARE ALSO INDICATED TO SUPPLEMENT AND PROVIDE BACK UP TO THE UFH SYSTEM.

Note
ALL DIMENSIONS TO BE VERIFIED ON SITE BEFORE SETTING OUT OR MAKING ANY SHOP DRAWINGS. THIS DRAWING IS TO BE READ IN CONJUNCTION WITH THE CONSULTANT ENGINEER'S SPECIFICATION.

Orientation

ref./date	REVISIONS
P 15.09.20	PLANNING ISSUE
P1 24.09.20	PLANNING ISSUE
P2 09.11.20	PLANNING ISSUE AMENDED TO SUIT LATEST GA'S

FOR PLANNING

KUT LLP
First Floor
2E Berol House
25 Ashley Road
London
N17 9LJ
Tel: +44(0)20 8348 5171
fax: +44(0)20 8340 8926
email: tkp@kut.co.uk
web: www.kut.co.uk

FIRST, SECOND & THIRD FLOOR MECHANICAL SERVICES HEATING

Project
55 CUMBERLAND TERRACE
CAMDEN, LONDON
NW1 4HJ

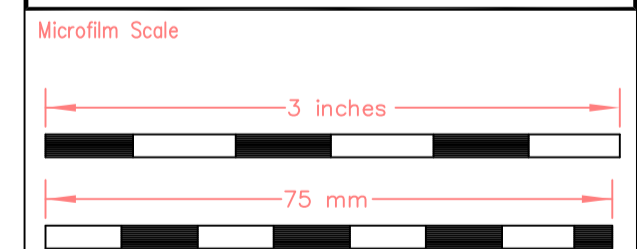

Architect
COLLETT-ZARZYCKI Ltd
Fernhead Studios, 2B
Fernhead Road, London W9 3ET
Tel: +44(0)20 8969 6967
email: mail@czltd.co.uk

xref
Scale A1@1:50
Date Sep 2020
Issue PRELIMINARY

Project No.	Services	Dwg No.	Rev.
6618	M	110	P2

1st, 2nd & 3rd