

01 General Arrangement - Proposed Plan  
1:200 @ A1

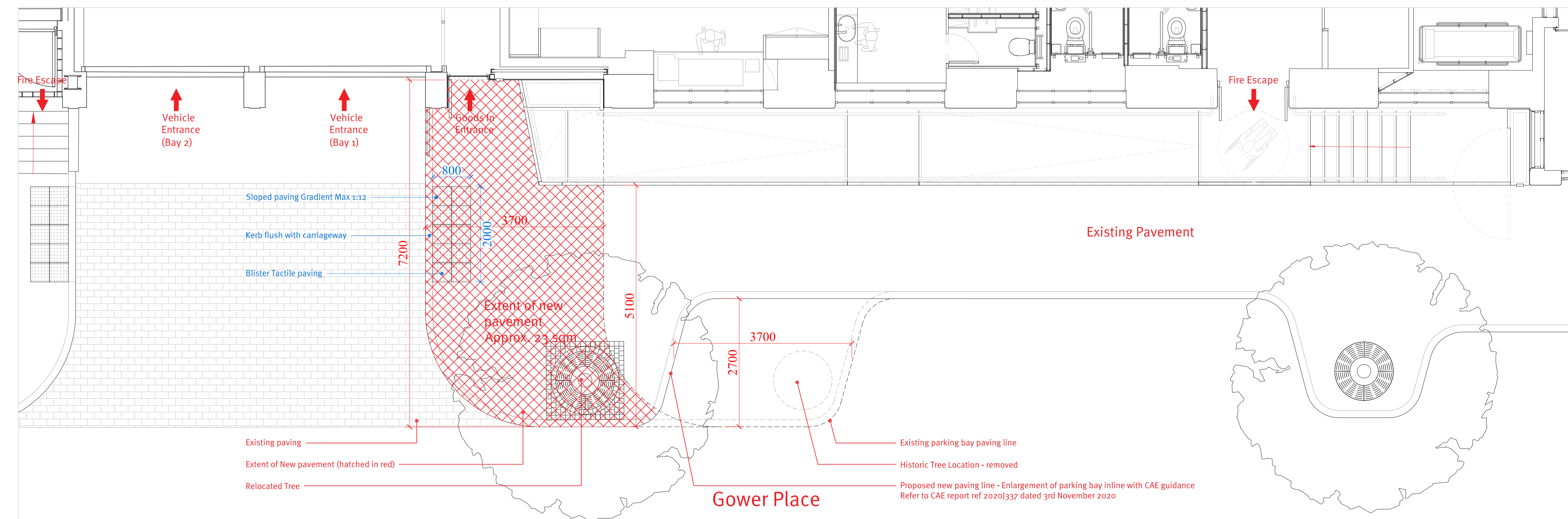

02 Proposed Detail Plan  
1:50 @ A1



Proposed

KEY

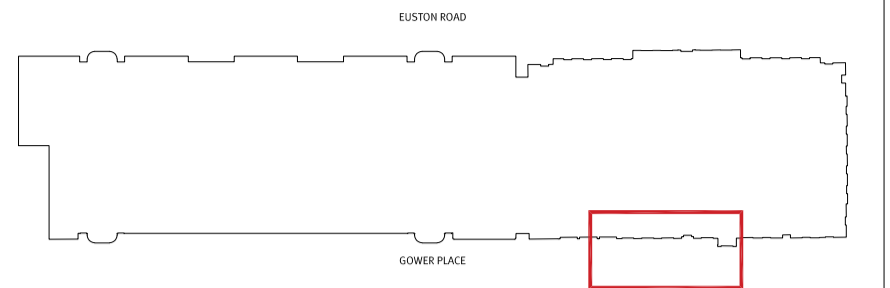

DISCLAIMER:  
This drawings is based on CAD drawings from a third party, as such 3|10 Studio cannot guarantee its accuracy.  
Do not scale dimensions off drawings. Use written or calculated dimensions. The contractor is responsible for checking dimensions before ordering or starting work.  
This document contains confidential and proprietary information that cannot be reproduced or divulged, in whole or in part, without written authorisation from 3|10 studio ltd.  
DRAWINGS NOT FOR CONSTRUCTION PURPOSES



Streetview of existing loading bay entrance

REV	DATE	COMMENT
P	13.11.2020	Planning Application Issue Additional Information as requested by Camden Council

STATUS: Planning Application Submission

DATE:	DRAWING TITLE:	SCALE:
10.10.2020	General Arrangement Proposed plan Extent of New Paving	Varies

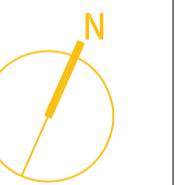

PROJECT NAME:	DRAWING NUMBER	REVISION
Wellcome Collection 183 Euston Road Gower Place Accessible Ramp	Lo67_A_G200_P_01	P

CLIENT:  
The Wellcome Trust  
215 Euston Road  
London  
NW1 2BE



3|10 studio  
architecture

Brightbow Workspace  
62 Bedminster Parade  
Bristol  
BS3 4HL

TEL 0117 223 0078  
info@310studio.co.uk  
www.310studio.co.uk

